



 ETOILE

**E.WALL**

---

**E.Wall** is a **system of movable internal walls** with a supporting **aluminium** structure, featuring an English-style **grid framework**.



**E.WALL**  
glazed module

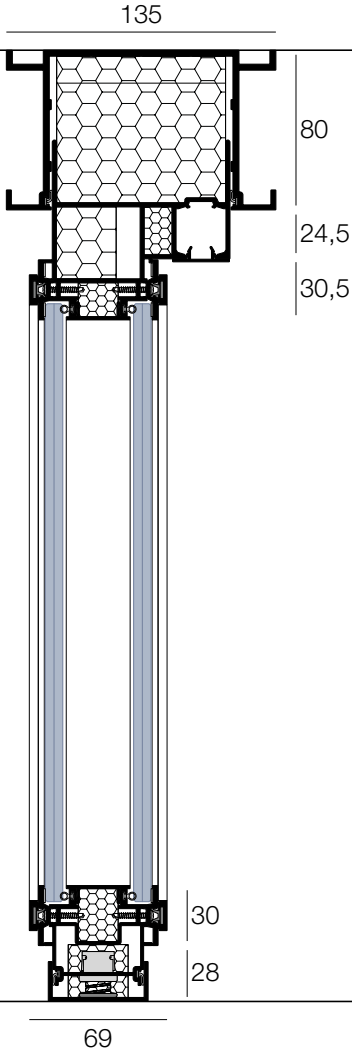

**E.WALL**  
solid wood module

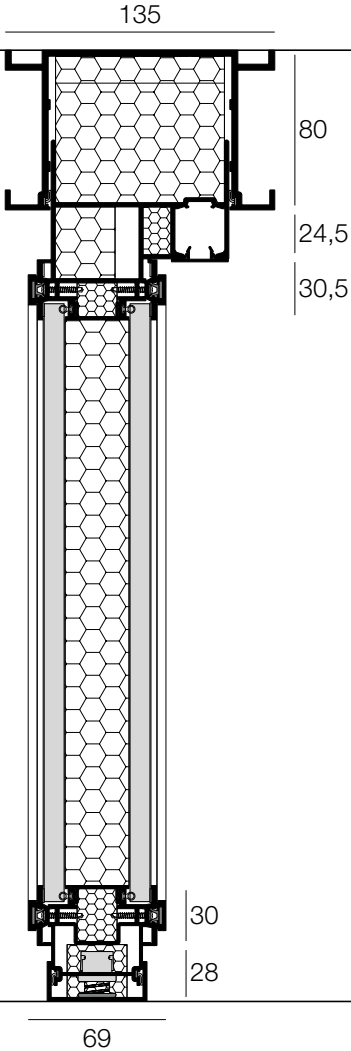

**E.WALL**  
mixed solid and glass module

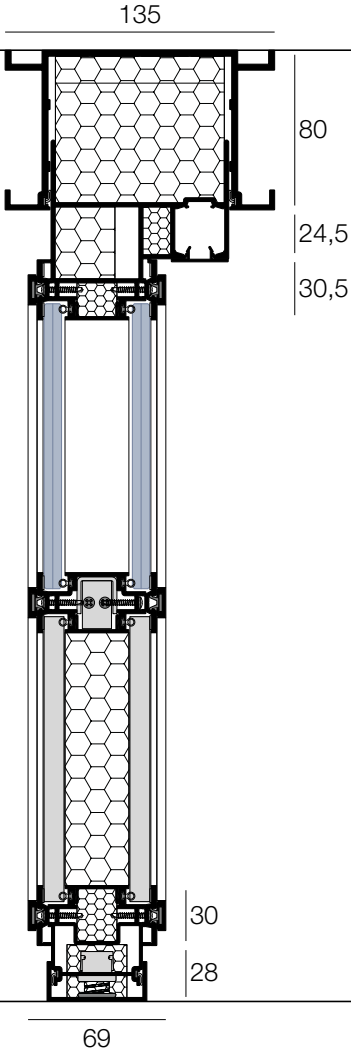













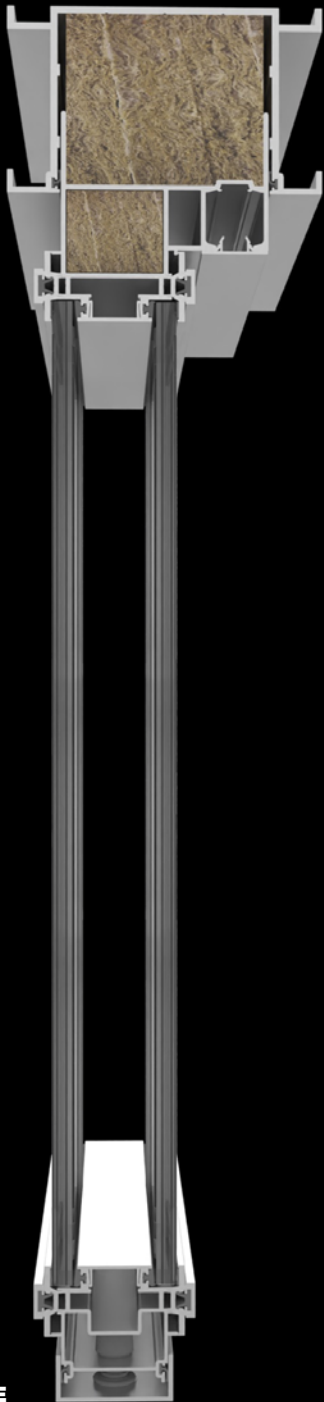

GLAZED MODULE



SOLID WOOD MODULE

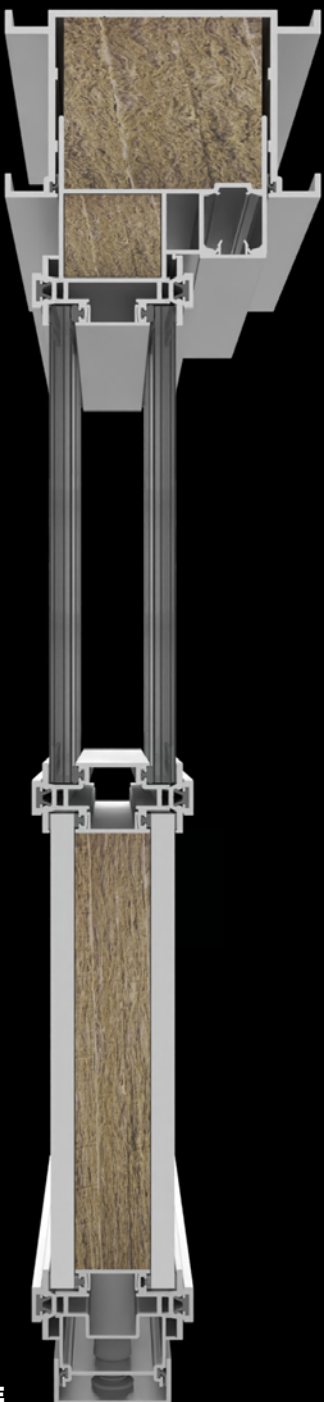

MIXED SOLID AND GLASS MODULE

## Plus and Acoustic performance



- 01.** Thickness: 69 mm
- 02.** Aluminium supporting structure
- 03.** Partition panels mounted vertically or horizontally
- 04.** Panels with width 500/1000/1500 mm
- 05.** Double glass wall - 44.2a/55.2a laminated glass
- 06.** Solid wall in melamine-finished panels
- 07.** Aluminium top beam with a  $\pm 25$  mm adjustment function
- 08.** Fixed corner profile - 2-, 3- or 4-way junctions
- 09.** Utility module
- 10.** 4 versions of hinged doors - solid, tempered glass and framed
- 11.** 1 version of framed external sliding door

- 01.** Double 44.2a laminated glass - **45 dB**
- 02.** Solid/Glass 44.2a - **42 dB**
- 03.** Double 55.2a laminated glass - **46 dB**



Wall-end upright

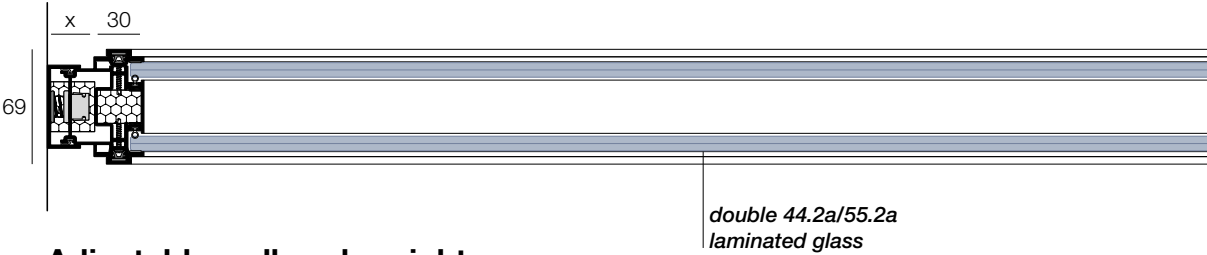
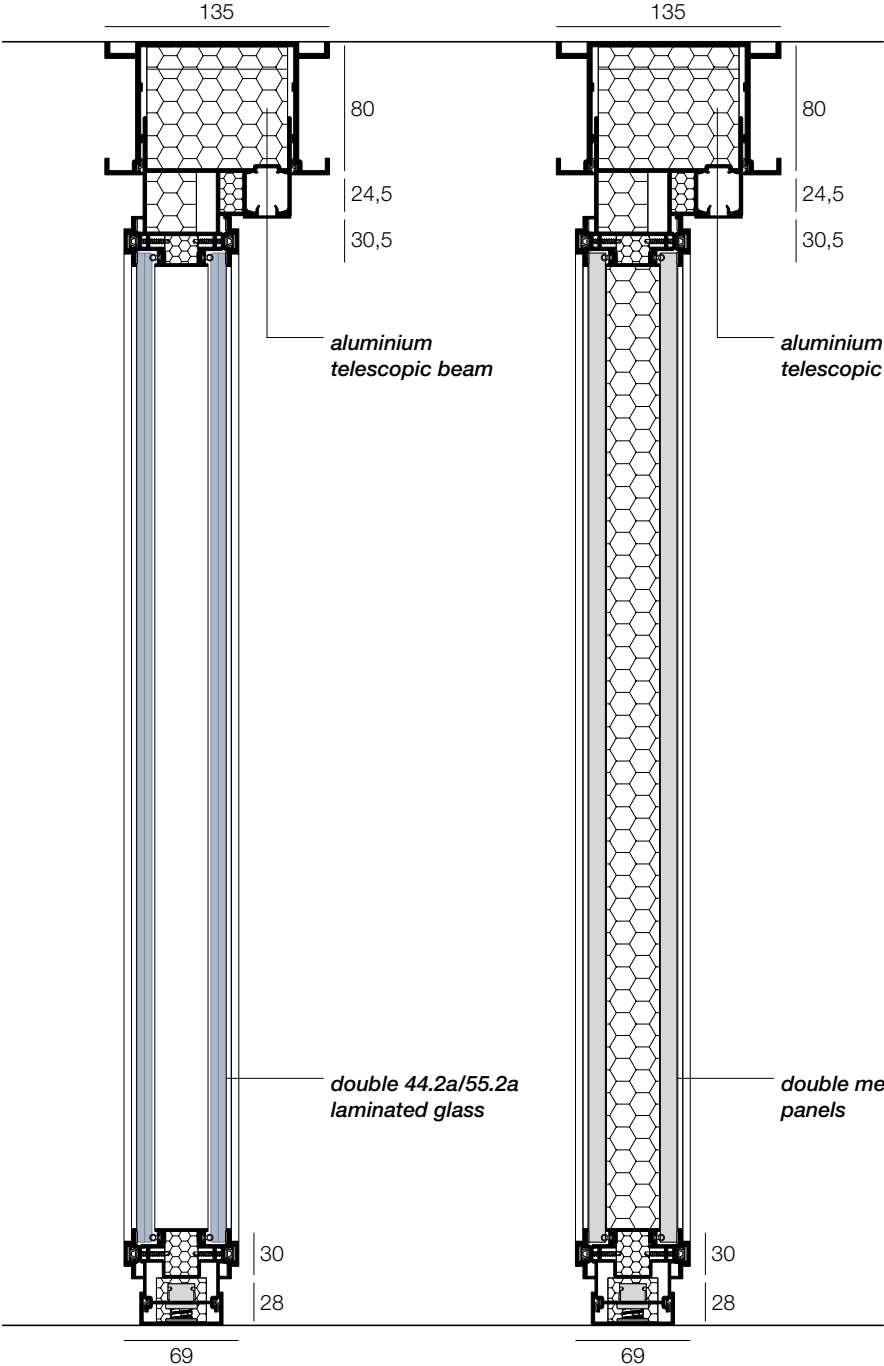

Adjustable wall-end upright

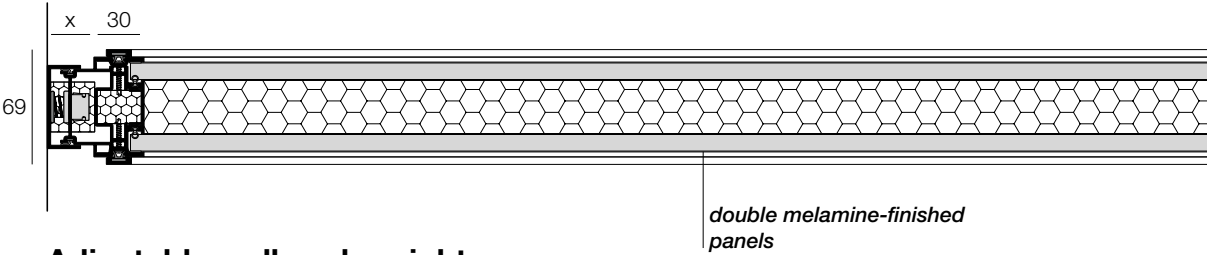

Adjustable wall-end upright

Wall-end upright



End profile

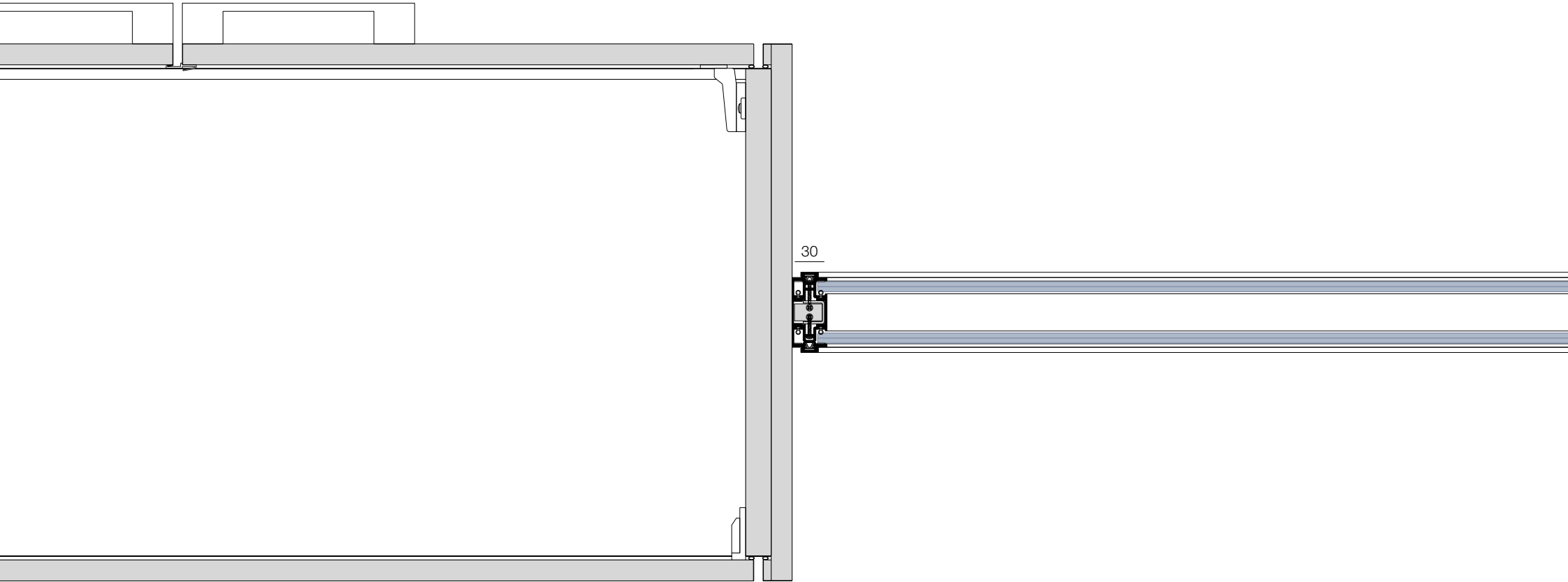

Storage-end upright

# Junction profiles

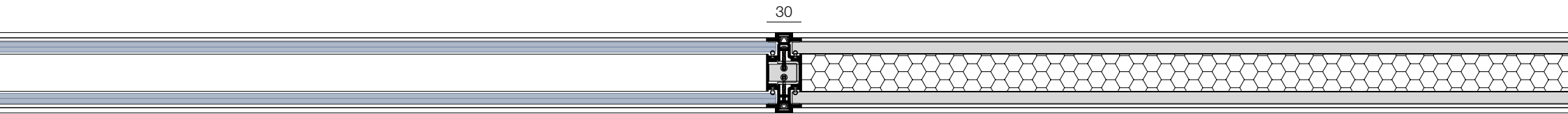

**Junction  
with intermediate upright**

## Junction profiles

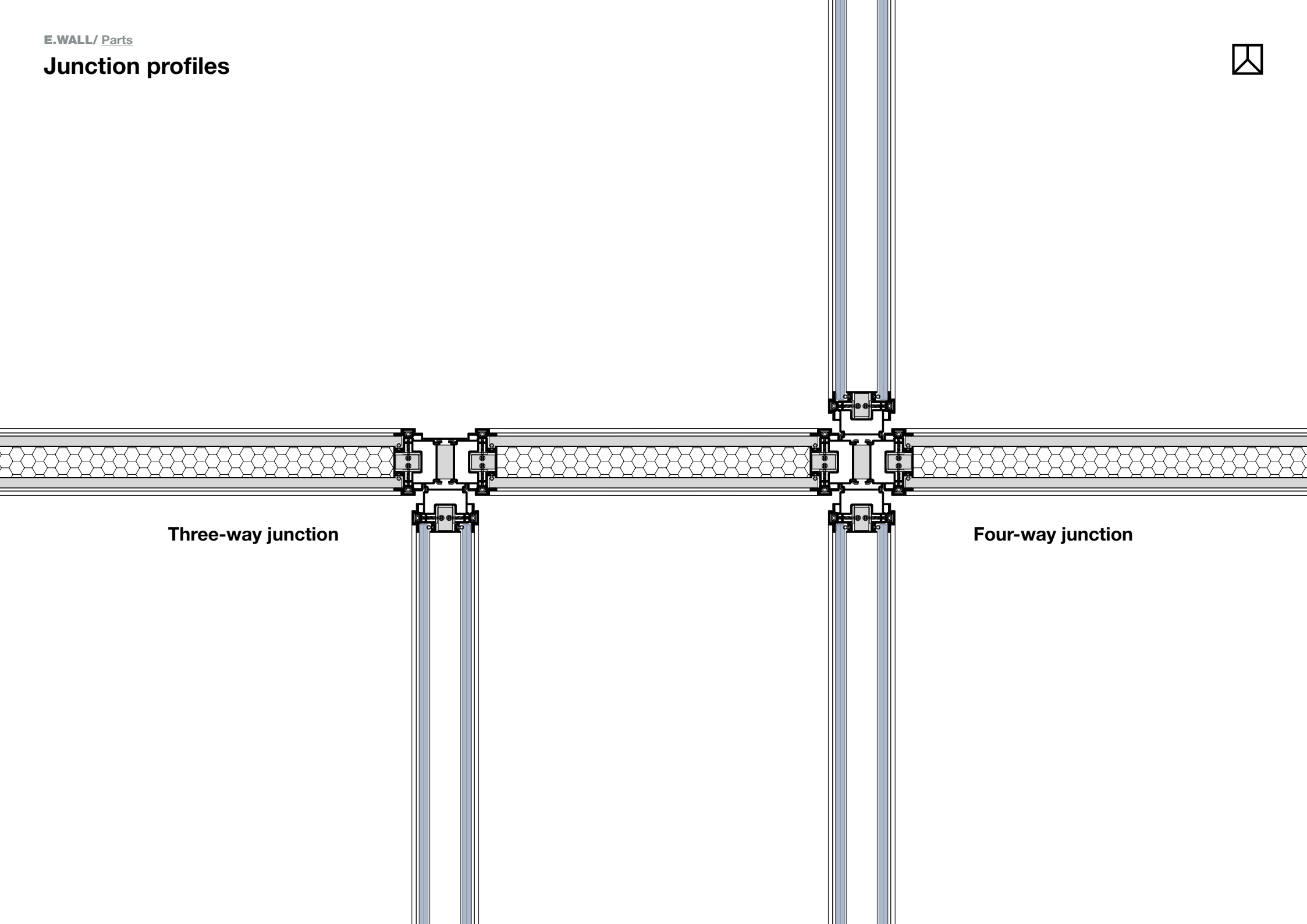

Three-way junction

Four-way junction

Corner profile

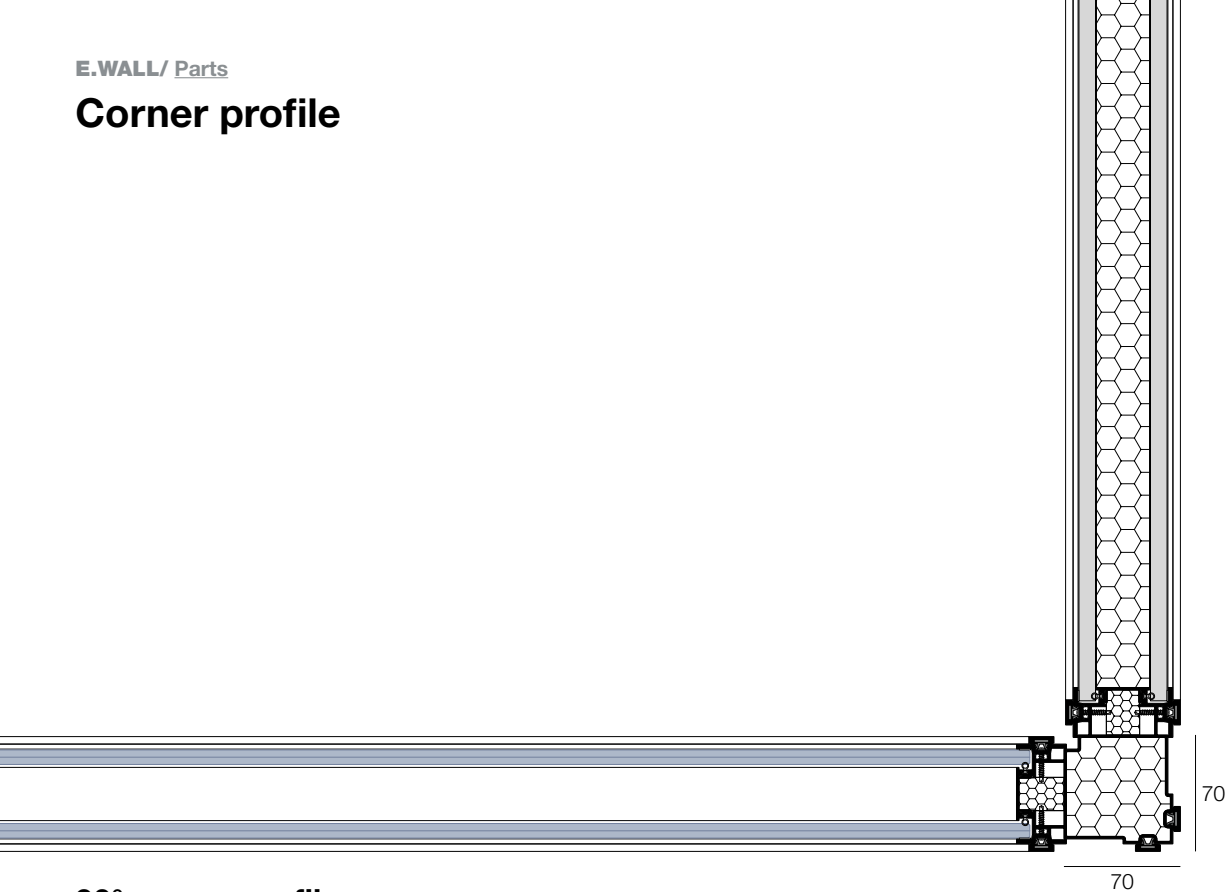

90° corner profile



Utility module  
for hinged doors



Utility module

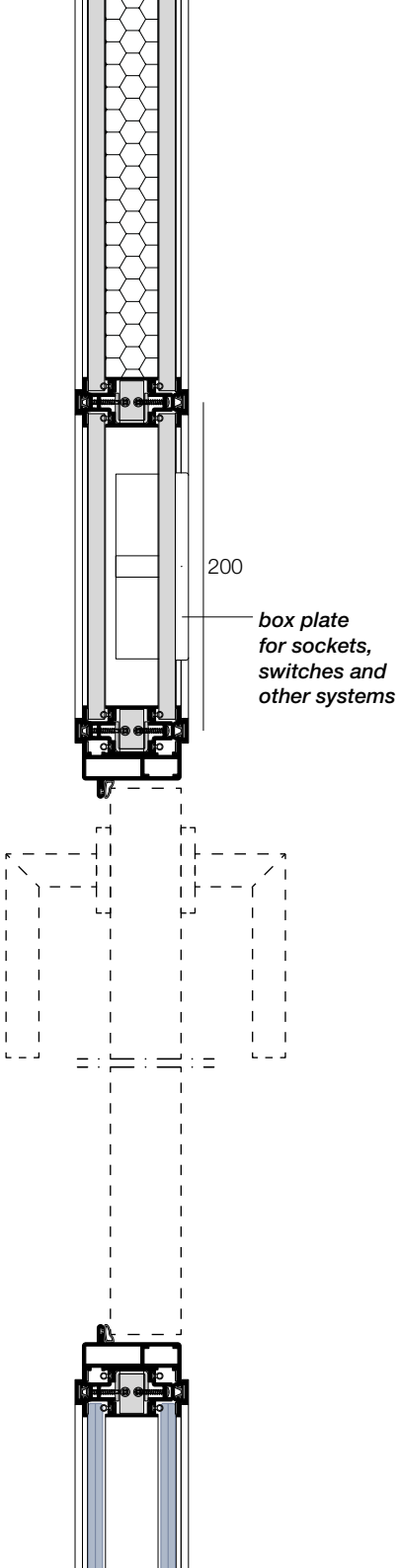

*\*possible positions for switches and sockets on the utility module*

Utility module  
for sliding doors



Utility module

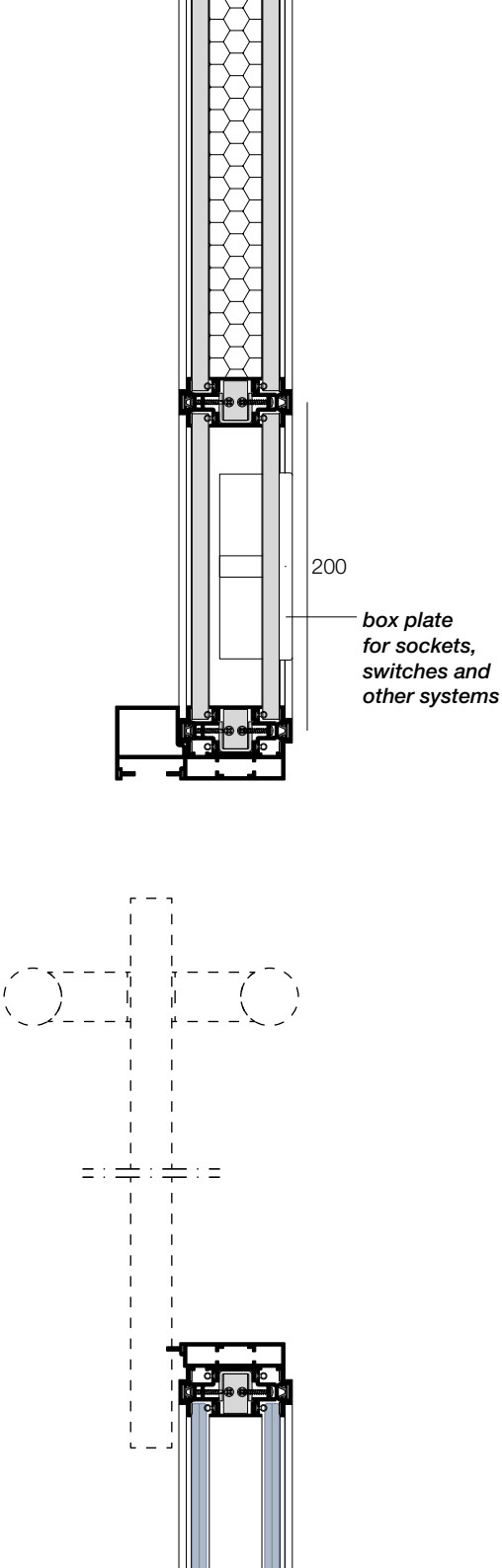

\*possible positions for switches and sockets on the utility module

**E.WALL**

Doors and handles

## MEDIUM FRAMED DOOR LEAF 43 mm thick

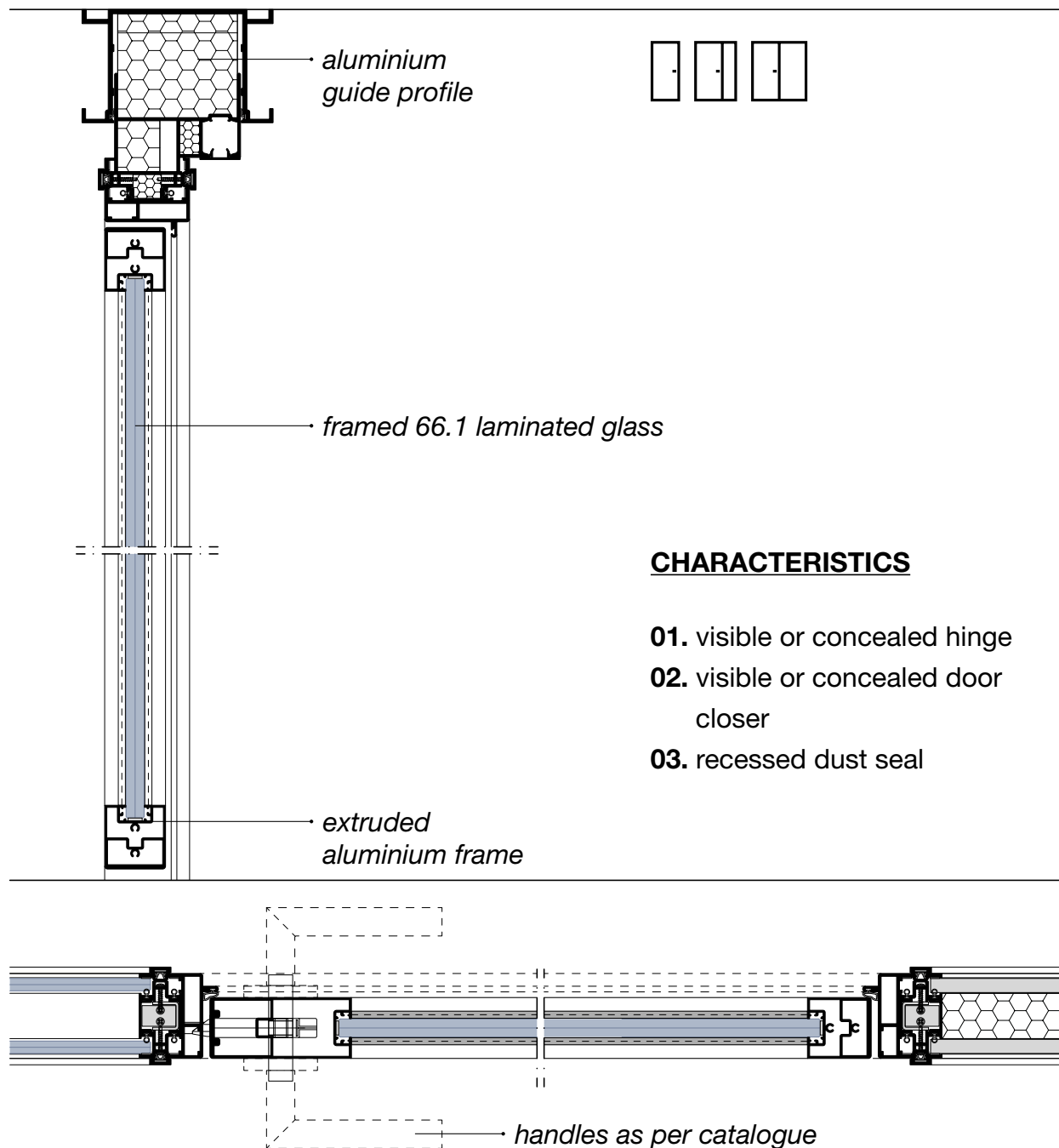

MEDIUM FRAMED DOOR LEAF 43 mm thick

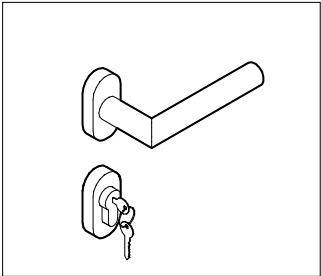

ML5

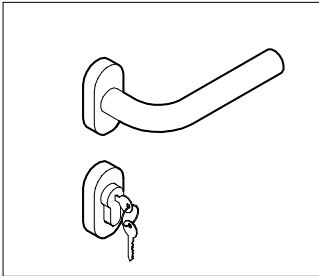

ML6

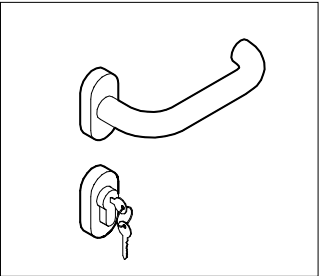

ML7

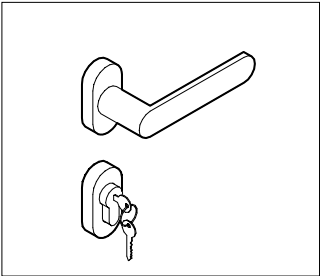

ML8

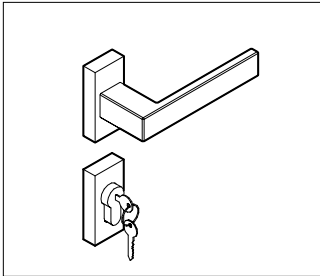

ML9

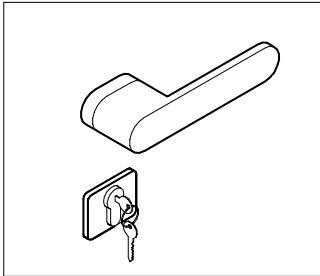

ML10

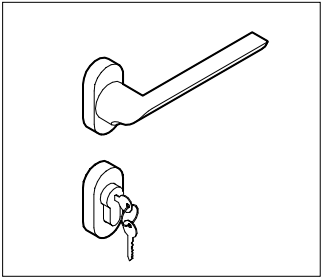

ML11

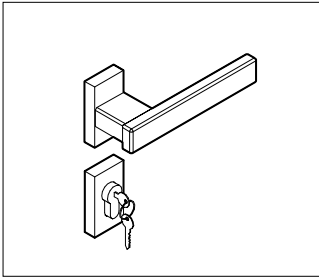

MLQ

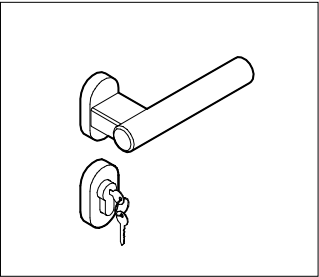

MLT

WOOD

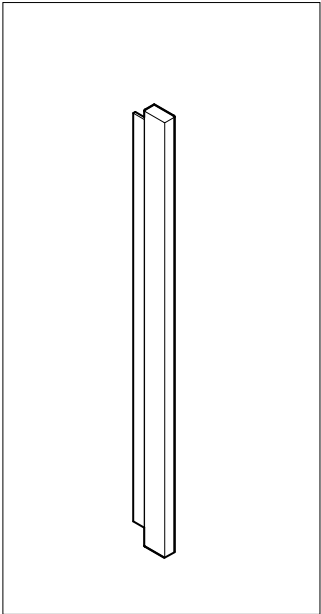

MPOMLFSB



## SOLID DOOR LEAF 43 mm thick

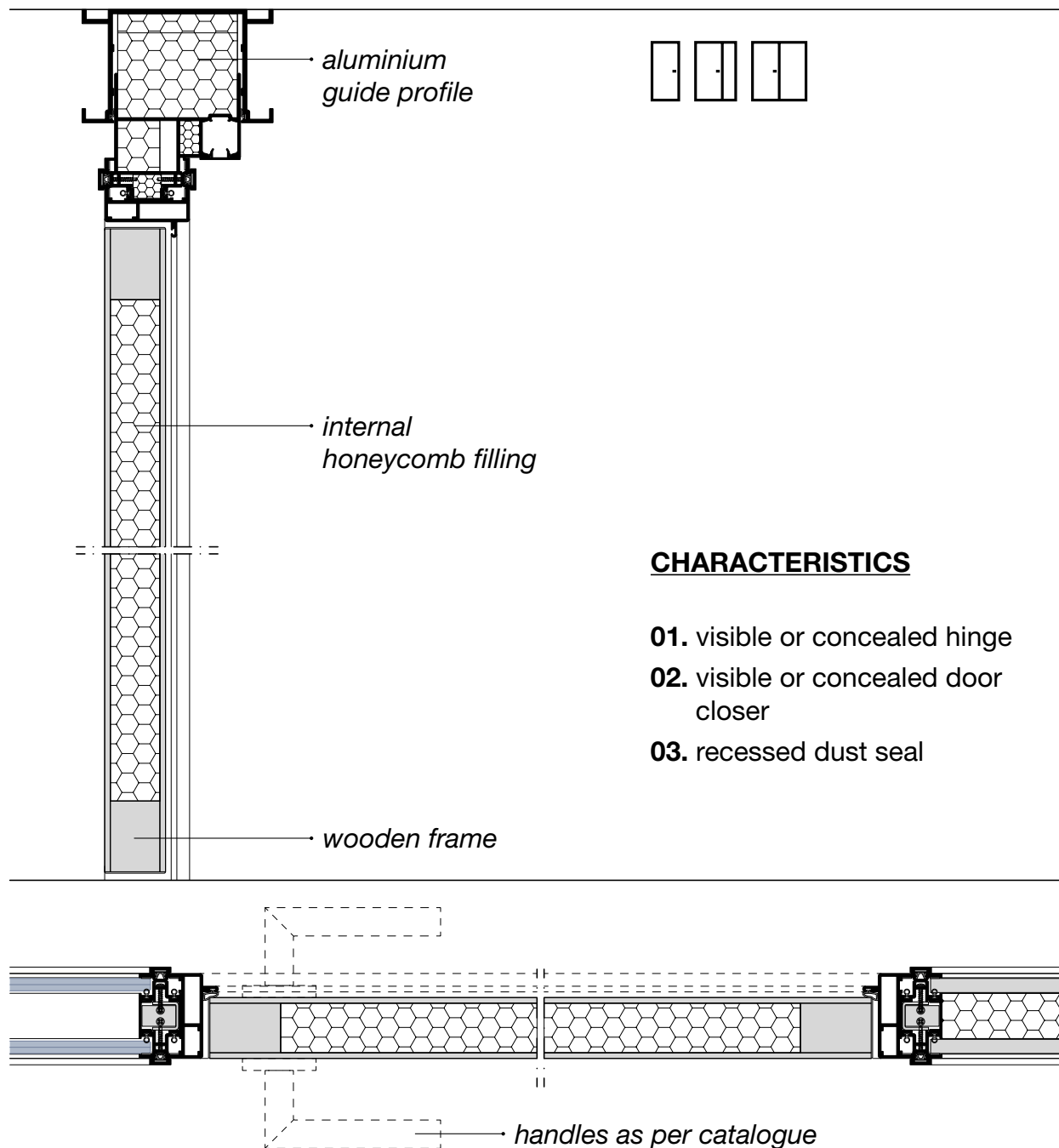

## SOLID DOOR LEAF 43 mm thick

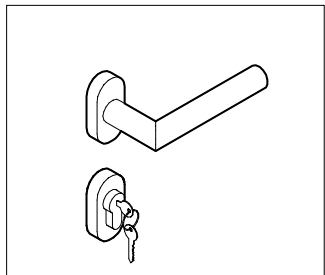

**ML5**

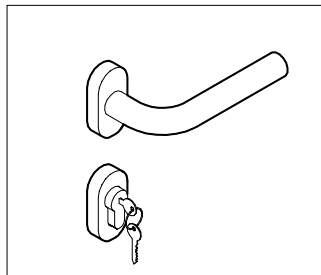

**ML6**

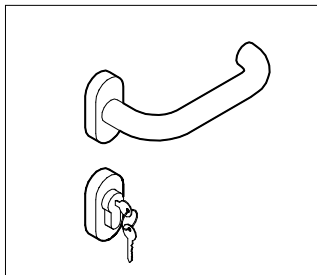

**ML7**

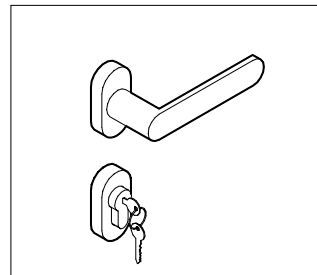

**ML8**

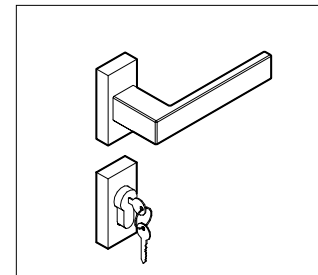

**ML9**

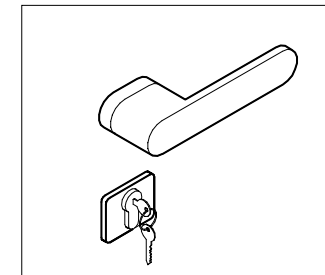

**ML10**

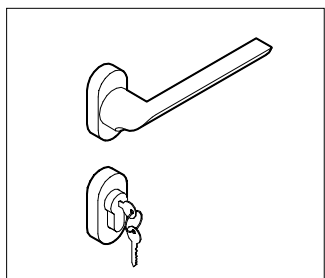

**ML11**

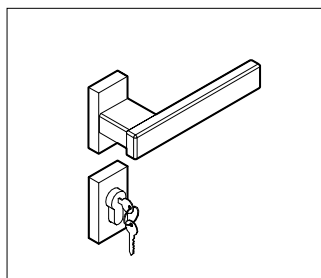

**MLQ**

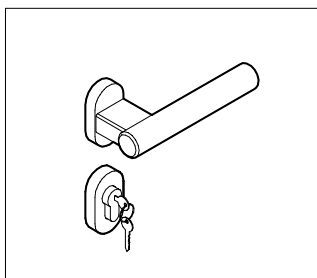

**MLT**

## TEMPERED GLASS DOOR LEAF\_VISIBLE HINGE 10 mm thick

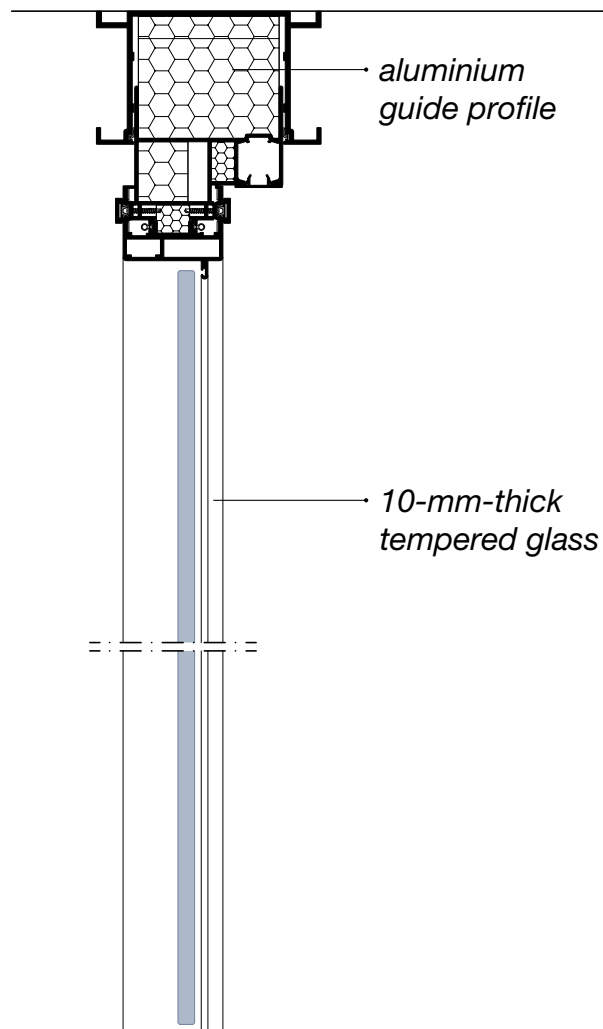

### CHARACTERISTICS

- 01.** visible hinge - 110° or 180°
- 02.** visible door closer
- 03.** handle with glass adapter
- 04.** external dust seal

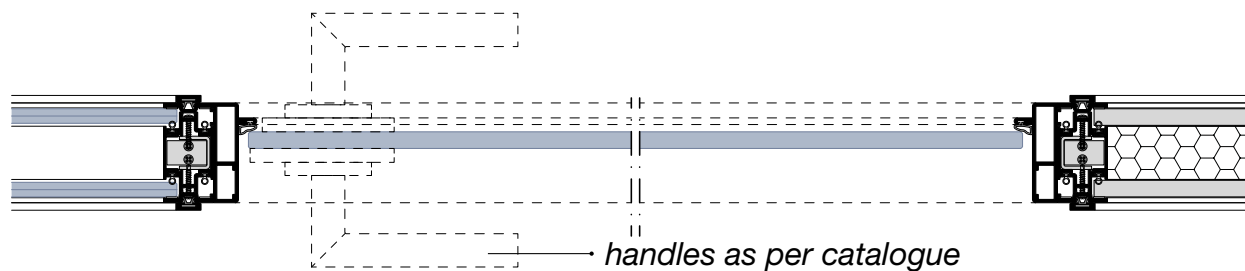

TEMPERED GLASS DOOR LEAF\_VISIBLE HINGE 10 mm thick

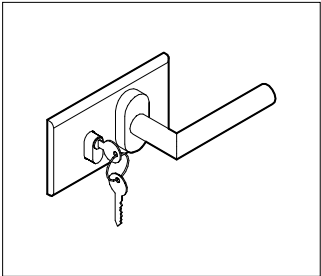

MC5

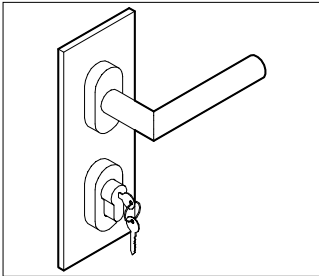

MC5V

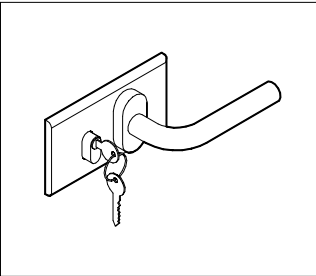

MC6

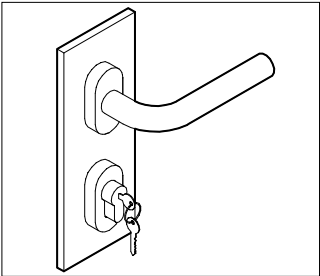

MC6V

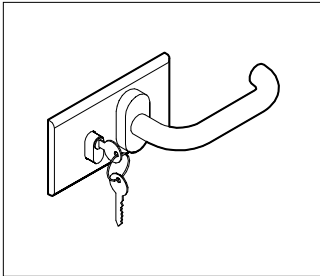

MC7

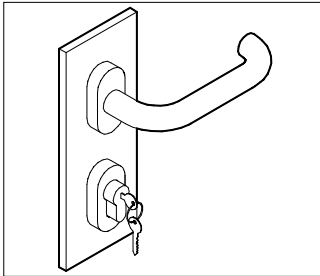

MC7V

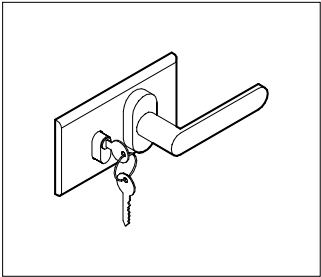

MC8

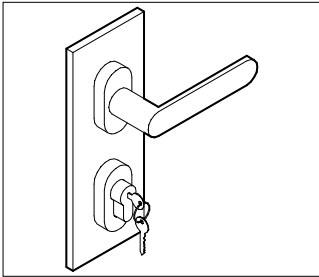

MC8V

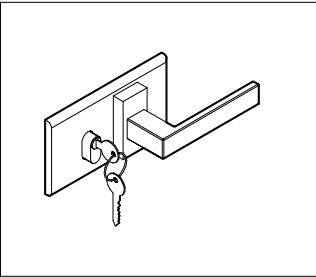

MC9

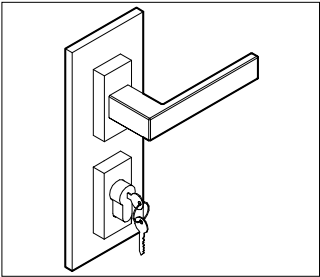

MC9V

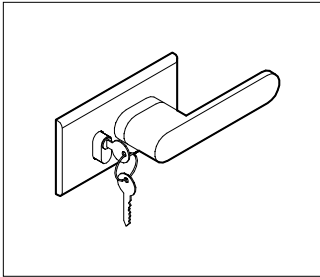

MC10

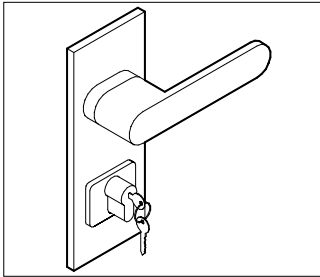

MC10V

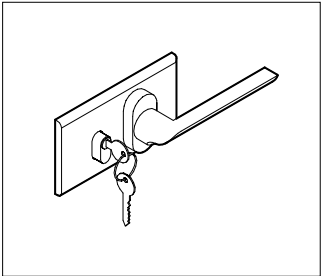

MC11

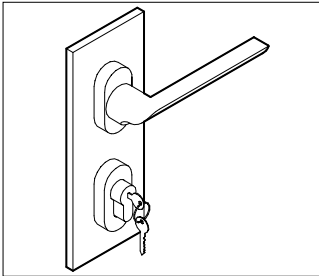

MC11V

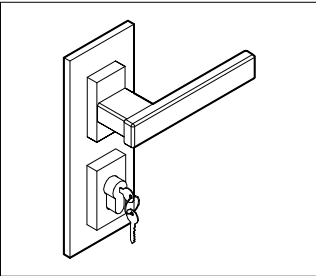

MCQ

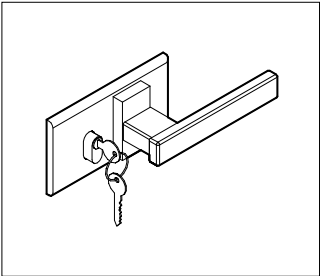

MCQO

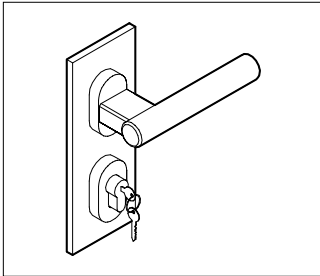

MCT

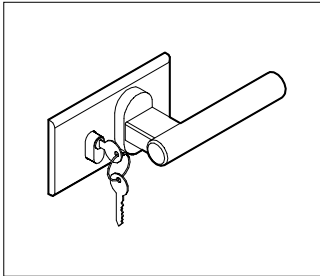

MCTO

## TEMPERED GLASS DOOR LEAF\_ANODIZED FULL-HEIGHT HINGE 10 mm thick

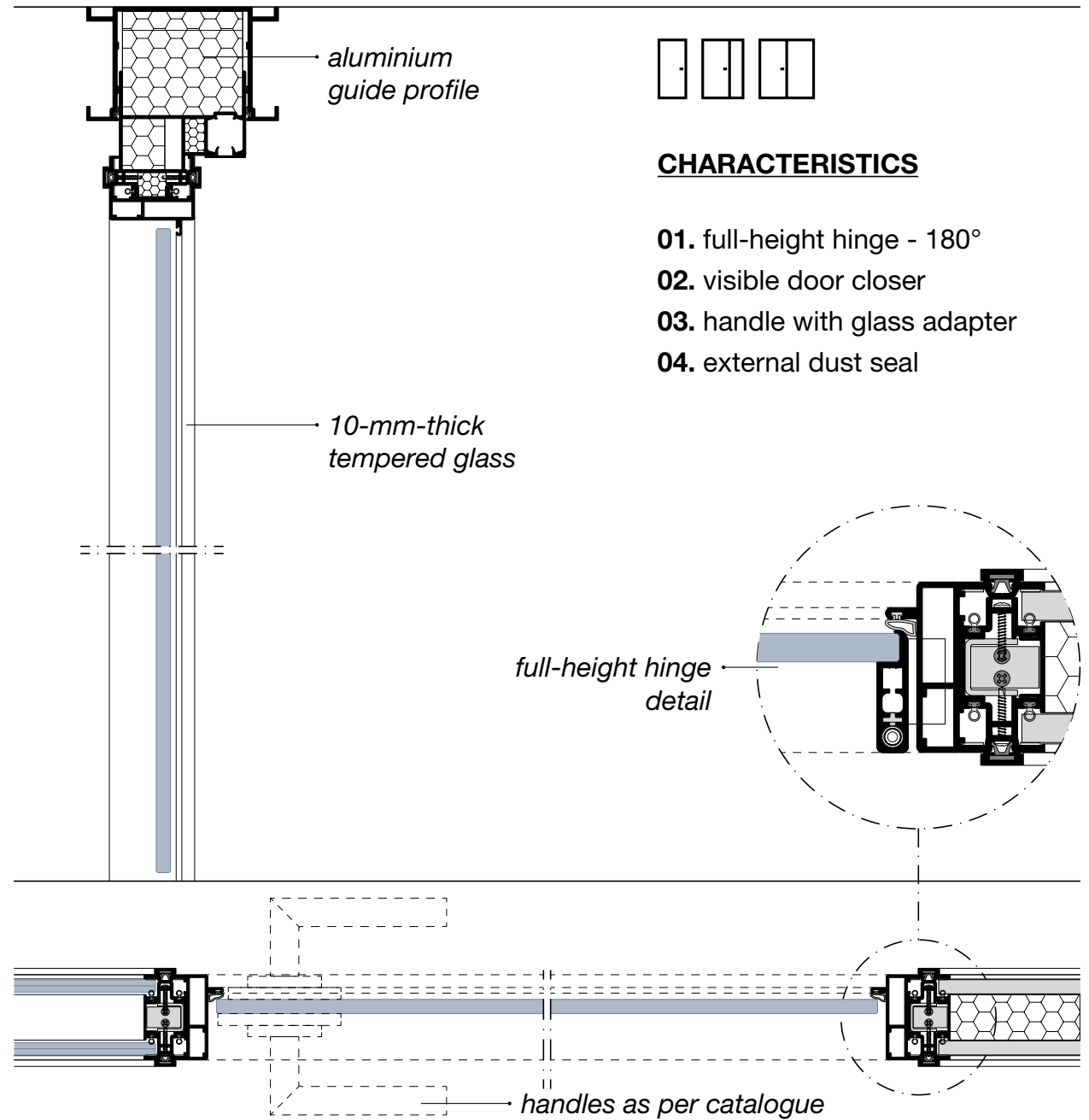



TEMPERED GLASS DOOR LEAF\_ANODIZED FULL-HEIGHT HINGE 10 mm thick

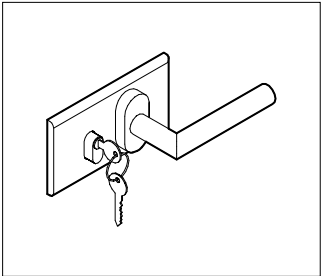

MC5

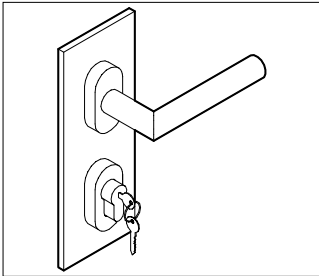

MC5V

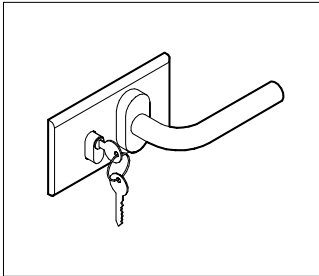

MC6

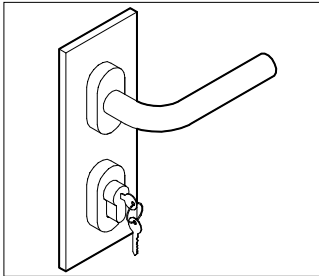

MC6V

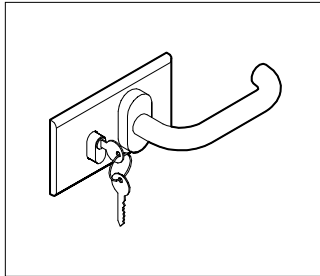

MC7

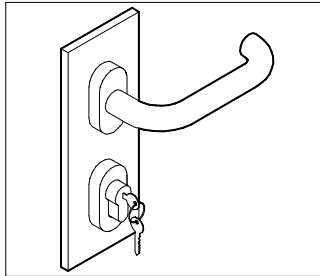

MC7V

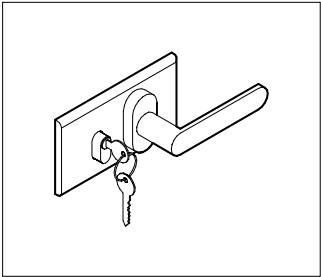

MC8

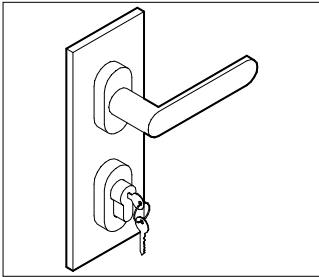

MC8V

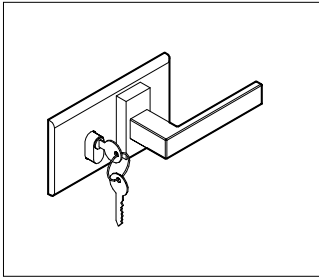

MC9

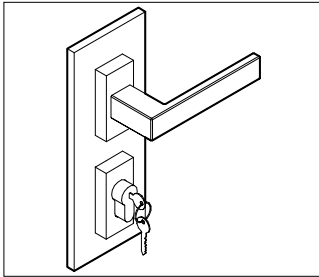

MC9V

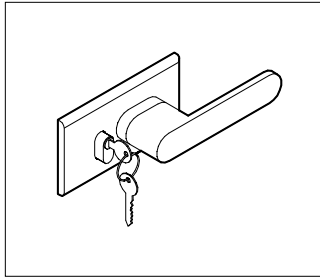

MC10

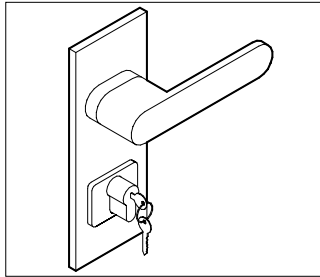

MC10V

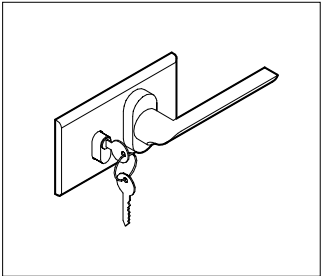

MC11

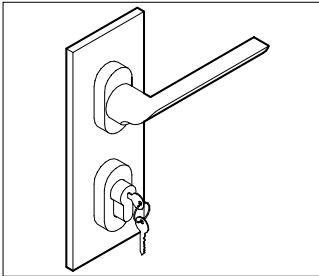

MC11V

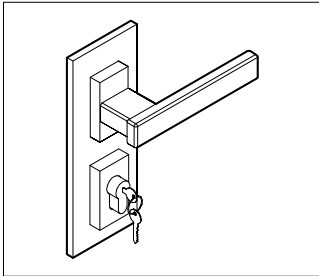

MCQ

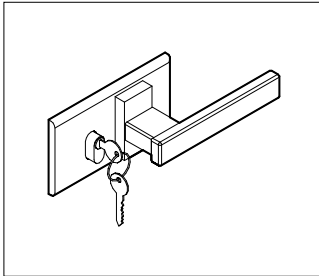

MCQO

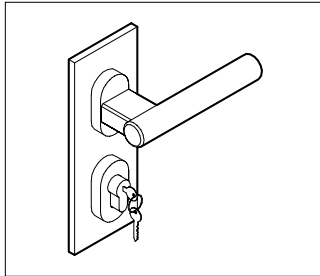

MCT

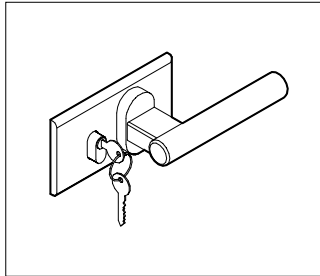

MCTO

## THIN FRAMED DOOR LEAF 43 mm thick

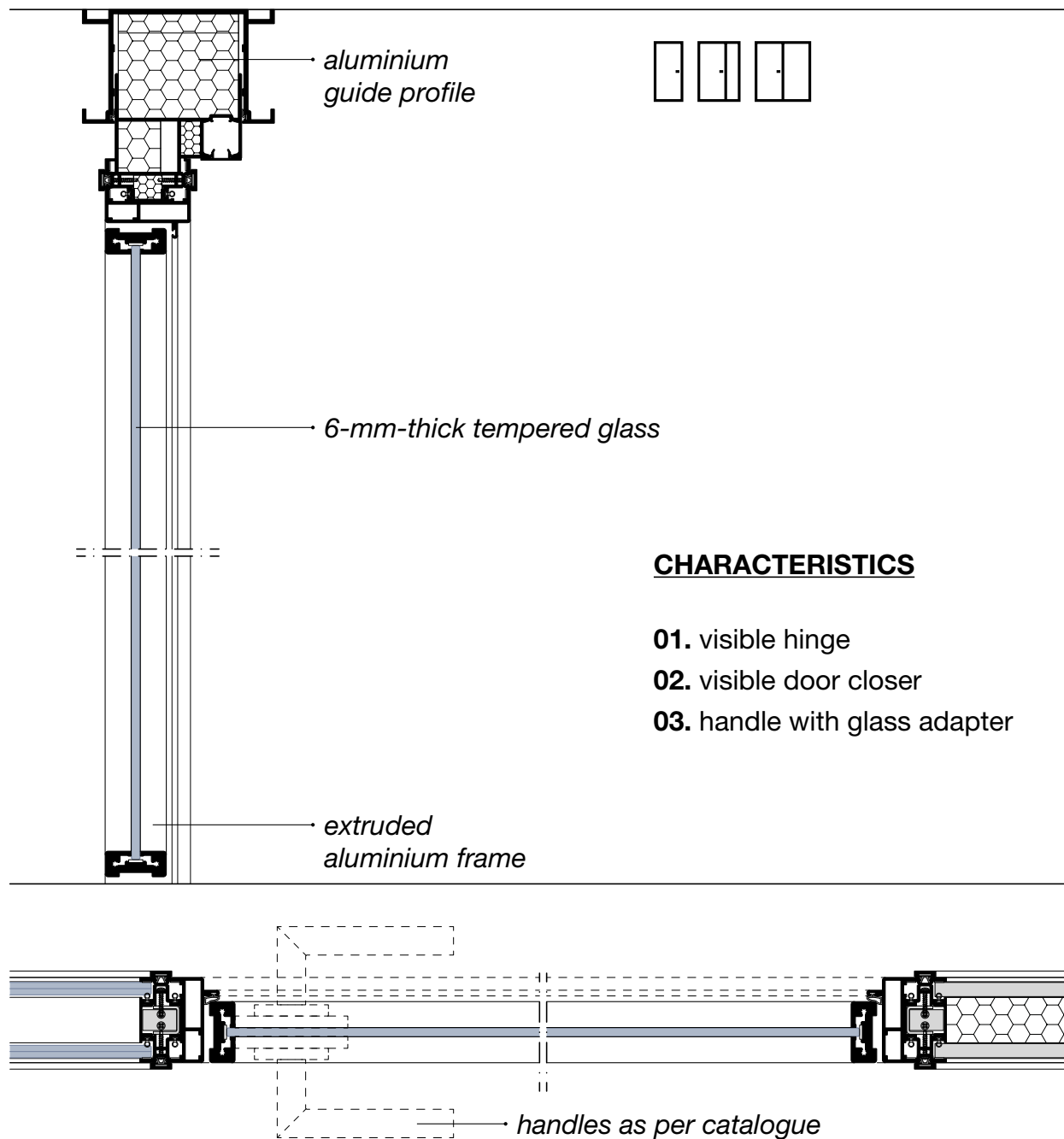

## THIN FRAMED DOOR LEAF 43 mm thick

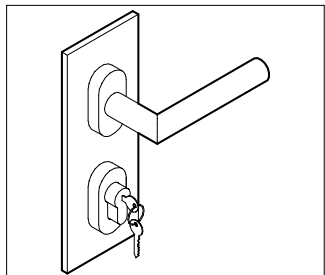

**ML5**

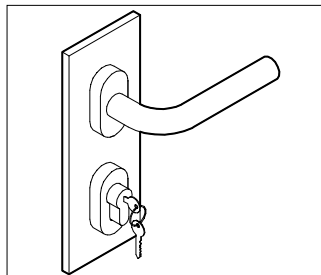

**ML6**

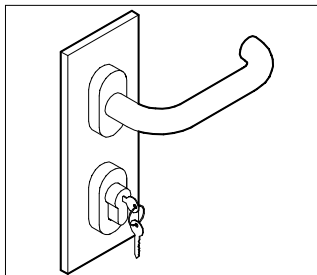

**ML7**

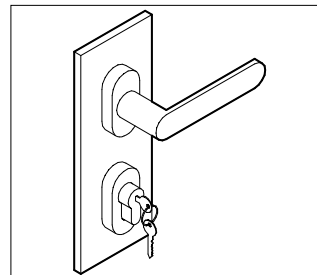

**ML8**

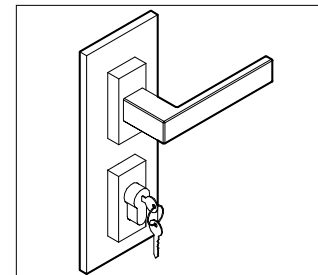

**ML9**

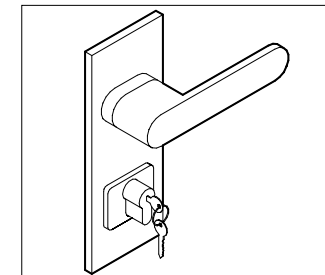

**ML10**

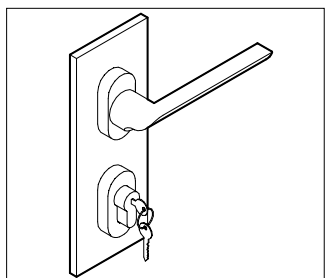

**ML11**

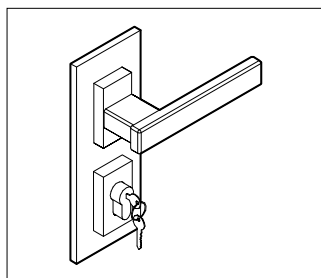

**MLQ**

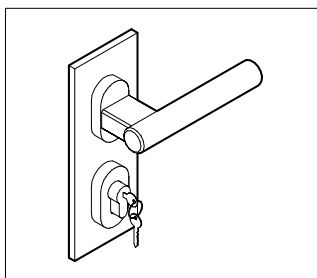

**MLT**

## MEDIUM FRAMED DOOR LEAF 43 mm thick

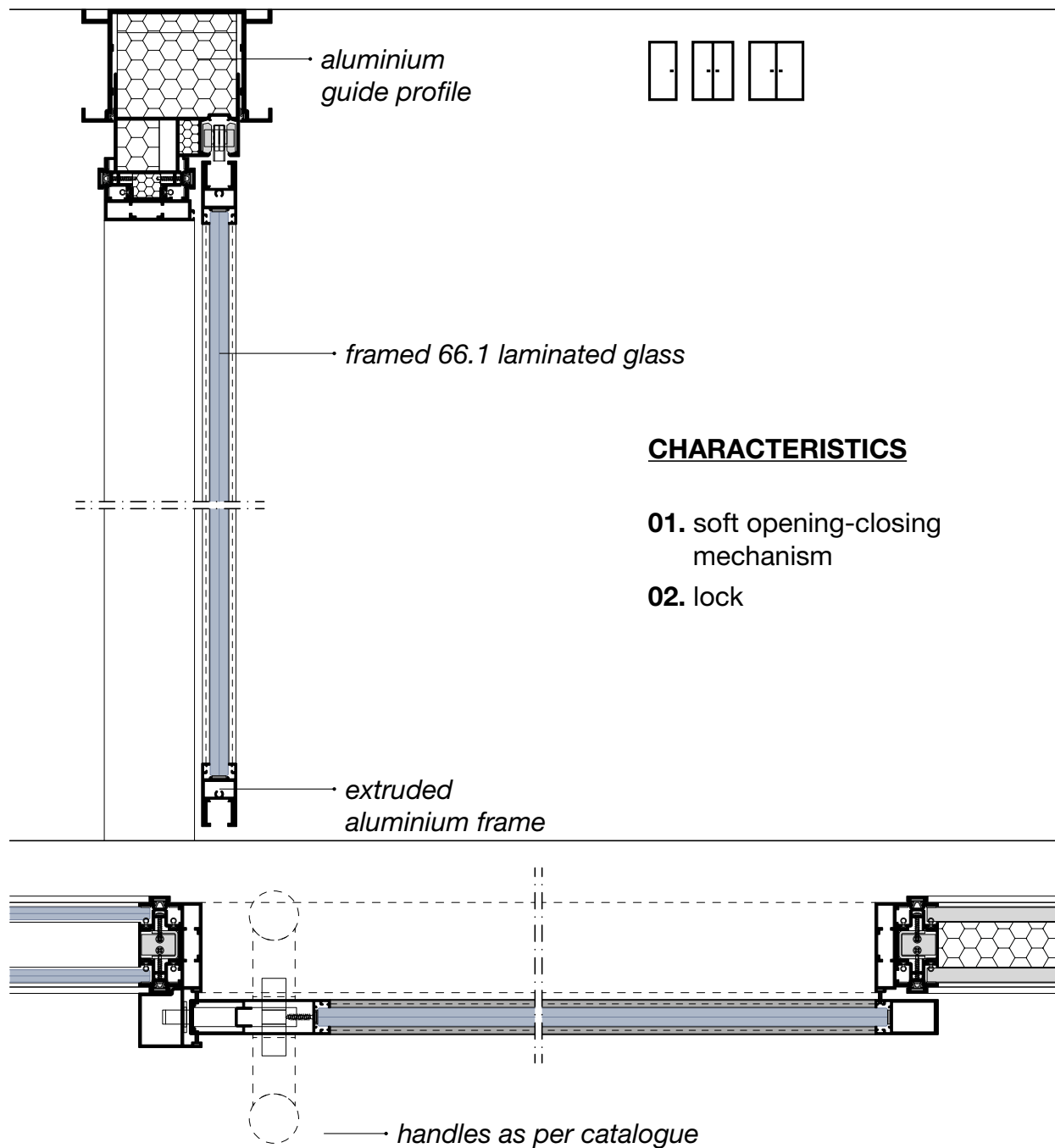

MEDIUM FRAMED DOOR LEAF 43 mm thick



STEEL

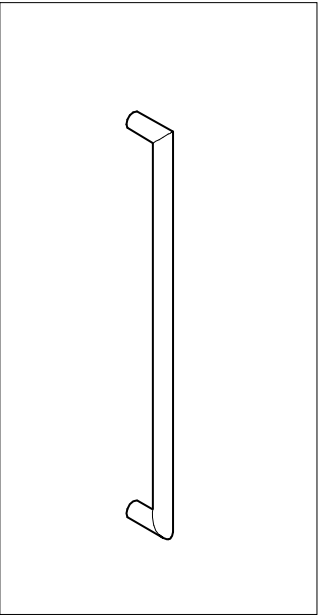

MPOMGH1\_H2\_H3

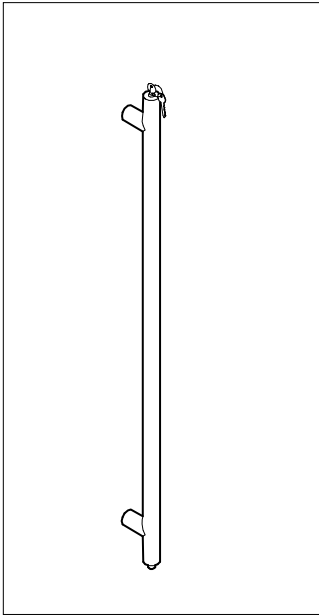

MPOM2

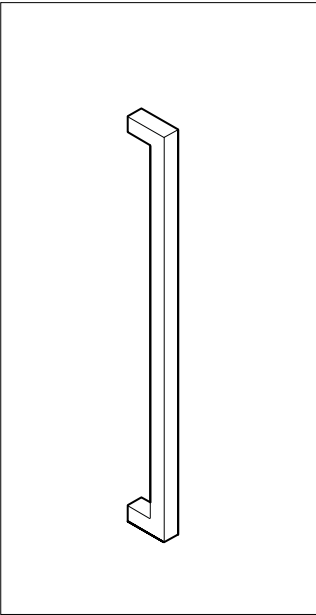

MPOMGH1Q\_GH2Q\_GH3Q

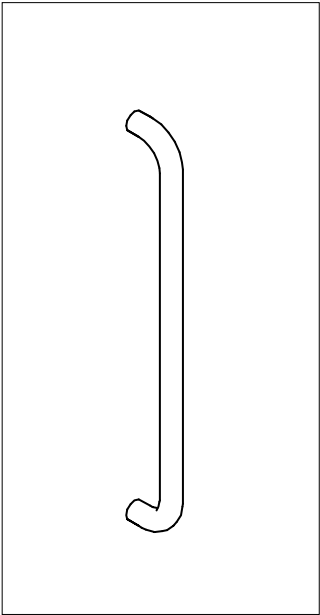

MPOM8

ALUMINIUM

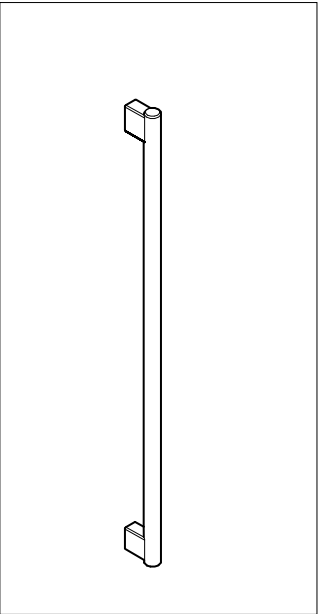

MPOMTH1\_TH2

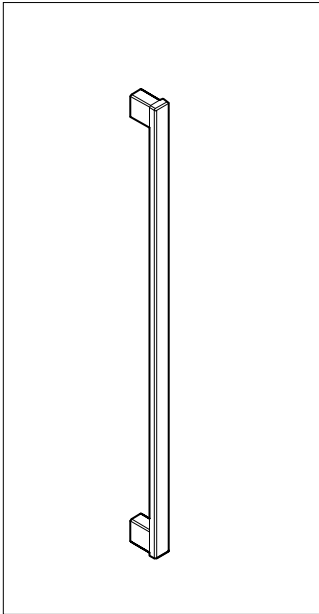

MPOMQH1\_QH2

WOOD

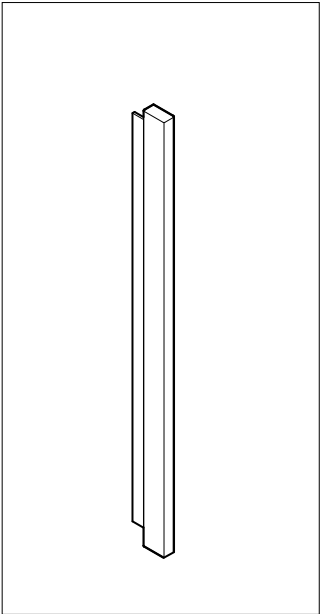

MPOMLFSS

**E.WALL**

Accessories

---



## Overhead door closer

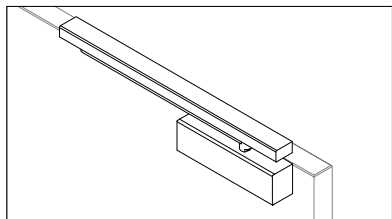

**01 external sliding closer**  
for framed/solid door

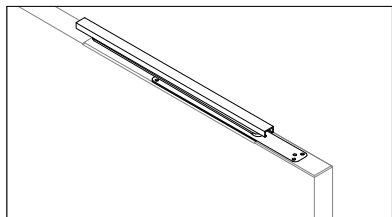

**02 concealed closer**  
for framed/solid door

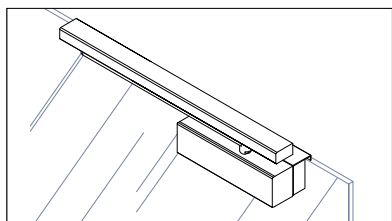

**03 external sliding closer**  
for tempered glass door

## Floor-mounted door closer

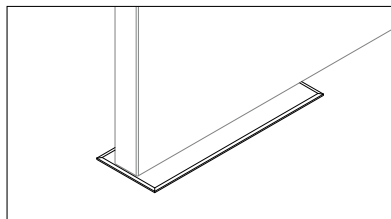

**01 floor-mounted**  
for solid door

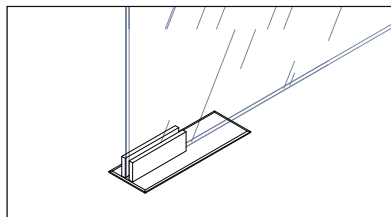

**02 floor-mounted**  
for tempered glass door

## Aluminium hinges

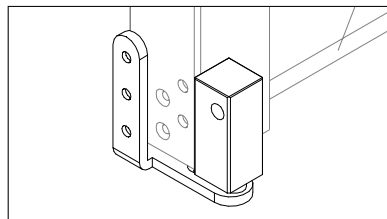

**01 external pivot closer**  
for framed/solid door

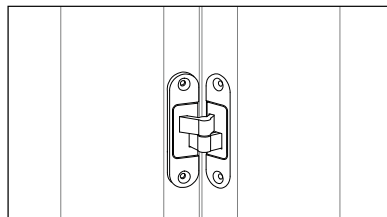

**02 concealed**  
for framed/solid door

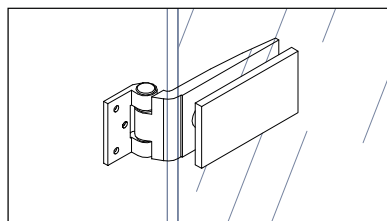

**03 180° opening**  
for tempered glass door

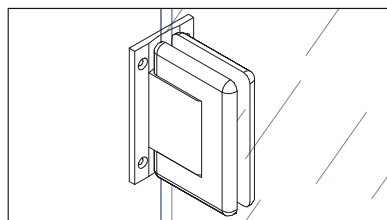

**04 two-way hinge with adjustable speed**  
for tempered glass door

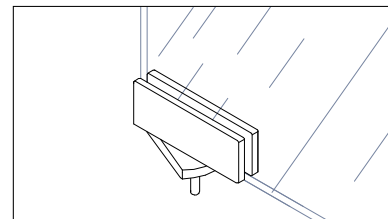

**05 two-way hinge with adjustable speed**  
for tempered glass door

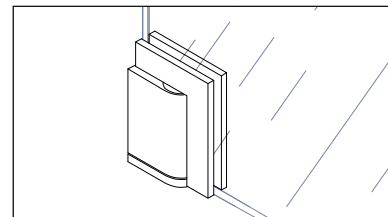

**06 two-way hinge with adjustable speed**  
for tempered glass door

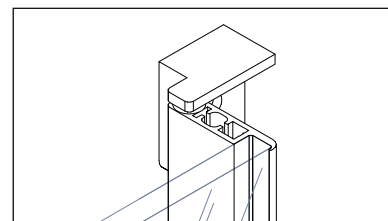

**07 full-height hinge**  
for tempered glass door

## Accessories

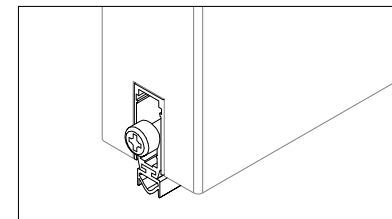

**01 concealed soundproofing draft stopper**  
for framed/solid door

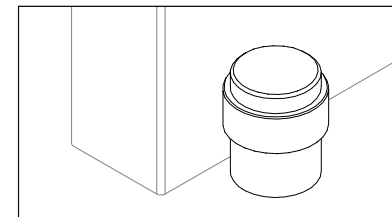

**02 door stopper**  
for solid/framed/tempered glass door

**E.WALL**

Finishes



## Frame



### Anodised

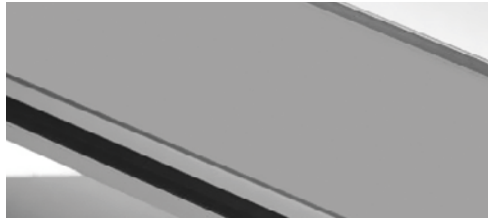

01 Natural aluminium

### RAL Finishes



01 White

### Polish

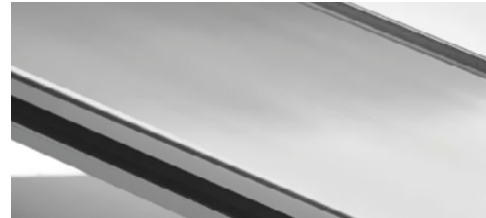

01 Shine

### Wood

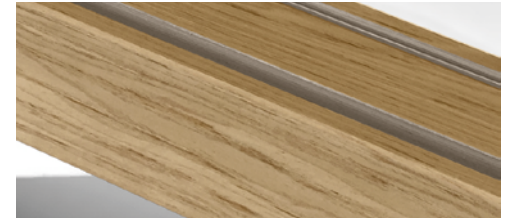

01 Light oak



02 Bronze

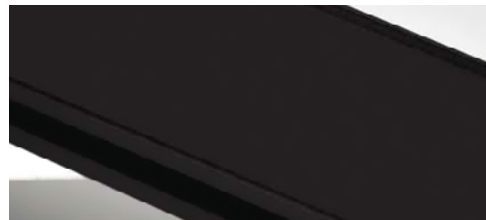

02 Black

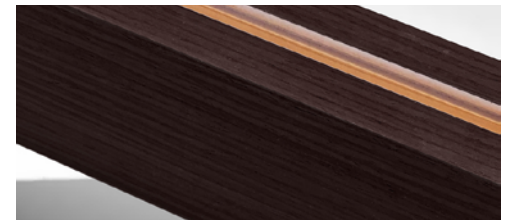

02 Dark oak

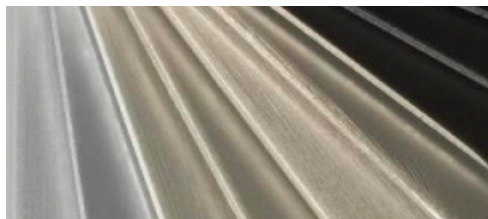

03 Custom colour



03 Custom colour

Solid panels



CAT. 1

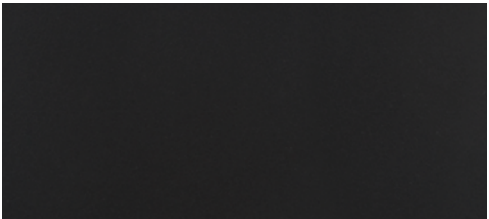

055 Graphite black

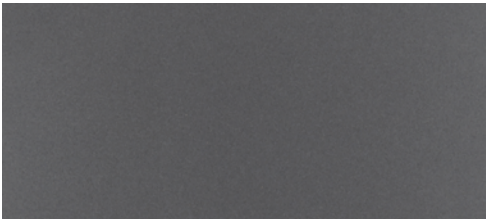

420 Gunmetal



418 Ash grey



419 Light grey



393 Dove grey

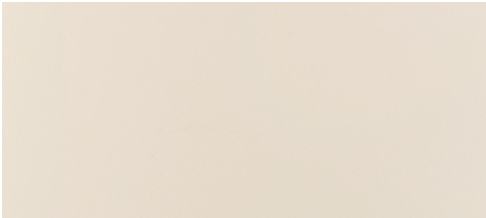

417 Vanilla

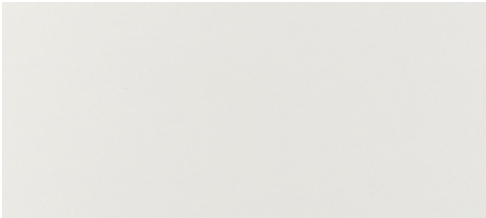

429 Warm white

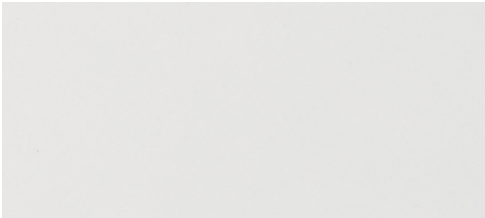

428 Cold white

CAT. 2



422 Silver



423 Champagne

Woods



CAT. 1

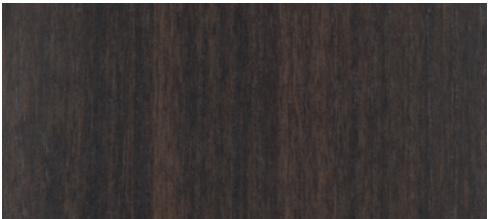

421 Eucaliptus

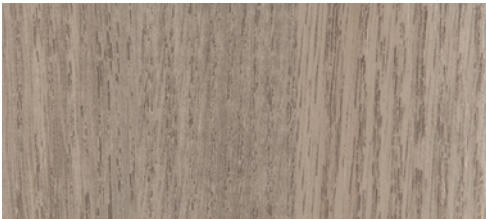

426 Mid-tone oak



274 Acacia

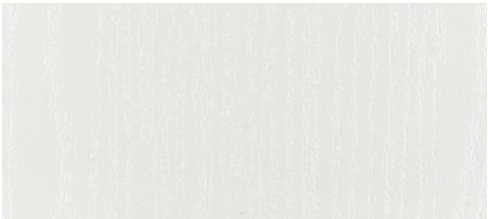

416 Streaked white

CAT. 2

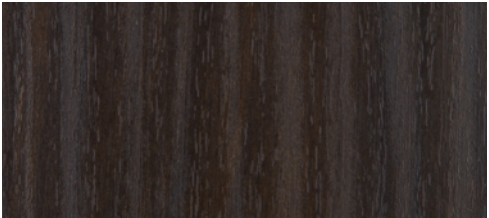

425 Dark walnut

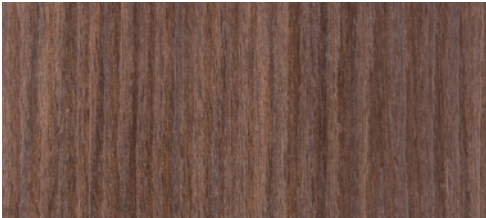

318 Mid-tone walnut

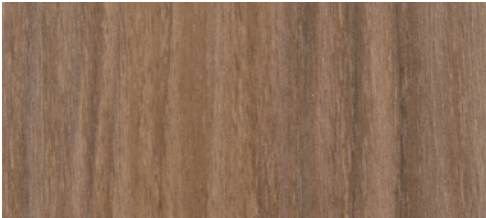

427 Light walnut

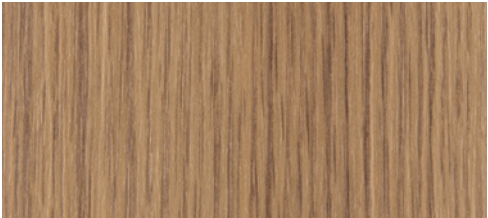

382 Natural oak

CAT. 3



138 Aged saw-cut oak

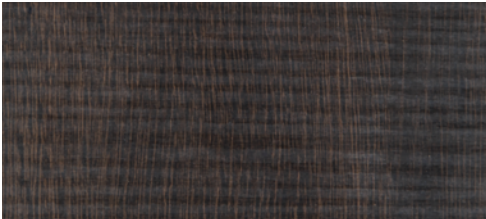

197 Saw-cut eucaliptus



408 Grey oak



400 Danube oak

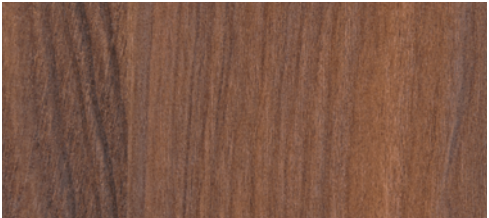

414 Red walnut



412 Vintage oak



413 Champagne oak



410 Light oak



Textures



CAT. 2

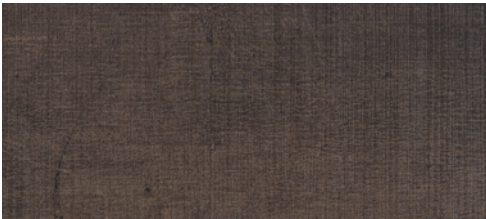

304 Dark-tone fabric



123 Mid-tone fabric



305 Light-tone fabric



424 Oxide

CAT. 3

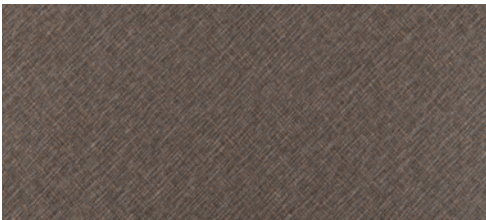

385 Bronze linen



409 Bark

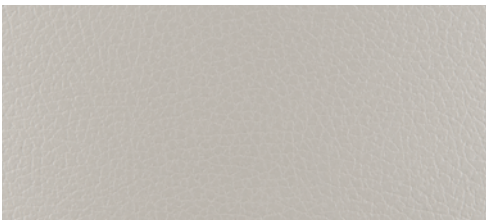

406 Primo fiore grey

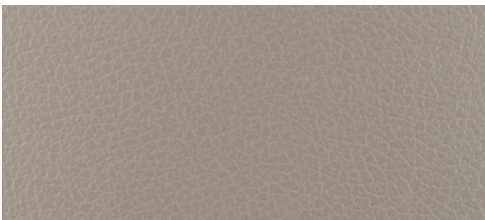

405 Primo fiore dove grey

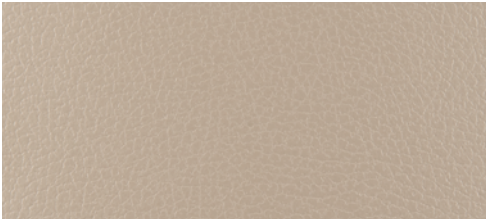

404 Primo fiore beige



415 Desert

# Glass



**01** Clear



**03** Satin

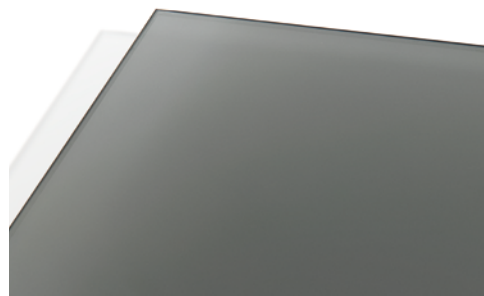

**05** Smoked



**02** Extra light

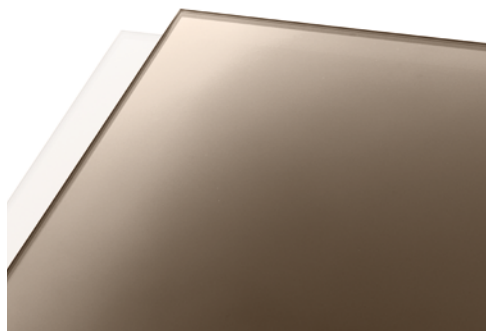

**04** Bronze



**06** Custom painted

## Other finishes



**01** Custom fabric

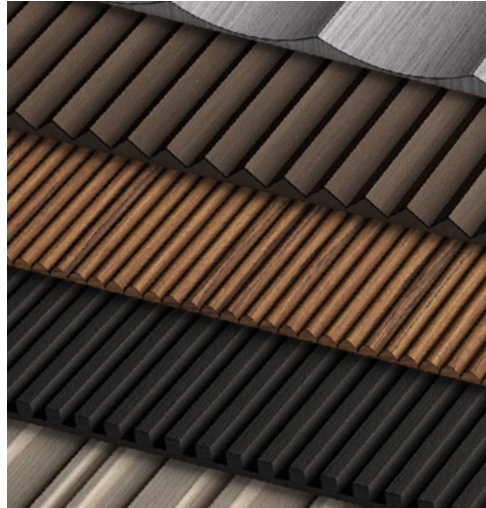

**02** Custom decorative panel

**E.WALL**

Technical specifications

---



## Technical specifications

**E.WALL** is a system of movable internal walls with a supporting aluminium structure, featuring an English-style grid framework. With a nominal thickness of **69 mm**, the partition is designed exclusively for separation purposes and can be supplied with either double-glazed modules or solid panels in various finishes.

### VERSIONS

#### **GLAZED MODULE**

Partition made of modules with framed double-glazed panels, available in 44.2a/55.2a thickness  
Acoustic performance: Double 44.2a laminated glass - 45 dB; Double 55.2a laminated glass - 46 dB

#### **SOLID WOOD MODULE**

Partition made of double solid panels with a 10 mm thickness, fabricated from wood particleboard with a high-density core

#### **MIXED SOLID AND GLASS MODULE**

Partition made of modules with framed double glazing of 44.2a/55.2a thickness and double solid panels made of 10 mm thick wood particleboard.  
Acoustic performance: Solid/Glass 44.2a - 42 dB

### GENERAL DESCRIPTION

The wall, that has a total thickness of 69 mm, is made of an **extruded aluminium alloy 6060 UNI 9006/1** structure (floor rails, telescopic top beam, uprights, wall-end uprights and door frames) designed to accommodate safety-glass closing panels and solid panels or other monolithic materials as requested by the customer.

The floor and ceiling **rails** and wall profiles allow for perfect levelling of the wall both horizontally and vertically, as well as excellent sealing against existing walls.

The ceiling-mounted **telescopic beam** compensates for any possible deformations in the upper ceiling, ensuring the partition remains perfectly stable under all static conditions.

The partition features fixed **corner profiles** that allow for 2-way, 3-way, and 4-way connections.

The panels are **connected linearly** using intermediate aluminum uprights.

**Doors** can be either hinged or sliding (external), and can be supplied at both wall height or standard height.





## Technical specifications

Both types of doors can be single-leaf, double asymmetrical/reduced leaf or double-leaf.

**Hinged doors** can be made of wood, framed single glass or glass only. The framed version allows for the installation of recessed overhead door closers and lower acoustic dust seals; on the glazed version only an external door closer can be installed.

The **sliding version** can be made of single framed glass. Correct sliding is ensured by soft-stop mechanisms for closing and opening the doors.

The 43-mm-thick **honeycomb-core wood door** has an internal honeycomb structure inserted in a firwood perimeter frame and fibreboard panels on both sides, finished with HPL laminate edged and ABS edges. Thickness=10/10 mm.

The **framed glass door** has perimeter extruded profiles in 6060 UNI 9006/1 aluminium alloy, of different width, and an internal tempered (6mm) or laminated glass (6+6 mm), clear or frosted.

**Wooden or framed-glass doors** are supplied with different types of hinges: external pivot hinges with 180° opening; hinges concealed in the frame, hinges adjustable on three axes, with 180° opening.

The **glass door** is made with a 10-mm-thick tempered glass panel, with clear or frosted finish. The hinges provided for flush doors can be: in die-cast aluminium, with 110° or 180° opening; aluminium or steel pivot hinges, with 180° opening; aluminium or steel linear hinges, with 180° opening.

For dimensional and resistance reasons, door frames cannot receive switches or sockets.

To allow for adequate **cable management** inside the wall, a **utility module** is provided to facilitate the installation of switches, sockets, thermostats, alarm sensors and other dimensionally compatible equipment.

Doors can be matched to a **wide range of standard handles** that can be further expanded thanks to the use of locks with a universal plate, suitable for the installation of out-of-catalogue items.

These walls can be perfectly **integrated** with the Quadra storage system.



**01.** Double glass partition 44.2a (laminated 4+4+pvb 0.76) - Acoustic test -  
**Certificate no. 426191 IT/EN - UNI EN ISO 10140-2:2010 and UNI EN ISO 717-1:2013**

**02.** Solid/double glass partition 44.2a (laminated 4+4+pvb 0.76) - Acoustic test -  
**Certificate no. 426192 IT/EN - UNI EN ISO 10140-2:2010 and UNI EN ISO 717-1:2013**

**03.** Double glass partition 55.2a (laminated 5+5+pvb 0.76) - Acoustic test -  
**Certificate no. 426193 IT/EN - UNI EN ISO 10140-2:2010 and UNI EN ISO 717-1:2013**



**Etoile s.r.l. - Società Unipersonale**

Via Delle Industrie, 9/B 61040 Sant'Ippolito ( PU ) Italy

P. +39.0721.85.59.34

info@etoilesrl.it - [www.etoilesrl.it](http://www.etoilesrl.it)