



ETOILE

METRICA® S





- 01.** Spessore 104 mm
- 02.** Struttura portante in lamiera zincata UNI EN 10143
- 03.** Parete a pannelli verticali e fasce orizzontali
- 04.** Pannelli a passo 500/1000/1500/2000 mm
- 05.** Doppio vetro a filo esterno con perimetro serigrafato - spessore 5 mm
- 06.** Profili d'angolo fissi e variabili - connessioni 2/3/4 vie
- 07.** Telaio porta cablabile
- 08.** Modulo tecnico ispezionabile
- 09.** 9 versioni di porte battenti - cieche, in vetro temperato e intelaiate
- 10.** 5 versioni di porte scorrevoli esterne - cieche, in vetro temperato e intelaiate

- 01.** Doppio vetro verticale 5 mm - **38 dB**
- 02.** Doppio vetro orizzontale 5 mm - **41 dB**
- 03.** Doppio vetro verticale 5 mm + pannello cieco da **39 dB** a **44 dB**

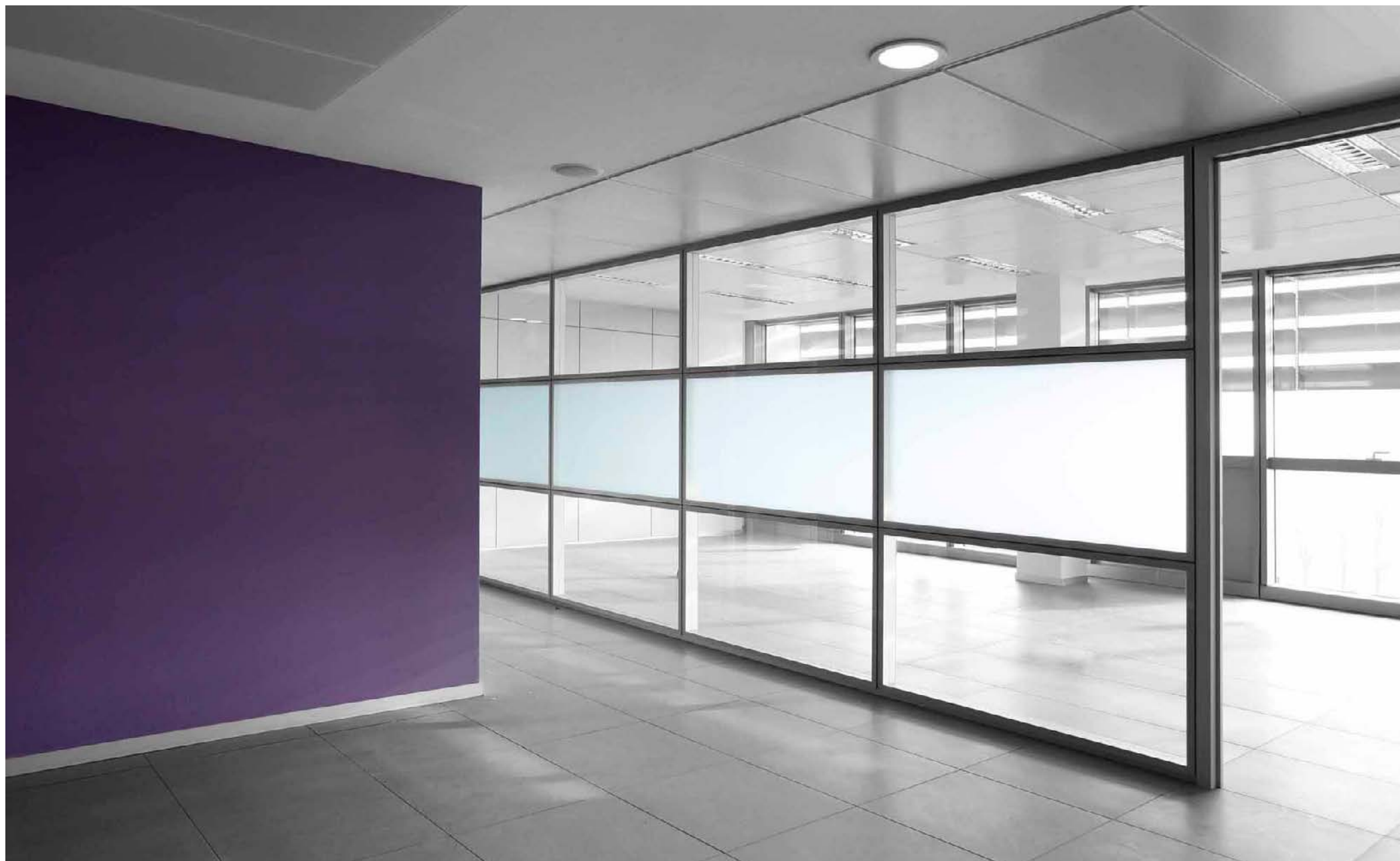

Partenze

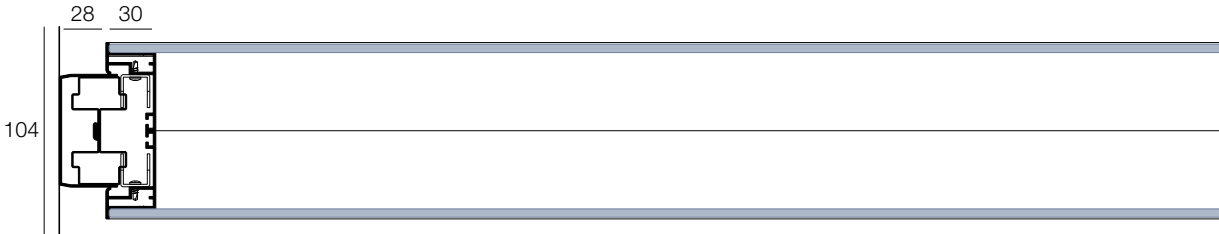
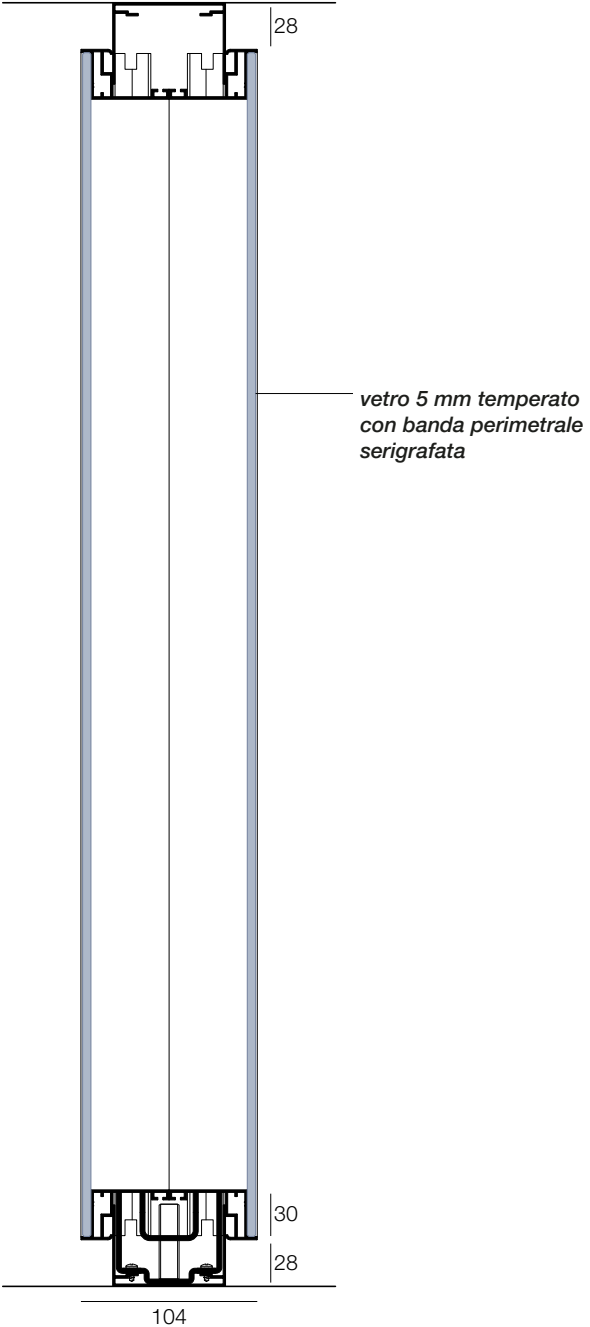

Partenza telescopica

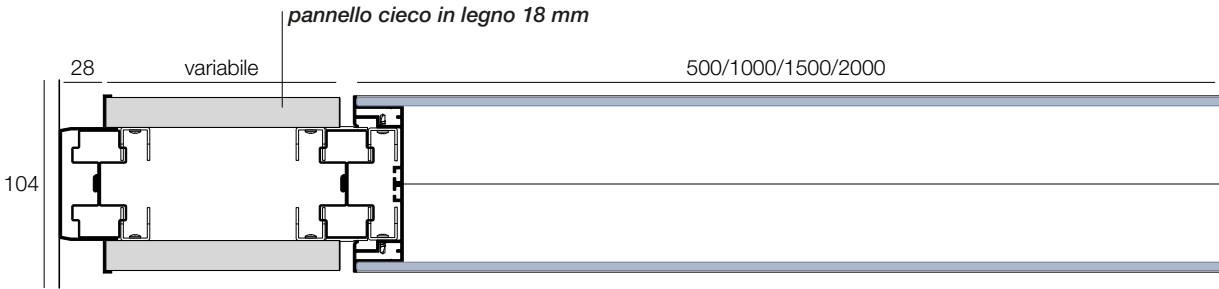

Partenza da tamponamento

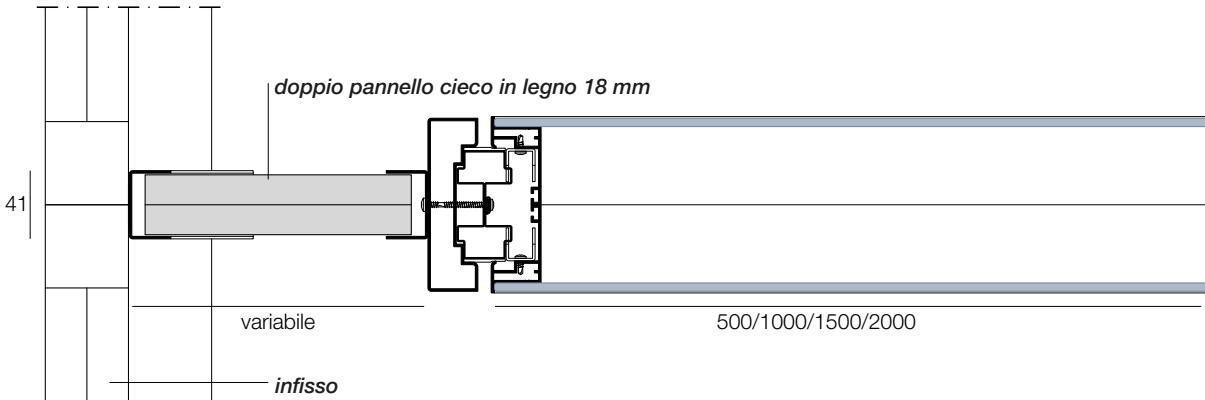

Partenza da parete

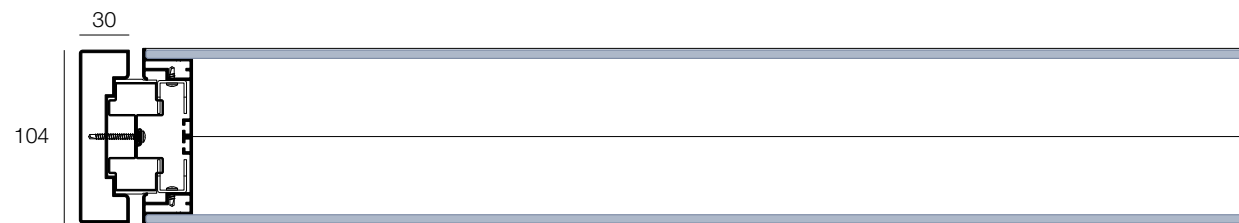

Profilo terminale

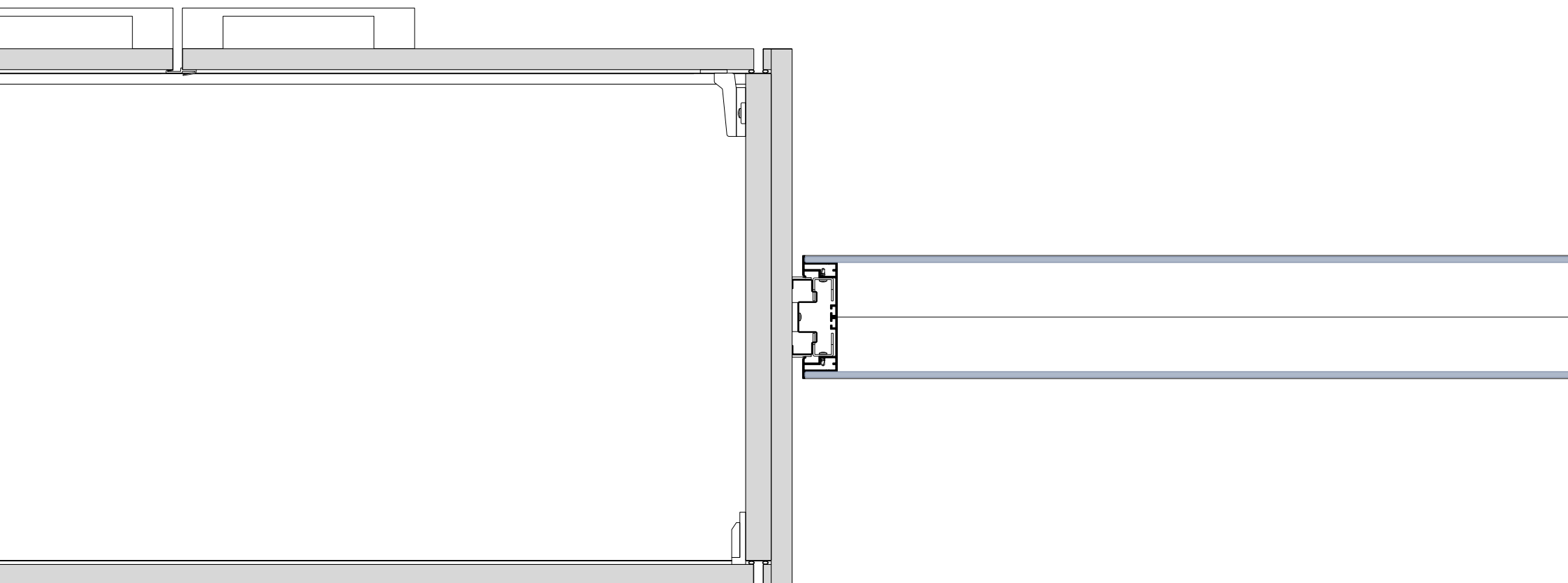

Partenza da contenitore

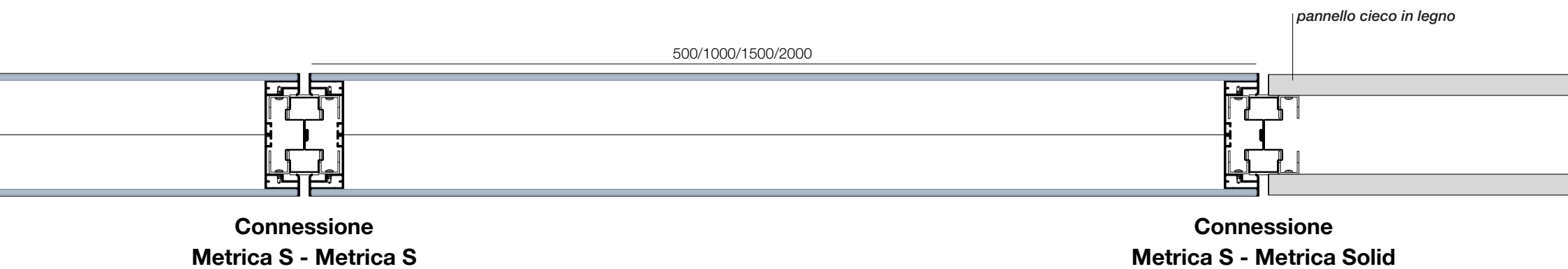

Angoli

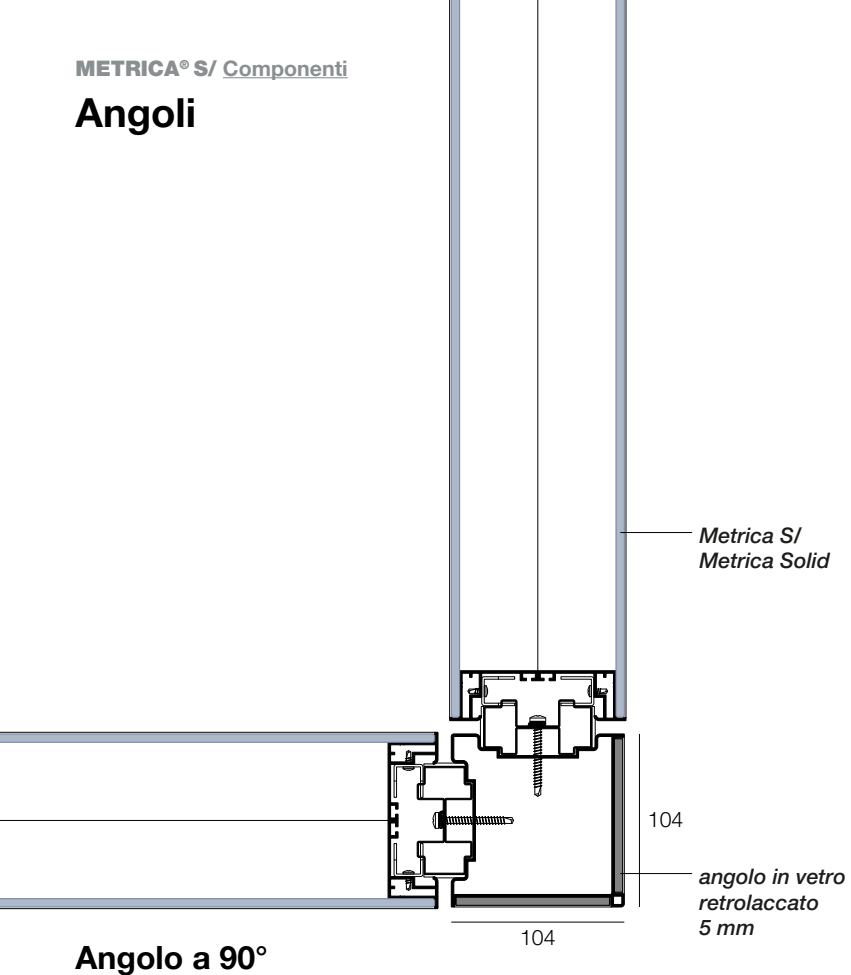

Angolo a 90°

Angolo 2 vie

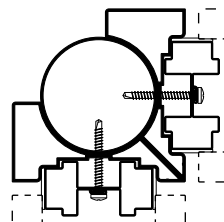

Angolo variabile

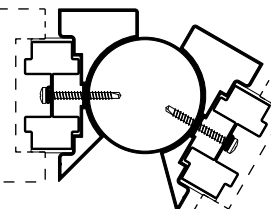

Angolo 3 vie

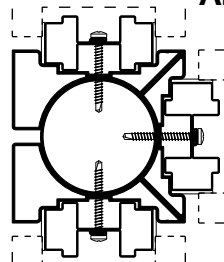

Angolo 4 vie

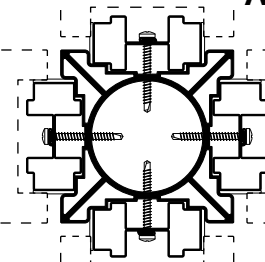

Cablaggio e modulo tecnico della porta a battente

Modulo tecnico

Soluzione di cablaggio

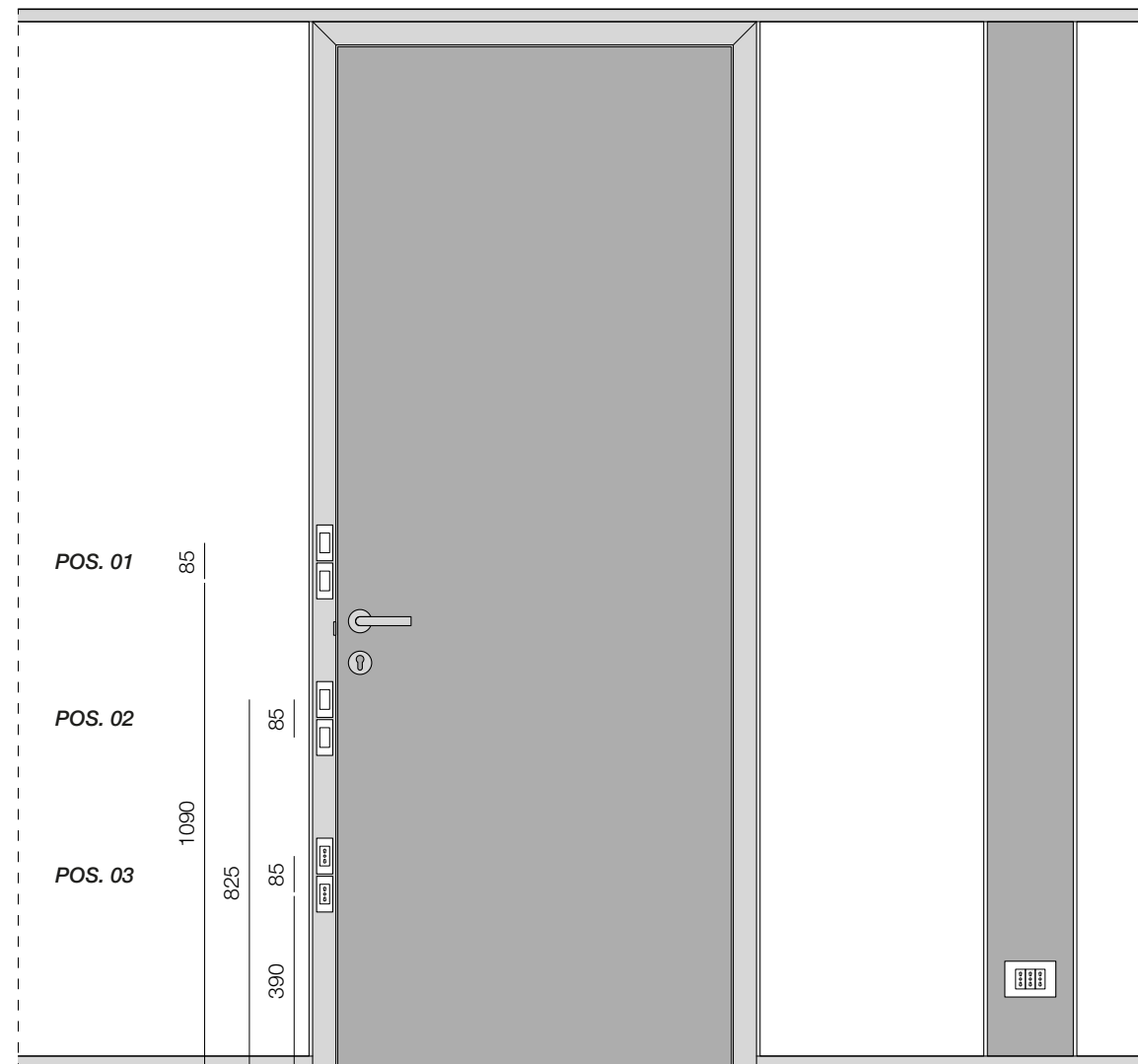
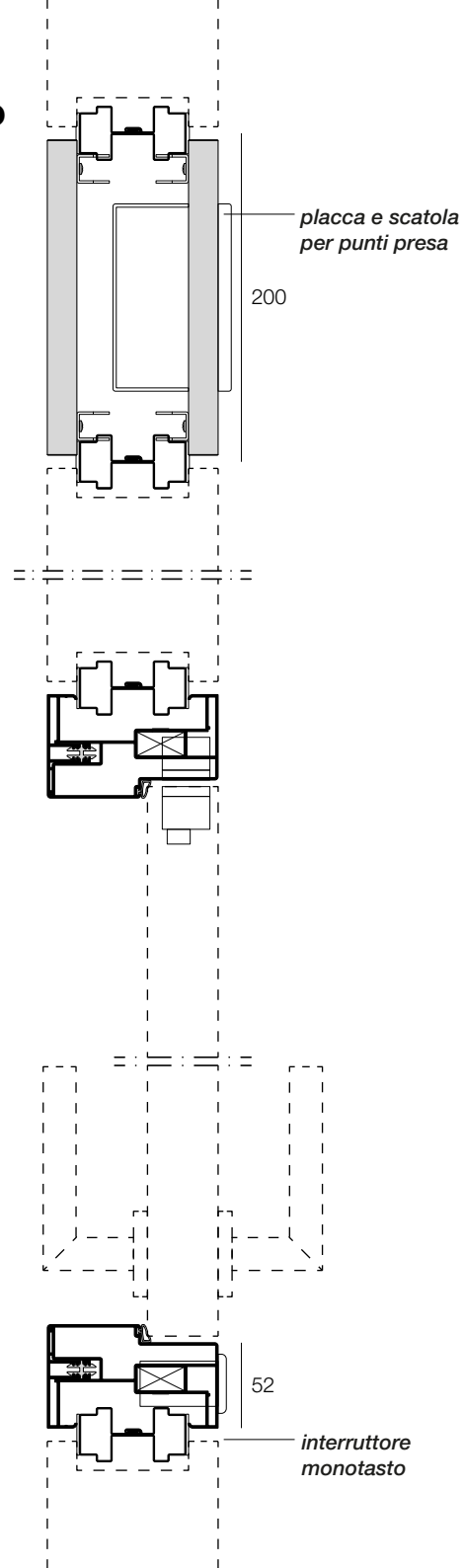

*posizioni possibili di interruttori e prese su telaio porta

Modulo tecnico della porta scorrevole



Modulo tecnico

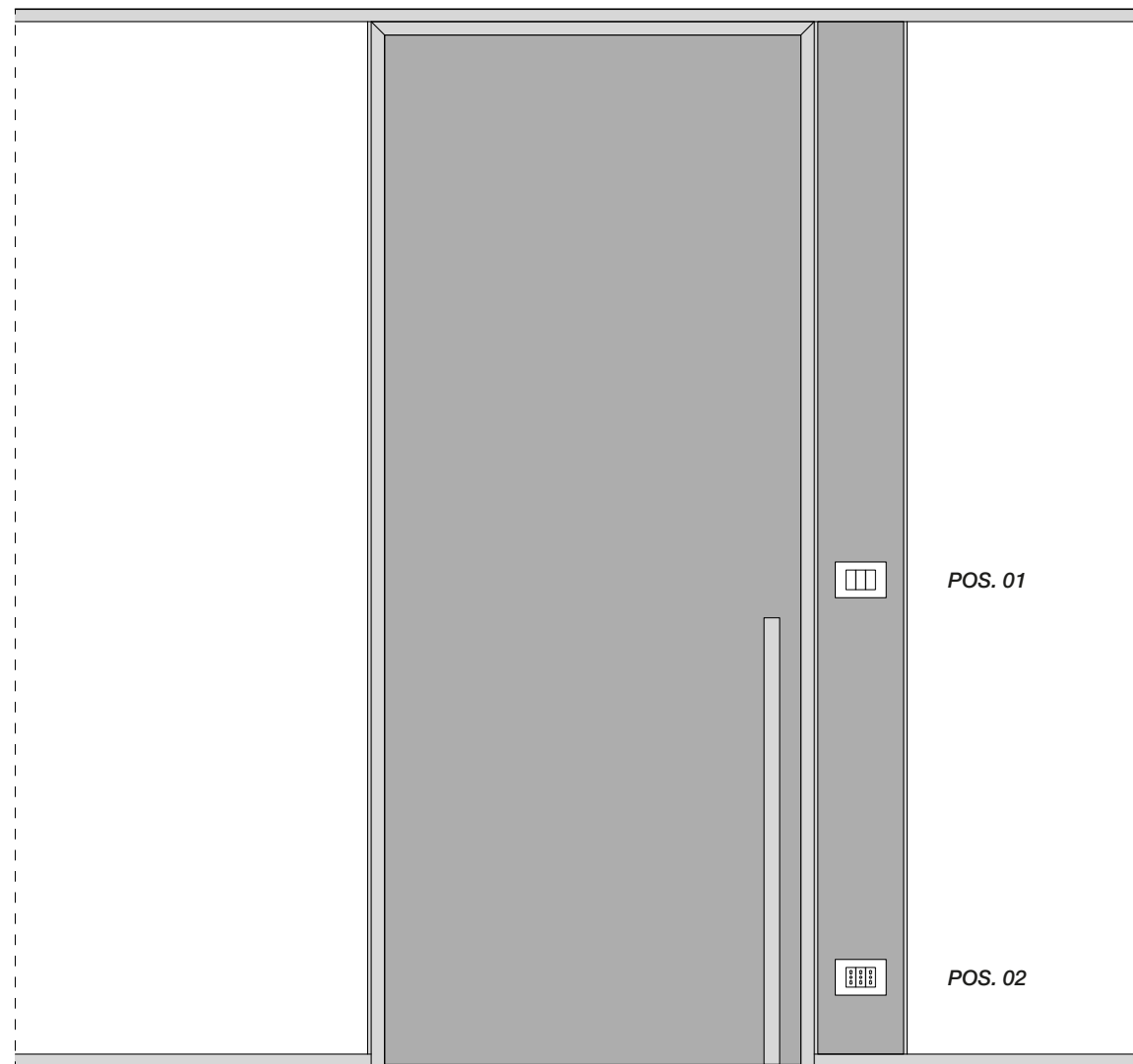
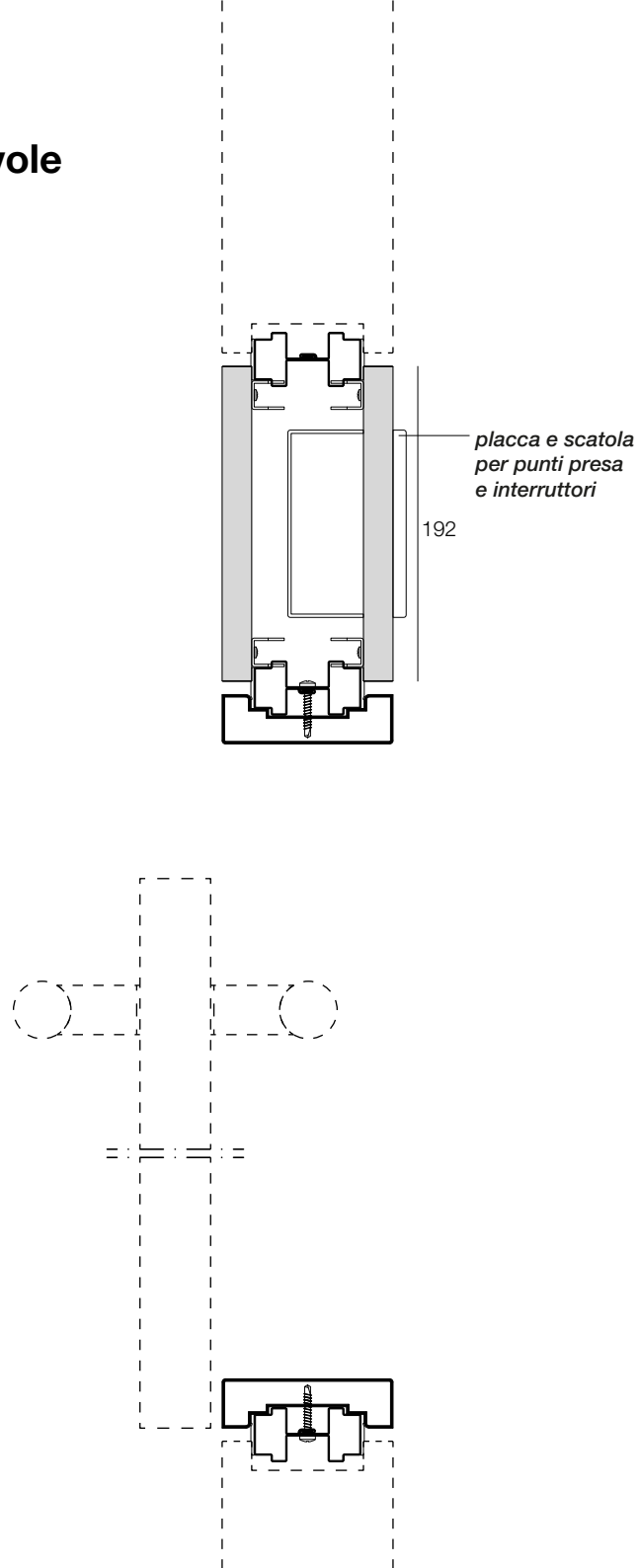

**posizioni possibili di interruttori e prese su modulo tecnico*

METRICA®
STRUTTURALE

Porte e maniglie

TELAI PORTE BATTENTI



Telaio porta su **Metrica R**

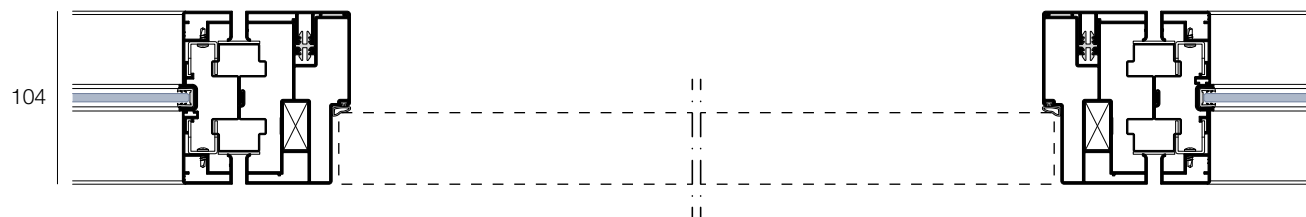

Telaio porta su **Metrica V**

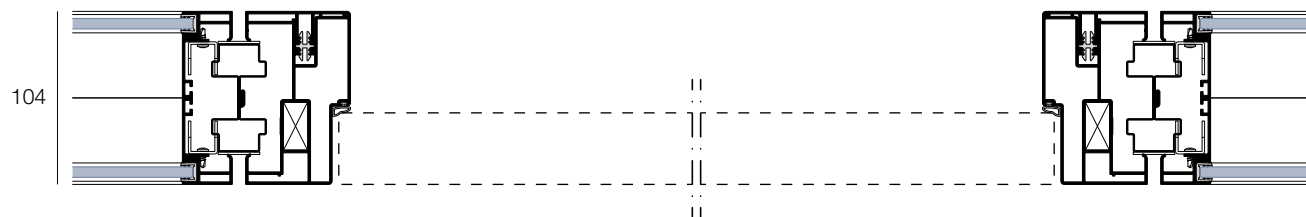

Telaio porta su **Metrica S**

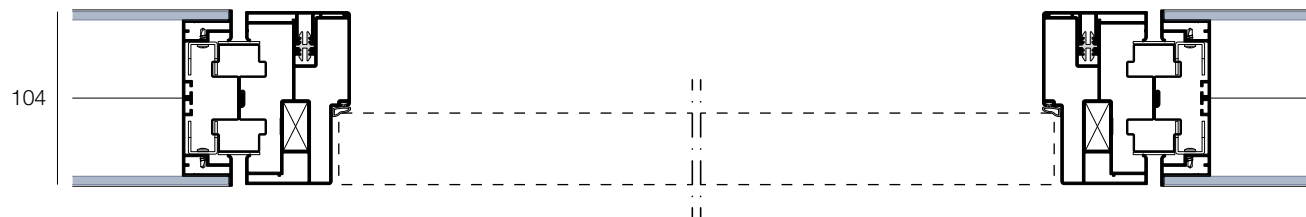

Telaio porta su **Metrica Solid**

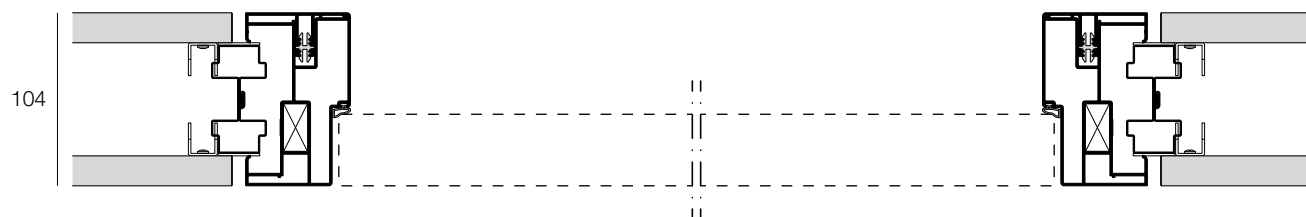

ANTA CIECA sp. 43 mm

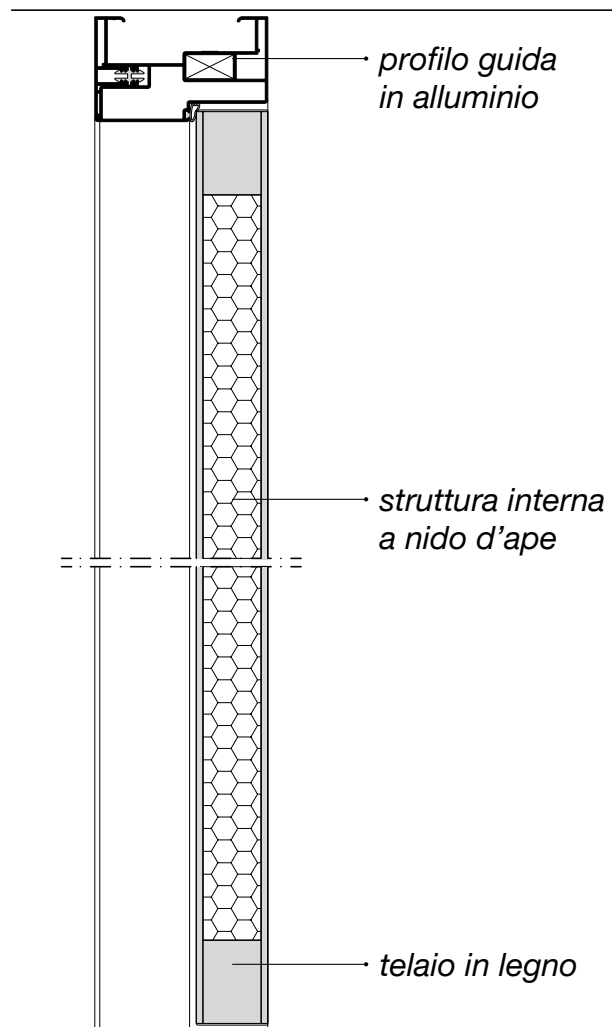

CARATTERISTICHE

- 01.** cerniere a vista o a scomparsa
- 02.** chiudiporta a vista o a scomparsa
- 03.** interruttore su montante porta
- 04.** ghigliottina incassata

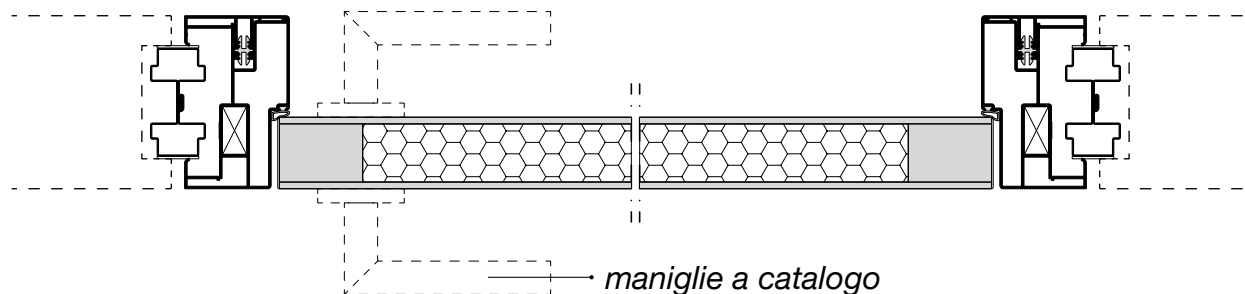

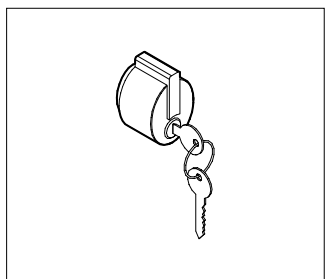

ML1

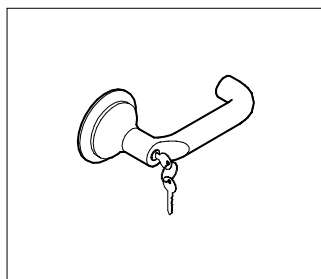

ML4

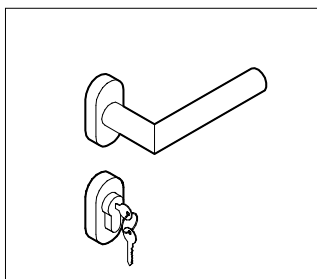

ML5

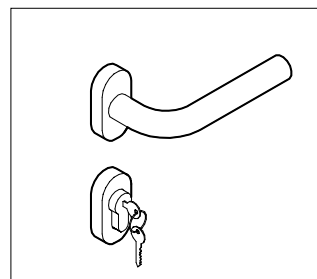

ML6

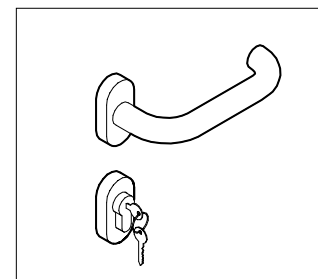

ML7

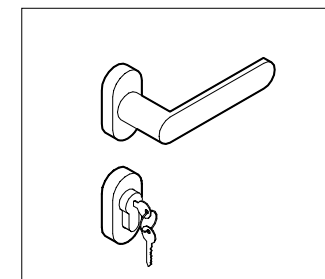

ML8

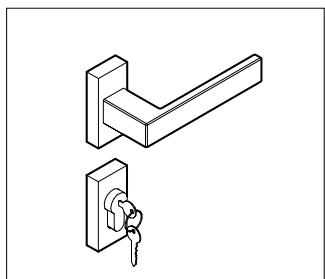

ML9

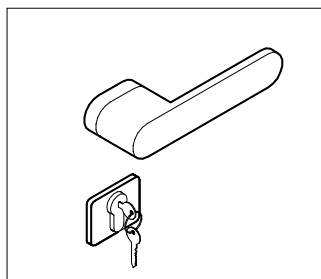

ML10

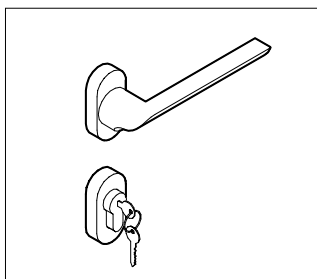

ML11

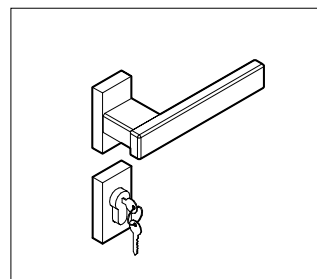

MLQ

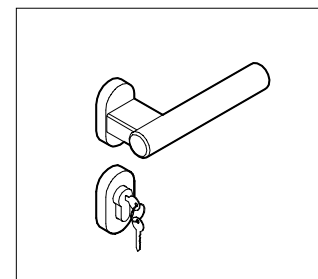

MLT

ANTA VETRO TEMPERATO_CERNIERE A VISTA sp. 10 mm

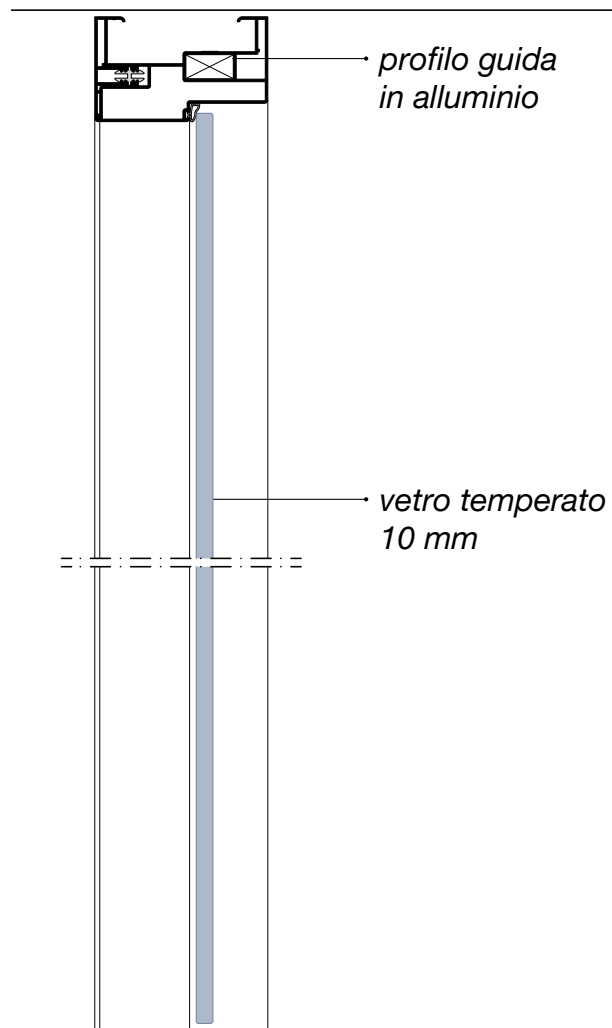
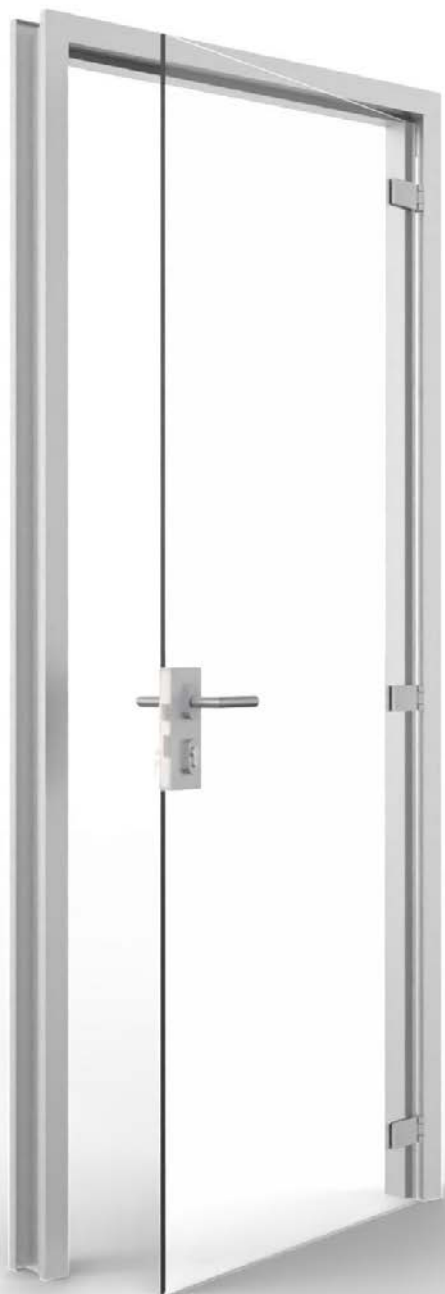

CARATTERISTICHE

- 01.** cerniere a vista - 110° o 180°
- 02.** chiudiporta a vista
- 03.** maniglia con adattatore per vetro
- 04.** interruttore su montante porta
- 05.** ghigliottina esterna

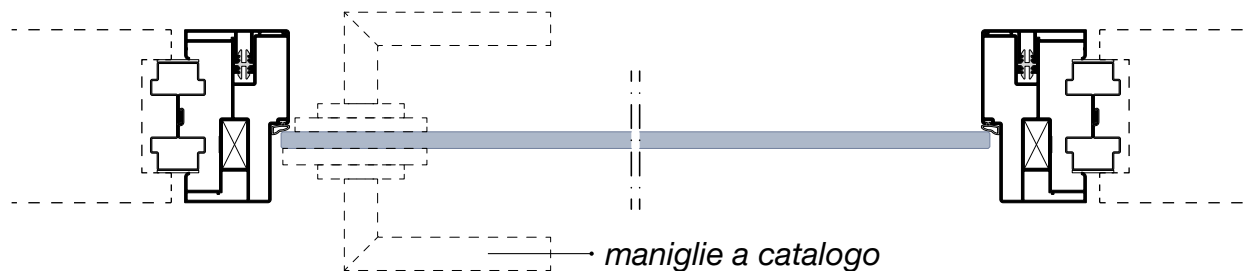

ANTA VETRO TEMPERATO_CERNIERE A VISTA sp. 10 mm

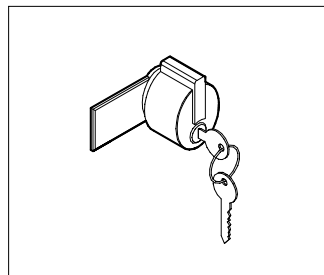

MC1

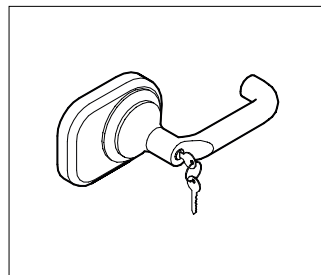

MC4

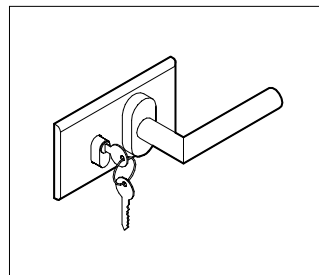

MC5

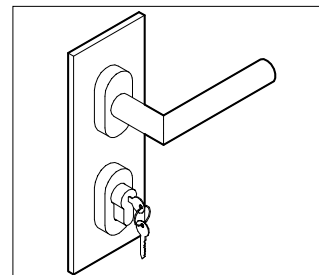

MC5V

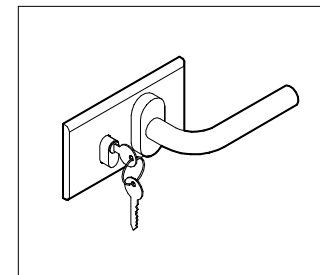

MC6

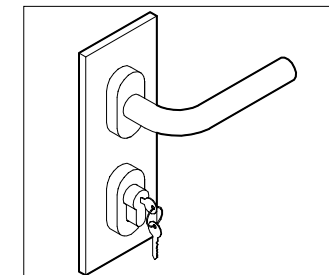

MC6V

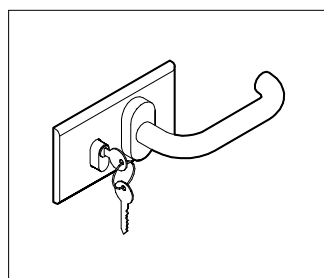

MC7

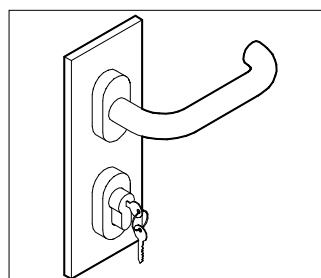

MC7V

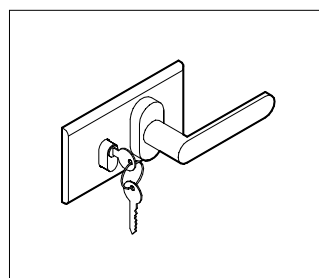

MC8

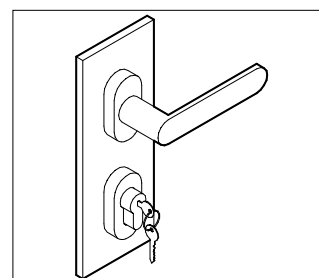

MC8V

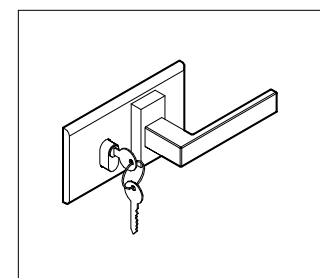

MC9

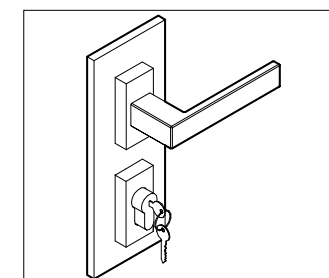

MC9V

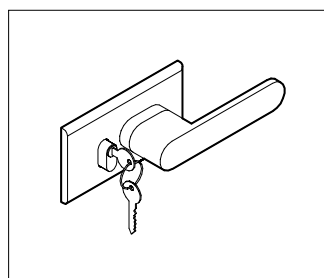

MC10

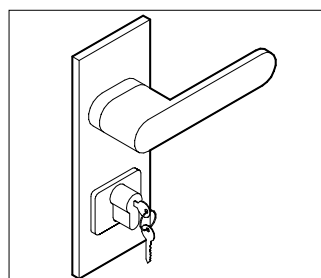

MC10V

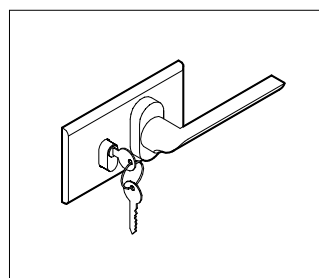

MC11

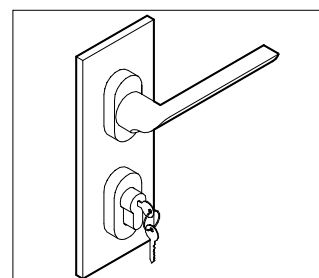

MC11V

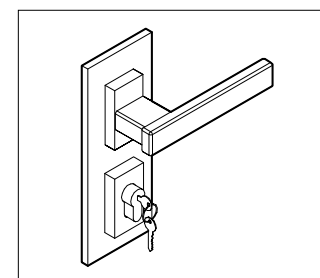

MCQ

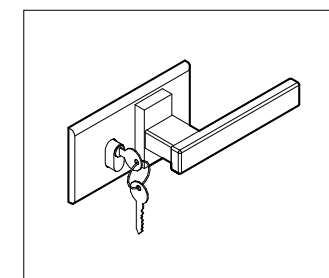

MCQO

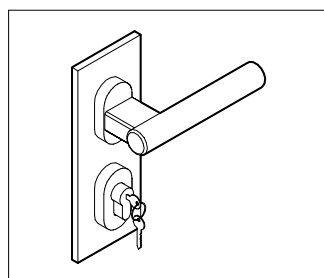

MCT

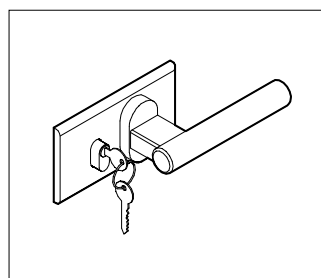

MCTO

ANTA VETRO TEMPERATO_CERNIERA CONTINUA ANODIZZATA sp. 10 mm

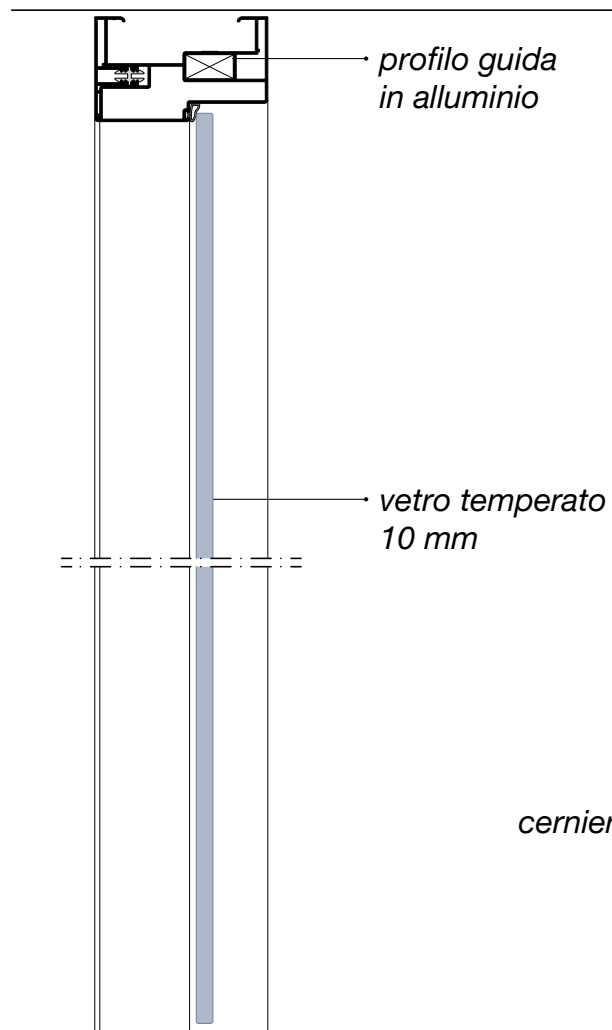
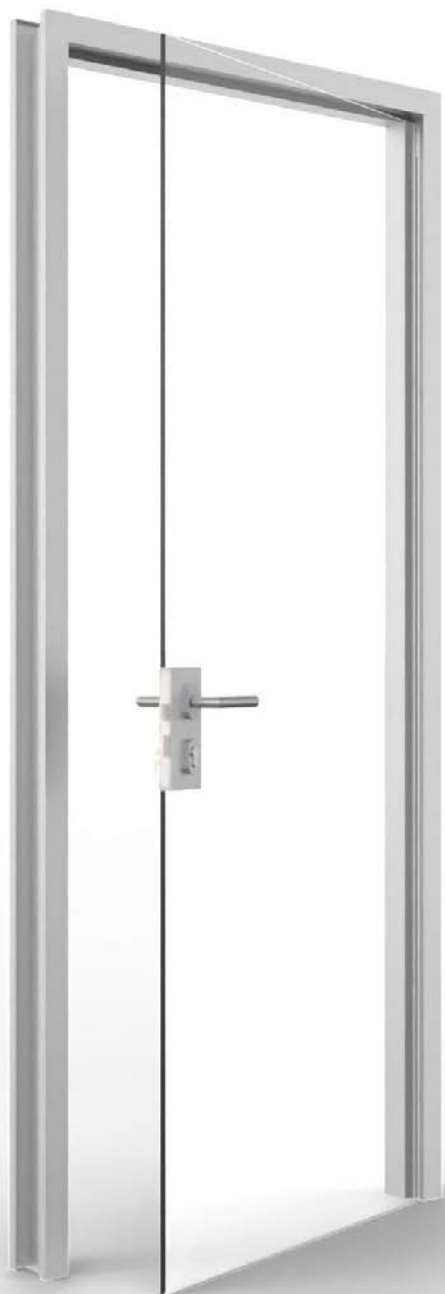

CARATTERISTICHE

- 01.** cerniera continua - 180°
- 02.** chiudiporta a vista
- 03.** maniglia con adattatore per vetro
- 04.** interruttore su montante porta
- 05.** ghigliottina esterna

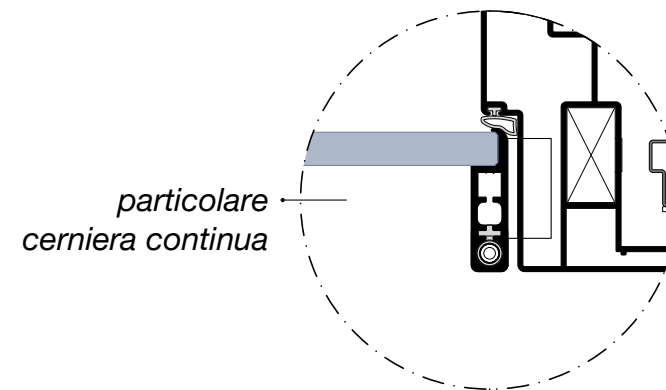

particolare
cerniera continua

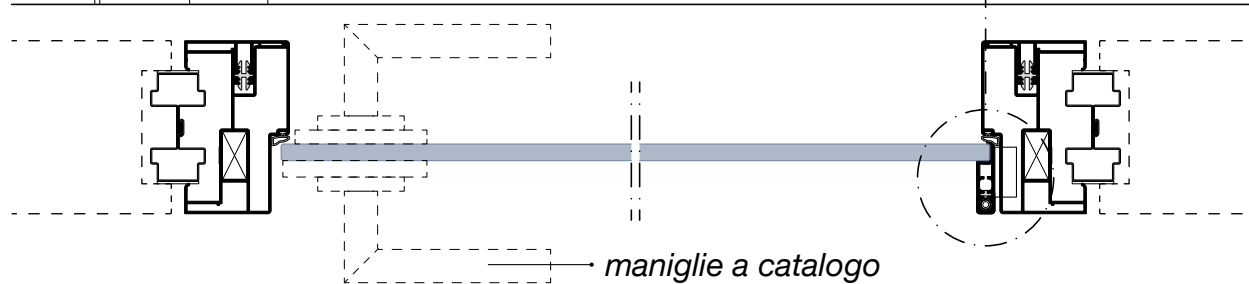

ANTA VETRO TEMPERATO_CERNIERA CONTINUA ANODIZZATA sp. 10 mm

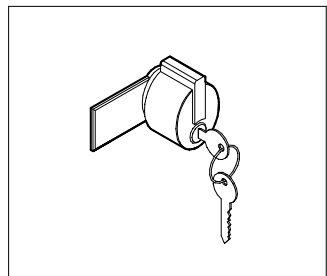

MC1

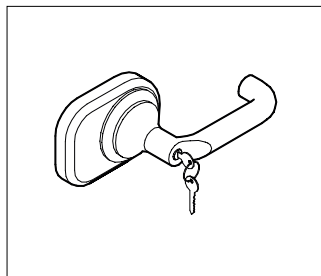

MC4

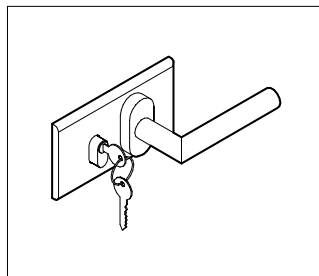

MC5

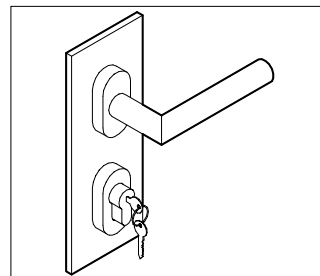

MC5V

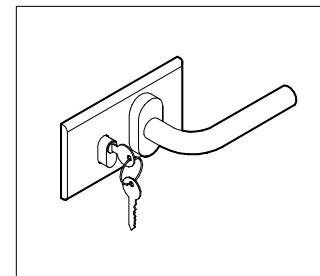

MC6

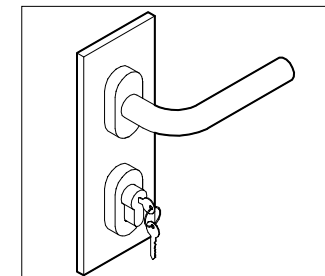

MC6V

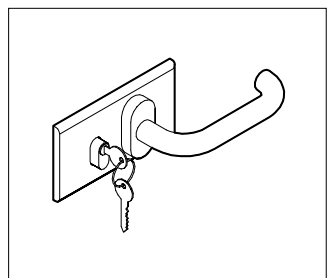

MC7

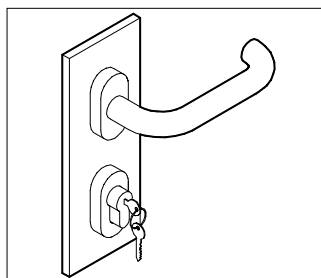

MC7V

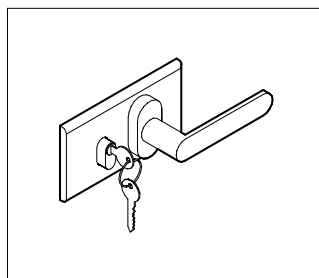

MC8

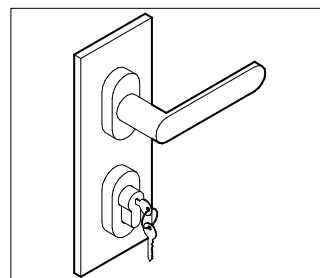

MC8V

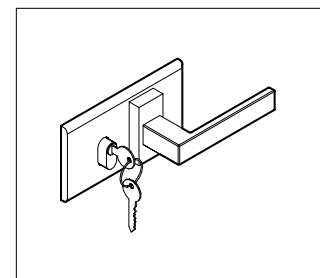

MC9

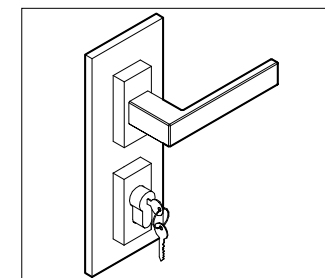

MC9V

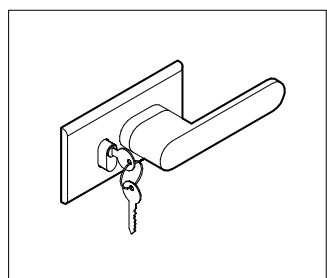

MC10

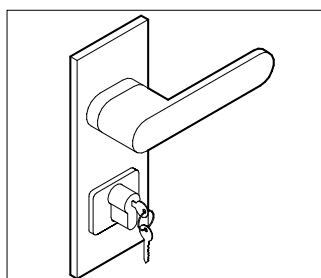

MC10V

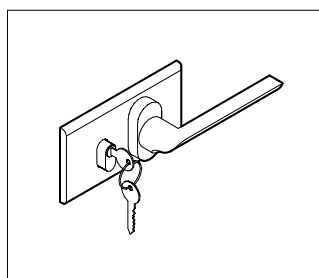

MC11

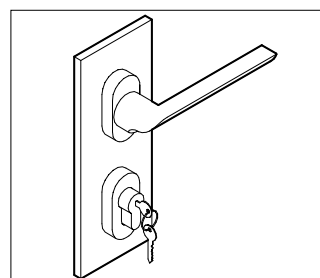

MC11V

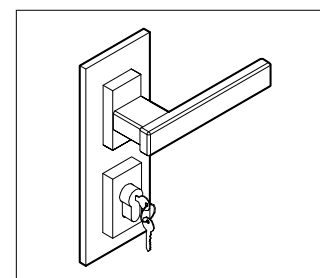

MCQ

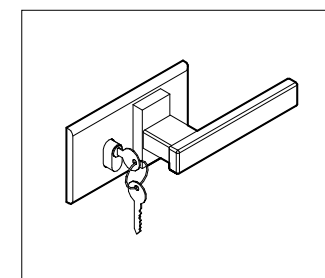

MCQO

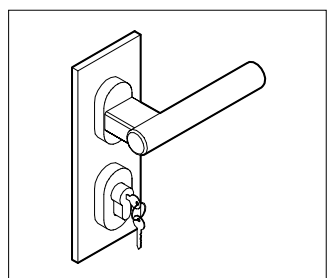

MCT

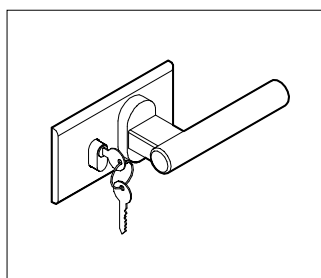

MCTO

ANTA INTELAIATA GRANDE CON PANNELLO sp. 43 mm

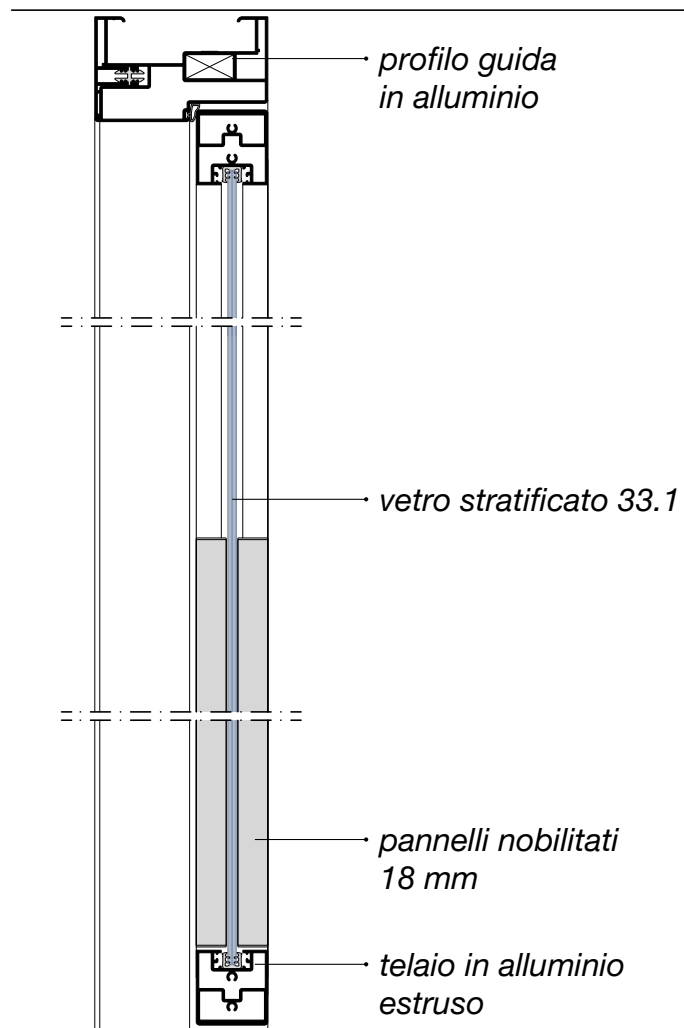

CARATTERISTICHE

- 01.** cerniere a vista o a scomparsa
- 02.** chiudiporta a vista
- 03.** interruttore su montante porta
- 04.** ghigliottina incassata

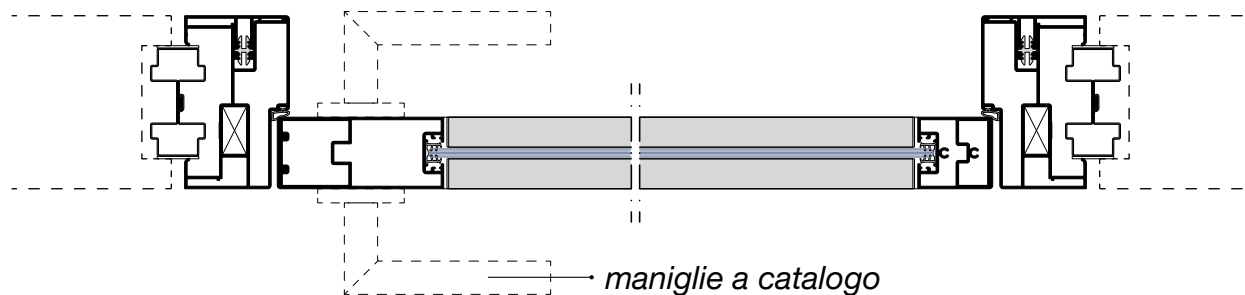

ANTA INTELAIATA GRANDE CON PANNELLO sp. 43 mm

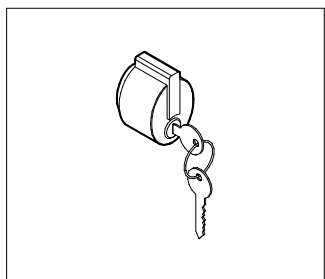

ML1

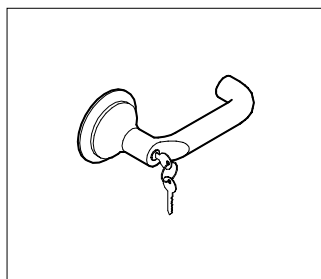

ML4

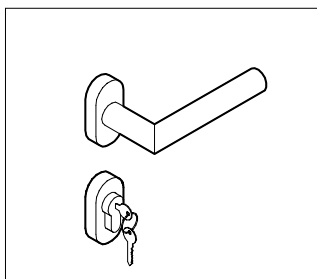

ML5

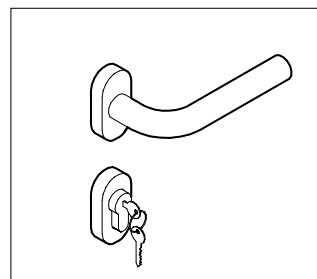

ML6

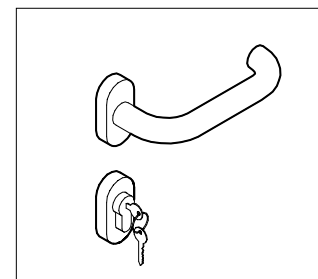

ML7

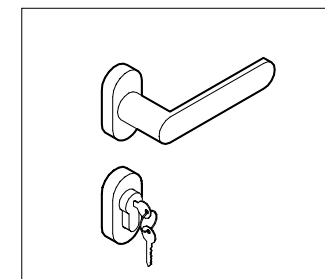

ML8

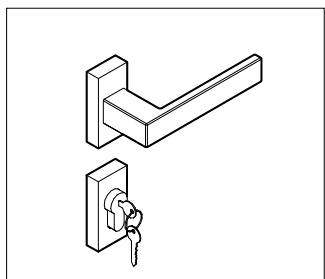

ML9

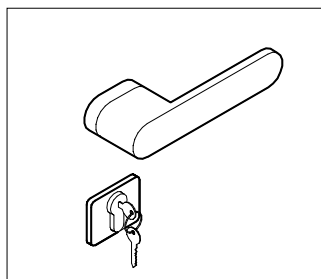

ML10

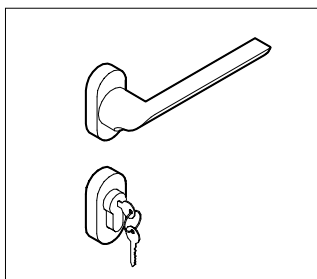

ML11

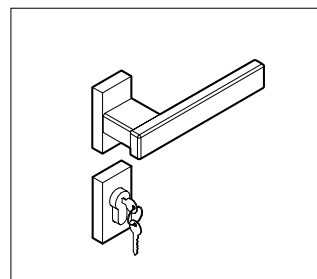

MLQ

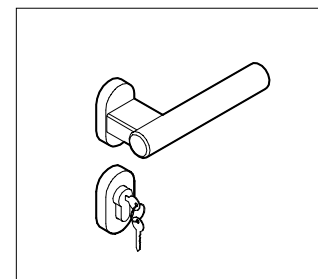

MLT

ANTA INTELAIATA GRANDE sp. 43 mm

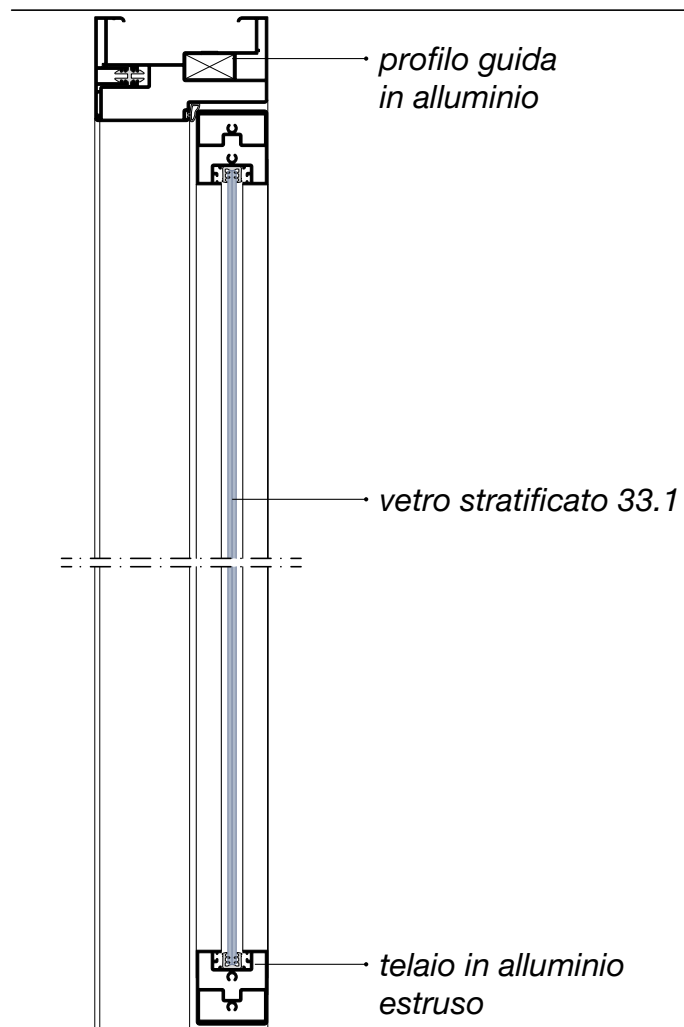

CARATTERISTICHE

- 01. cerniere a vista o a scomparsa
- 02. chiudiporta a vista
- 03. interruttore su montante porta
- 04. ghigliottina incassata

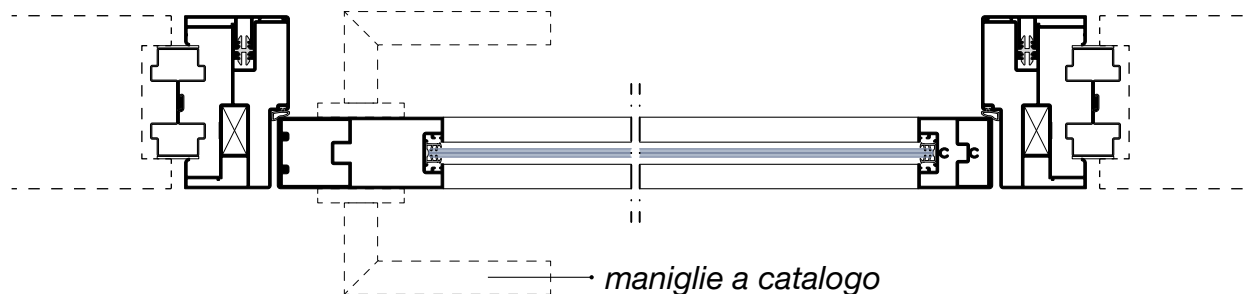

ANTA INTELAIATA GRANDE sp. 43 mm

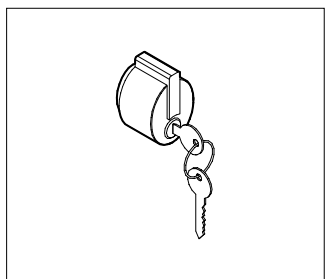

ML1

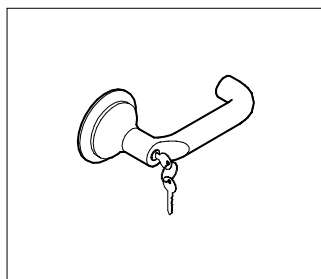

ML4

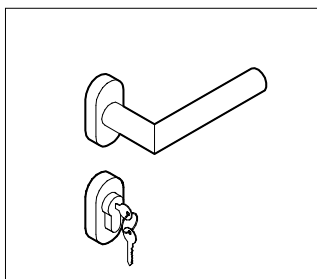

ML5

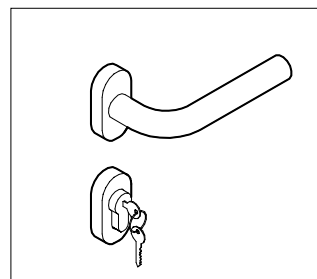

ML6

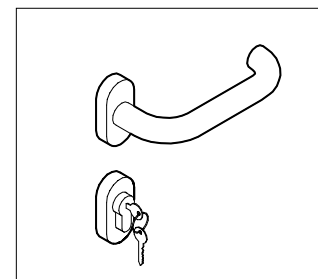

ML7

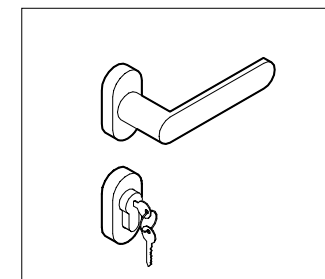

ML8

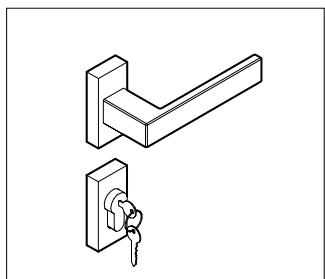

ML9

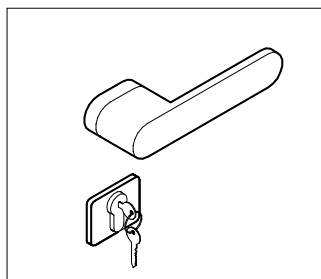

ML10

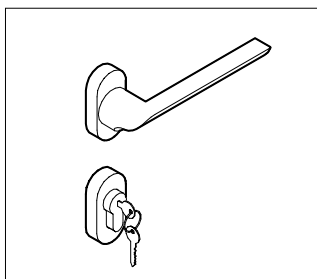

ML11

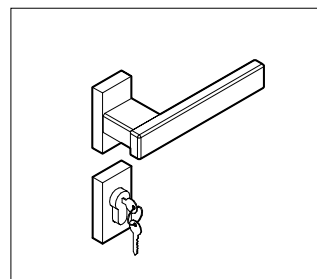

MLQ

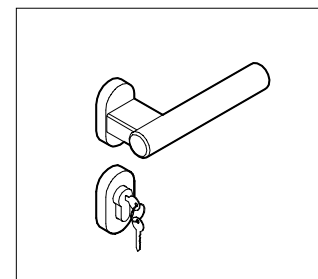

MLT

ANTA INTELAIATA MEDIA sp. 43 mm

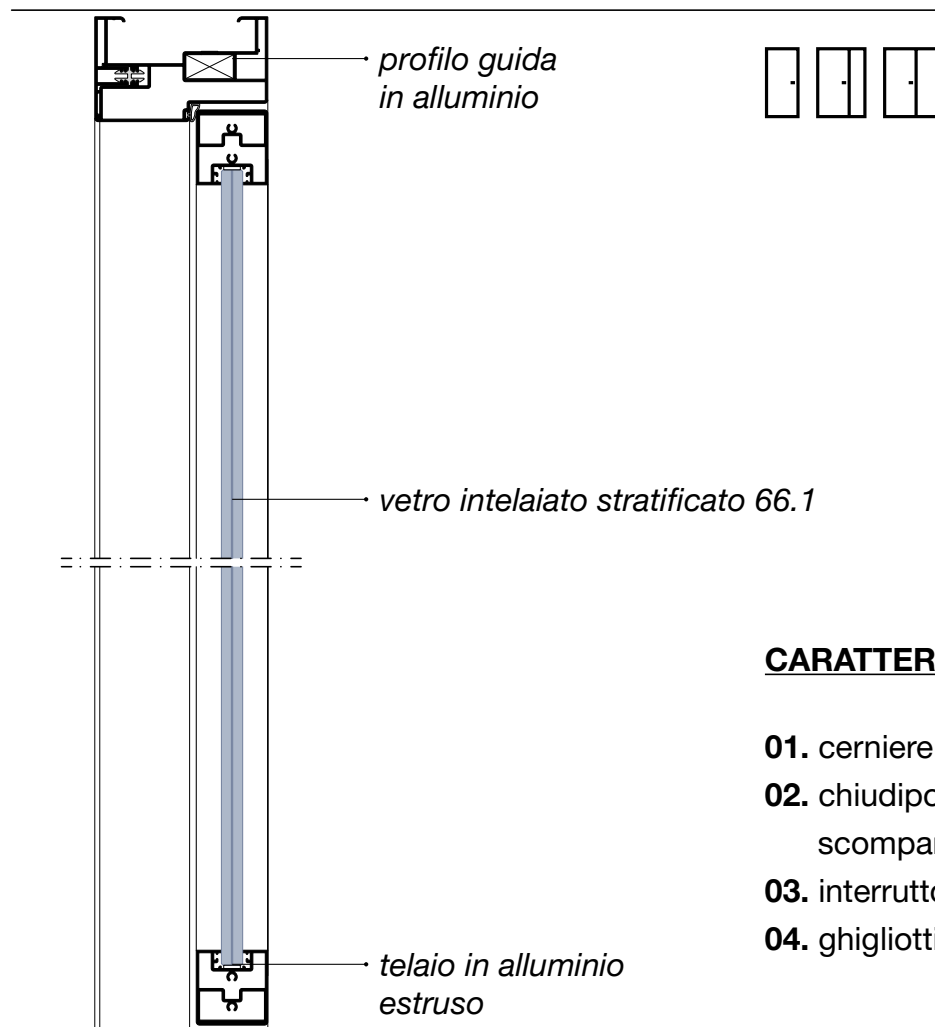

CARATTERISTICHE

- 01. cerniere a vista o a scomparsa
- 02. chiudiporta a vista o a scomparsa
- 03. interruttore su montante porta
- 04. ghigliottina incassata

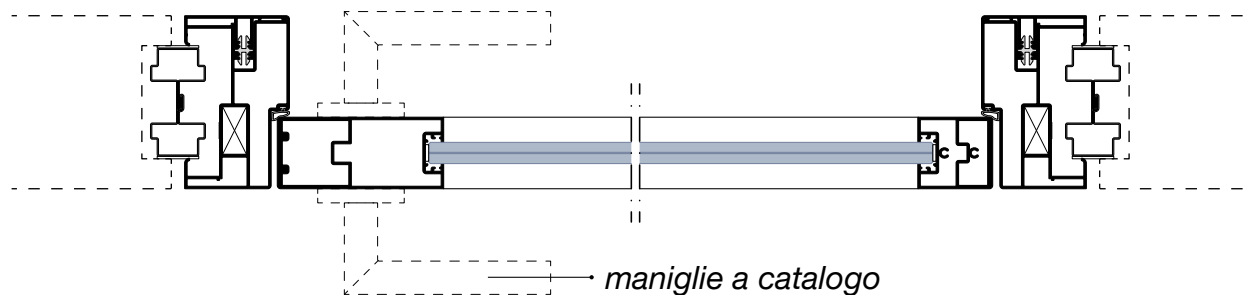

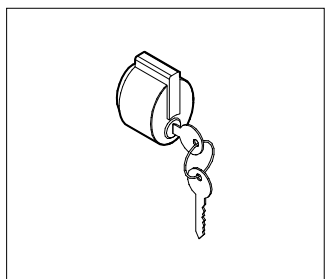

ML1

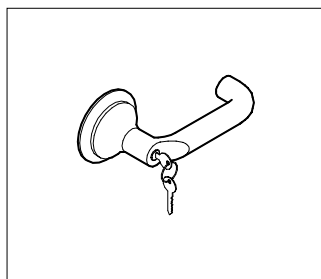

ML4

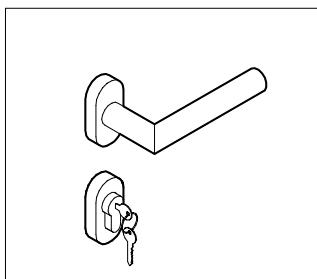

ML5

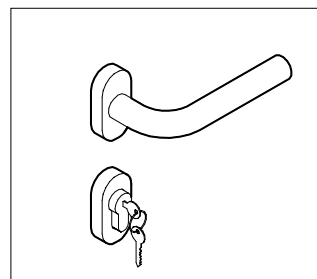

ML6

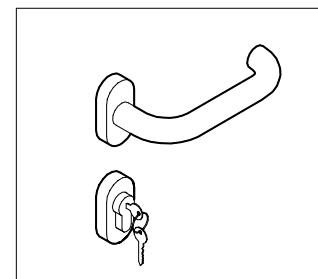

ML7

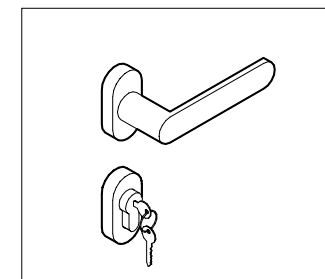

ML8

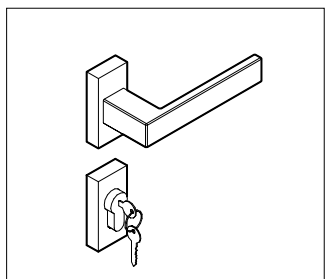

ML9

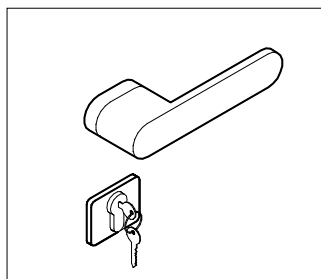

ML10

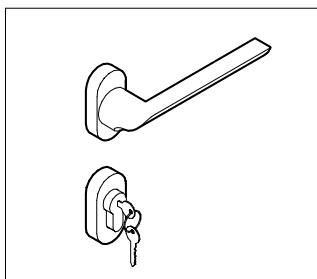

ML11

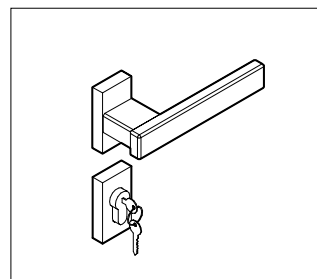

MLQ

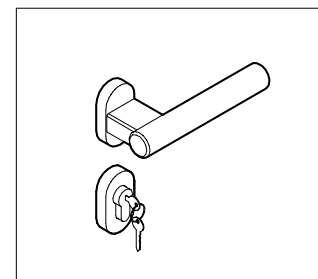

MLT

ANTA INTELAIATA SOTTILE sp. 43 mm

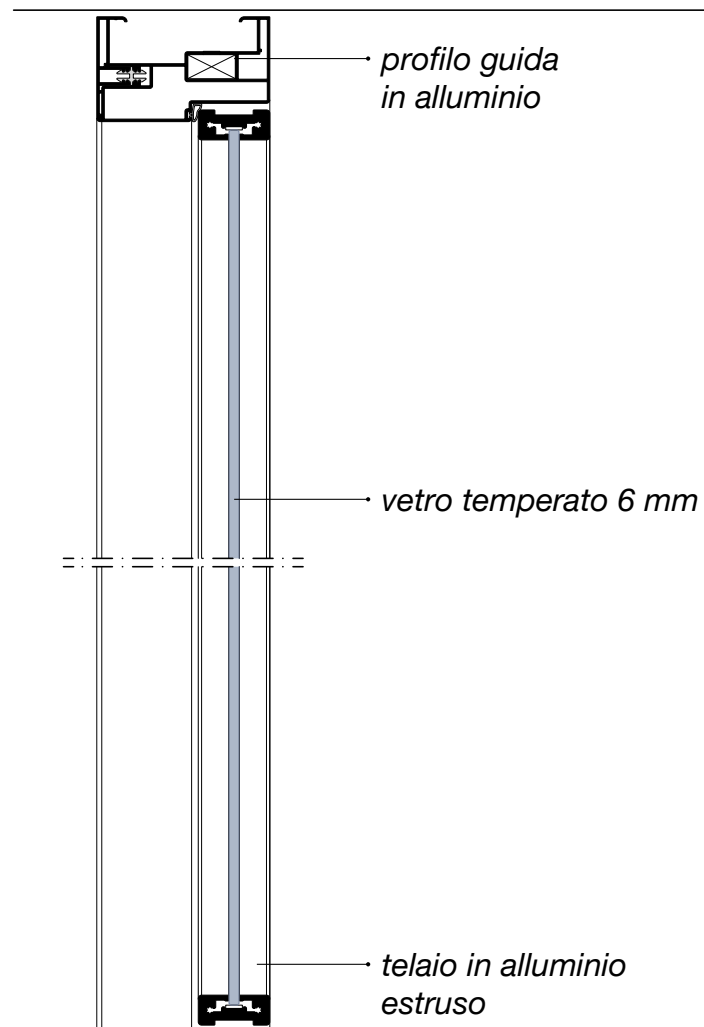

CARATTERISTICHE

- 01. cerniere a vista
- 02. chiudiporta a vista
- 03. maniglia con adattatore per vetro
- 04. interruttore su montante porta

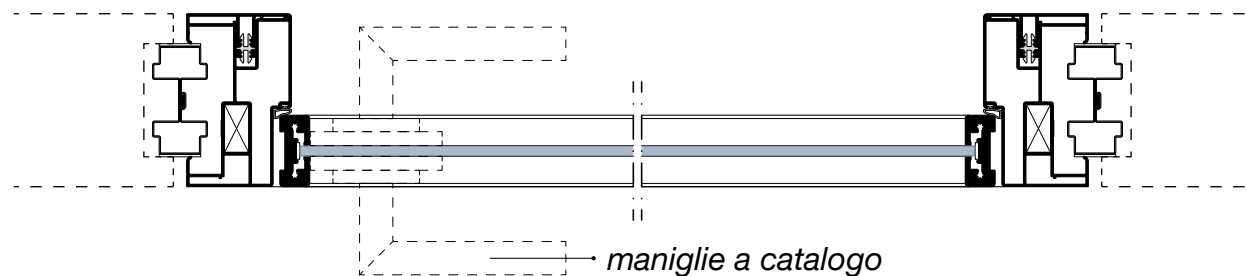

ANTA INTELAIATA SOTTILE sp. 43 mm

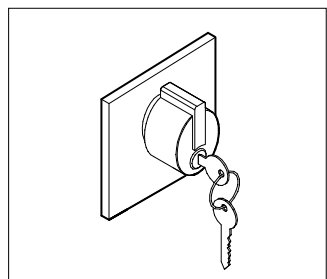

ML1

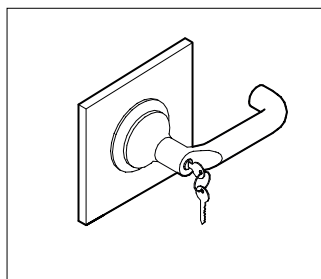

ML4

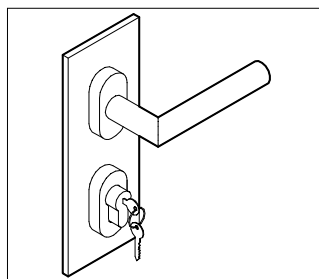

ML5

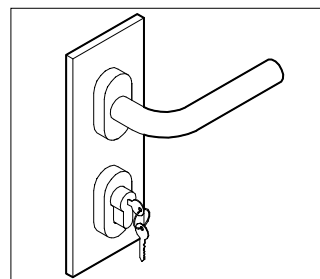

ML6

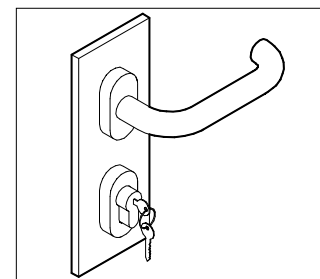

ML7

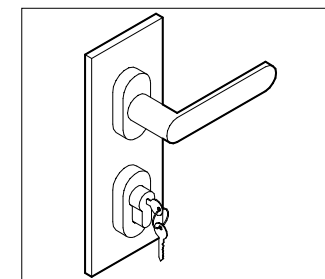

ML8

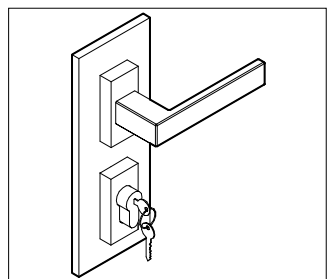

ML9

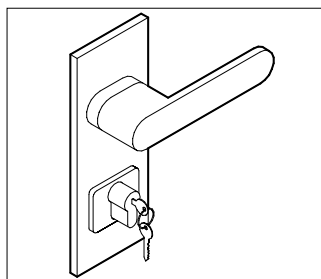

ML10

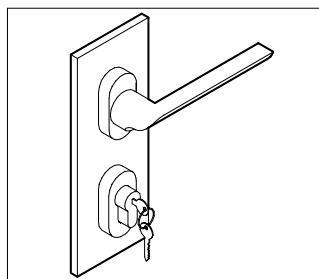

ML11

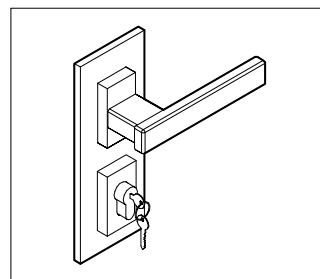

MLQ

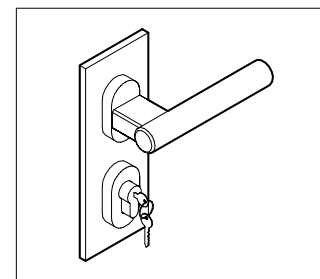

MLT

ANTA INTELAIATA VETRO DOPPIO sp. 51 mm

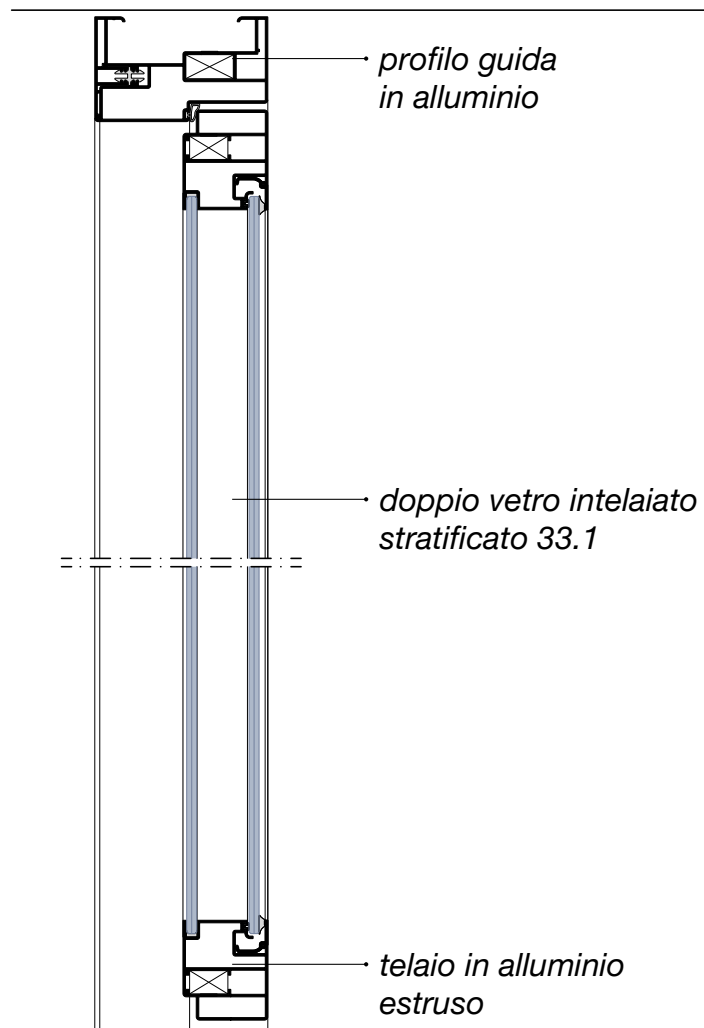

CARATTERISTICHE

- 01.** cerniere a scomparsa
- 02.** chiudiporta a vista o a scomparsa
- 03.** interruttore su montante porta
- 05.** ghigliottina acustica

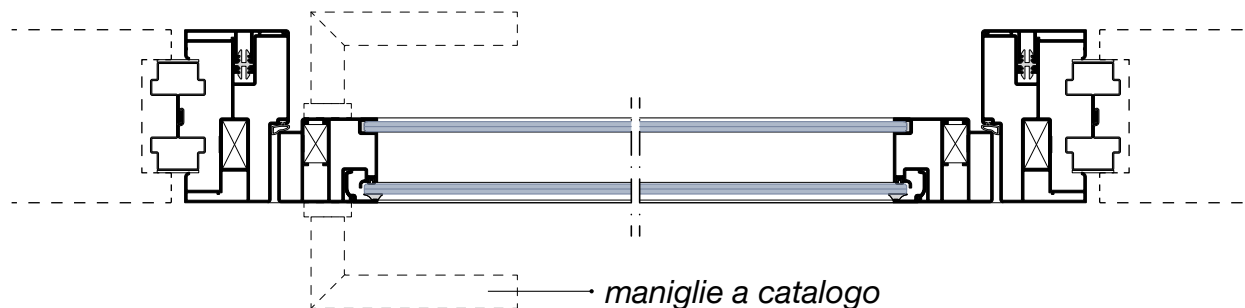

ANTA INTELAIATA VETRO DOPPIO sp. 51 mm

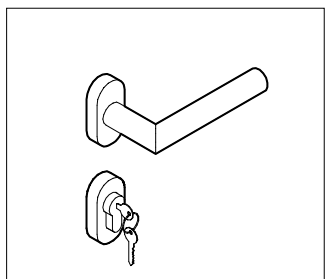

ML5

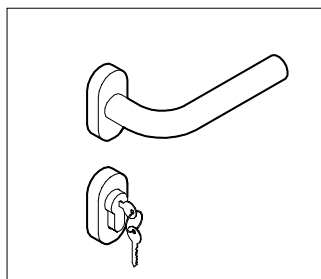

ML6

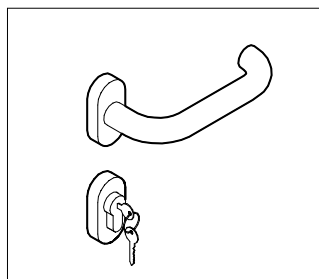

ML7

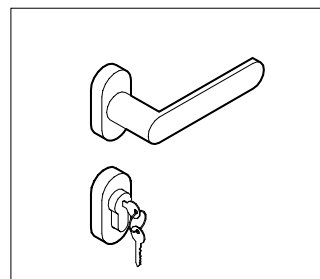

ML8

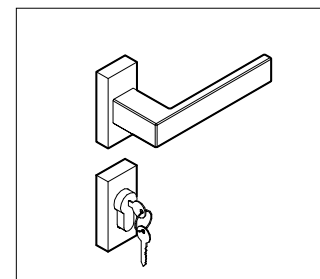

ML9

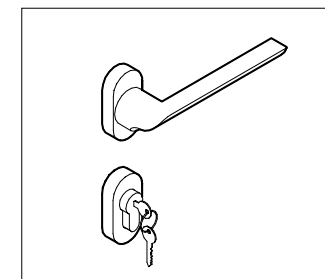

ML11

ANTA INTELAIATA CIECA sp. 104 mm

Porta complanare

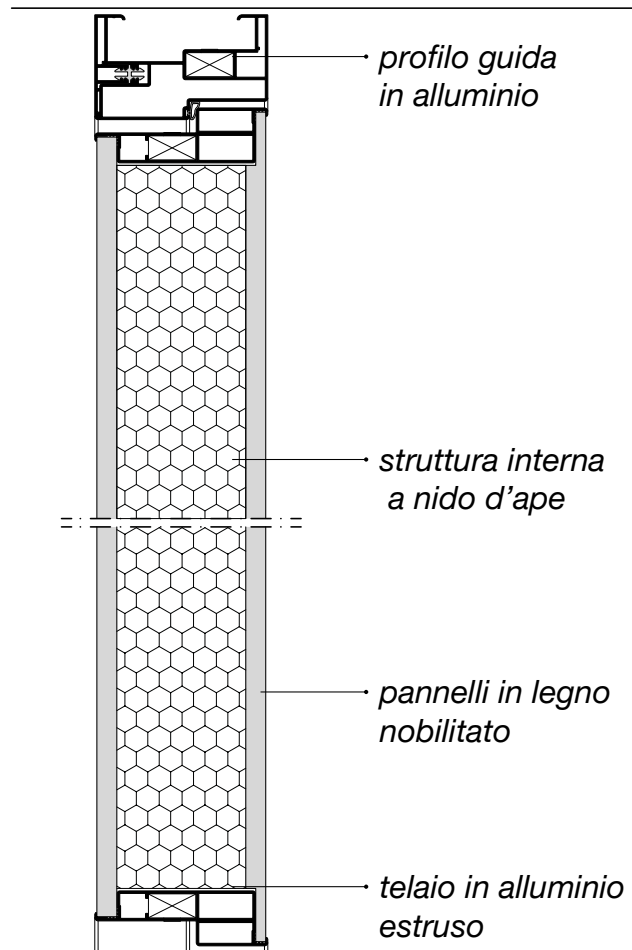

CARATTERISTICHE

- 01.** cerniere a scomparsa
- 02.** chiudiporta a vista o a scomparsa
- 03.** interruttore su montante porta
- 04.** ghigliottina incassata

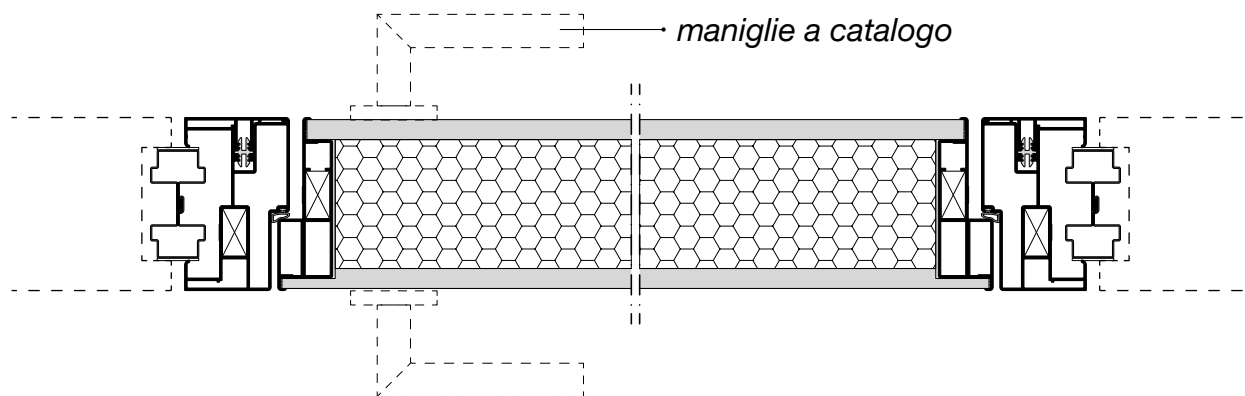

ANTA INTELAIATA CIECA sp. 104 mm

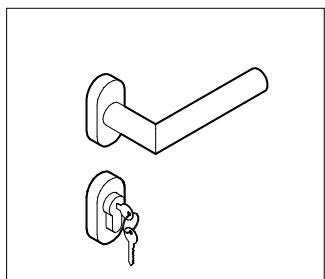

ML5

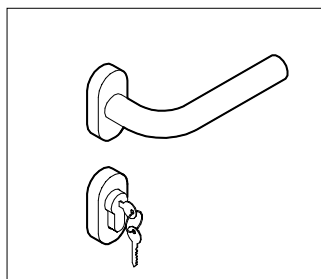

ML6

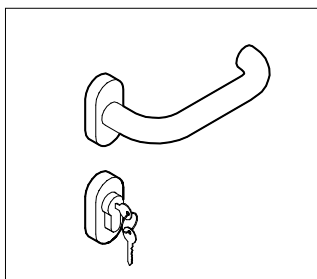

ML7

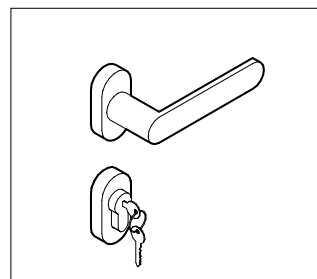

ML8

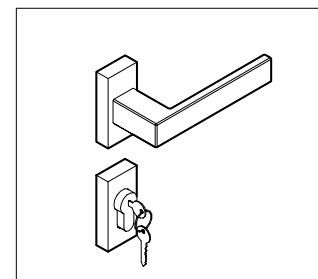

ML9

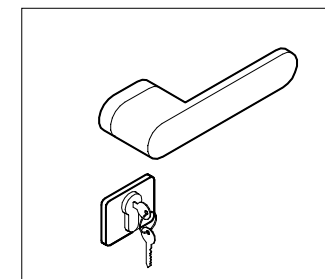

ML10

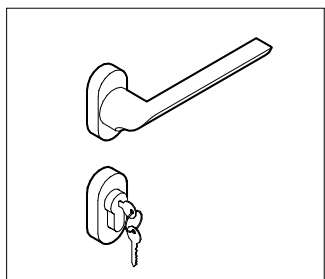

ML11

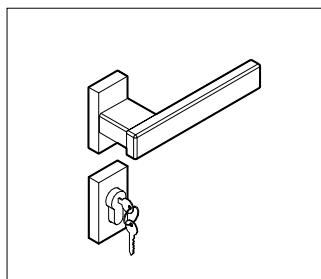

MLQ

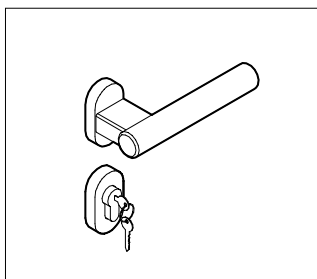

MLT

ANTA INTELAIATA VETRO DOPPIO sp. 104 mm

Porta complanare

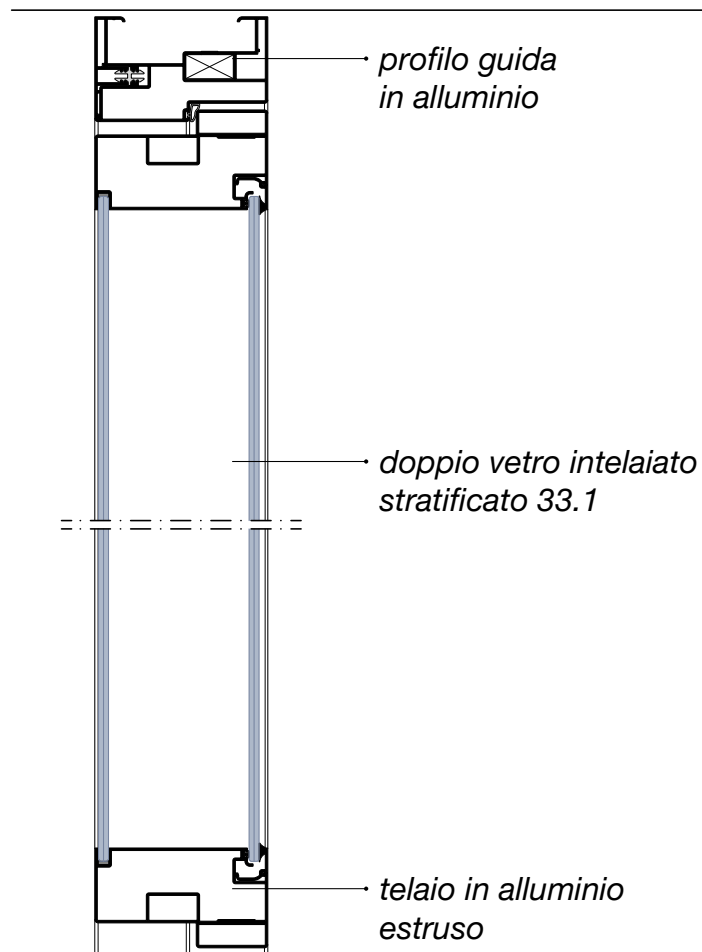

CARATTERISTICHE

- 01.** cerniere a scomparsa
- 02.** chiudiporta a vista o a scomparsa
- 03.** interruttore su montante porta
- 04.** ghigliottina incassata

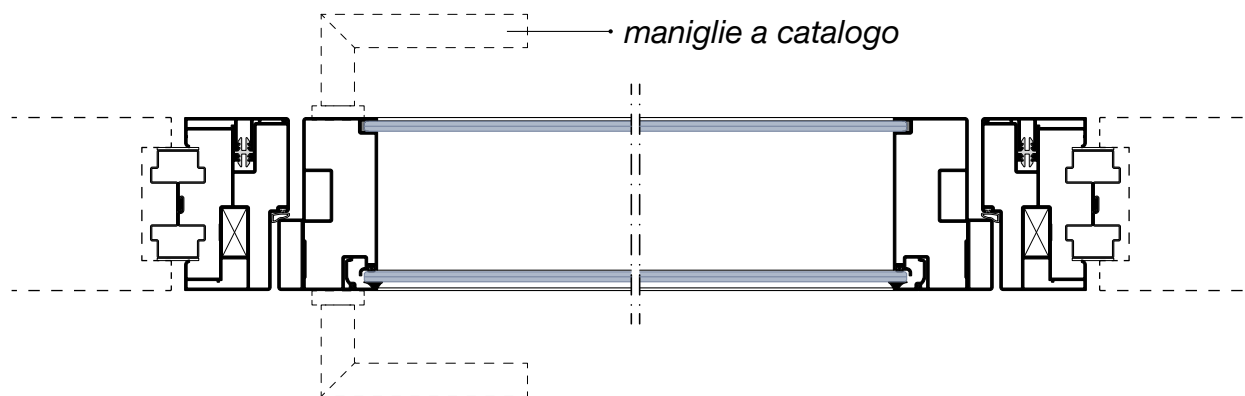

ANTA INTELAIATA VETRO DOPPIO sp. 104 mm

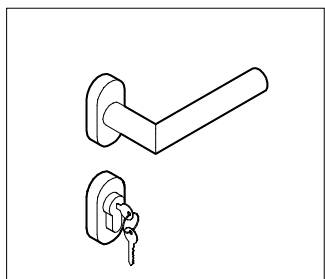

ML5

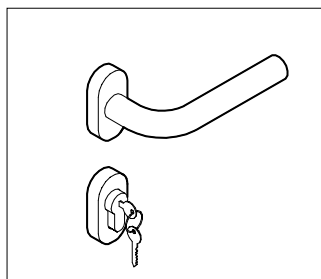

ML6

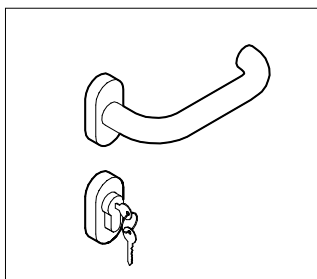

ML7

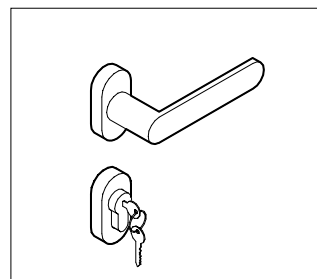

ML8

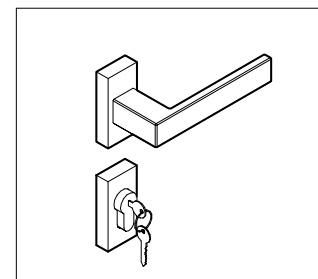

ML9

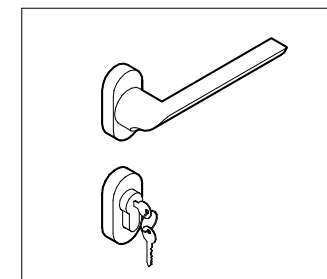

ML11

TELAI PORTE SCORREVOLI



Telaio porta su **Metrica R**

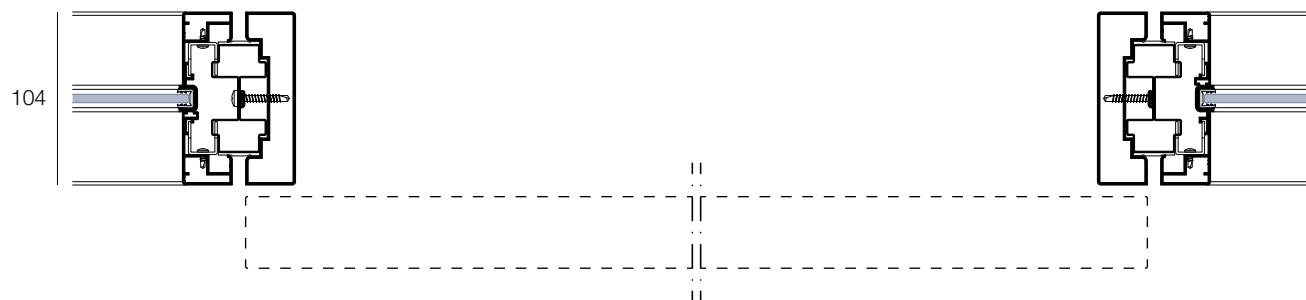

Telaio porta su **Metrica V**

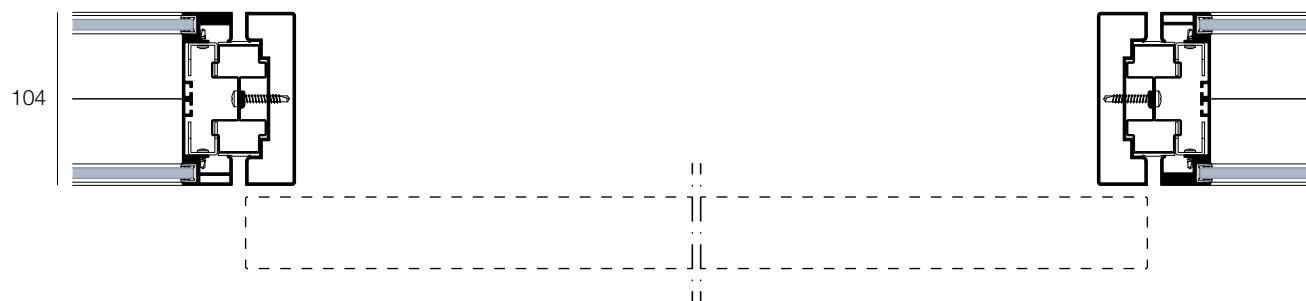

Telaio porta su **Metrica S**

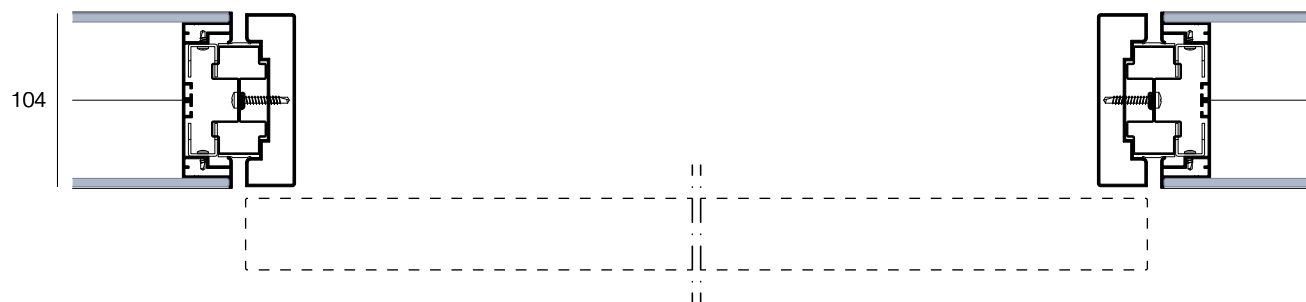

Telaio porta su **Metrica Solid**

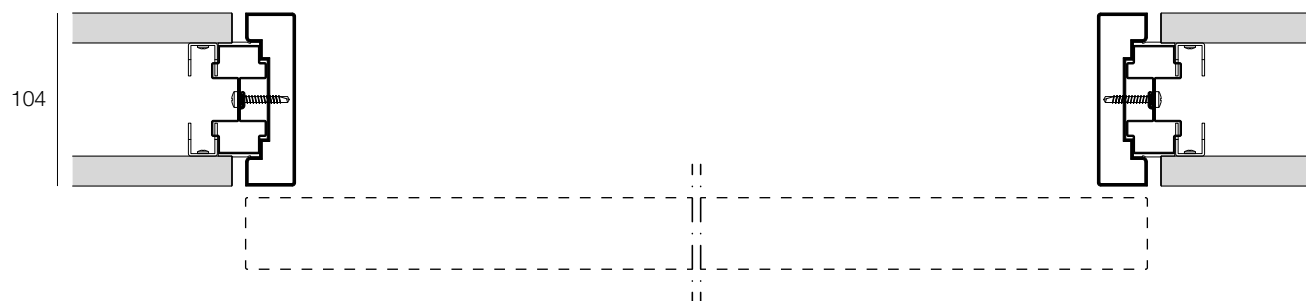

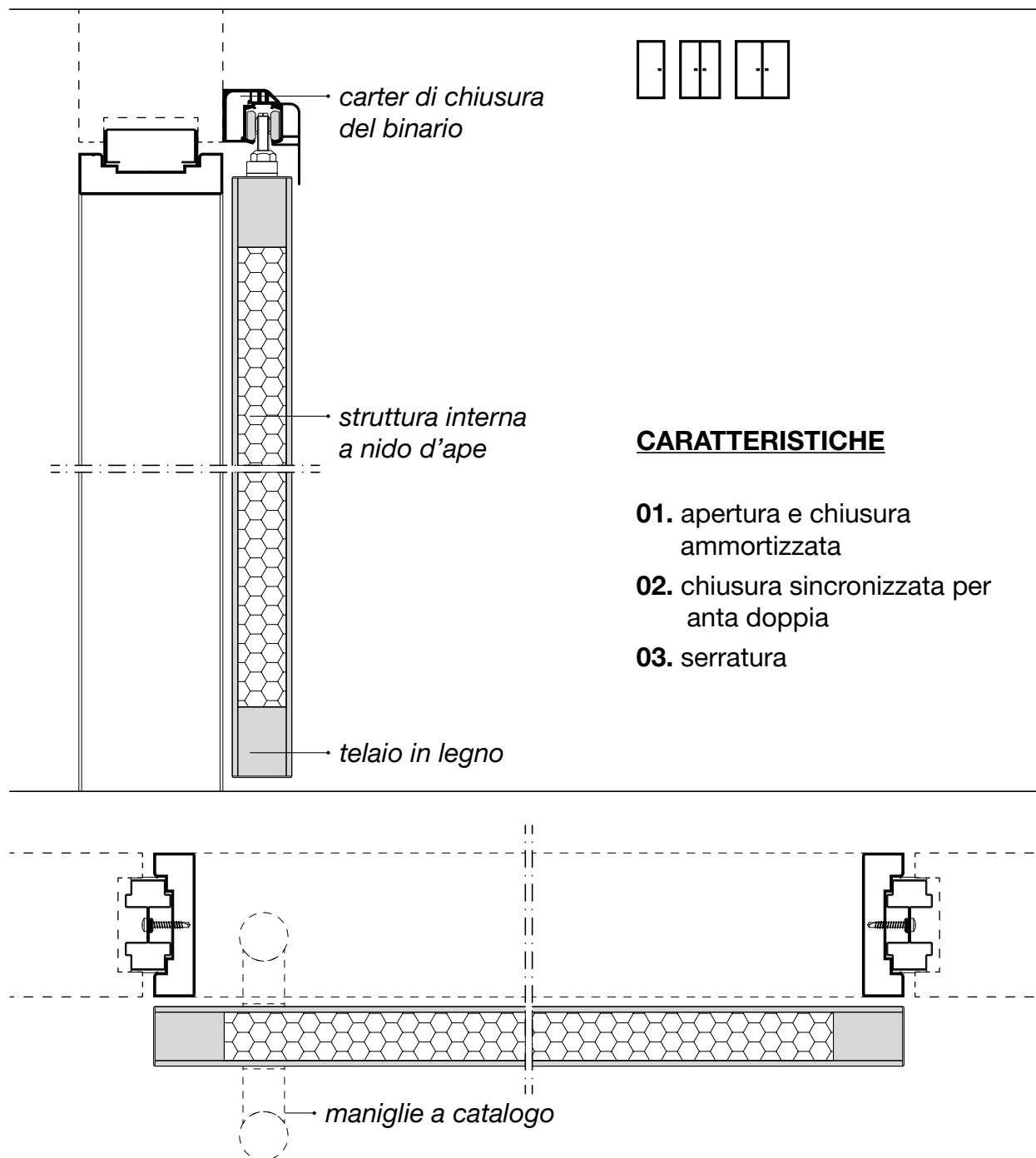

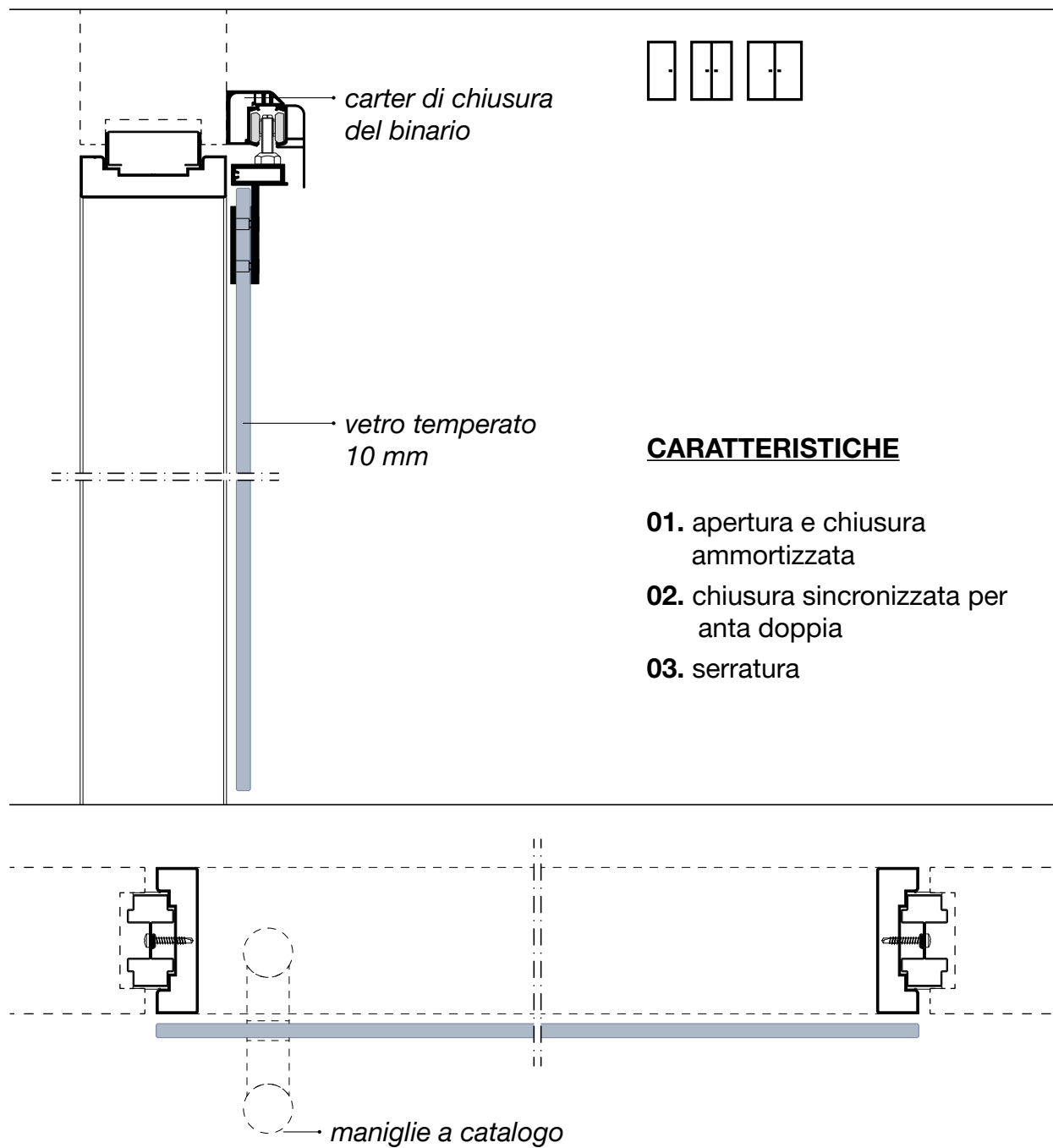

ANTA INTELAIATA GRANDE sp. 43 mm

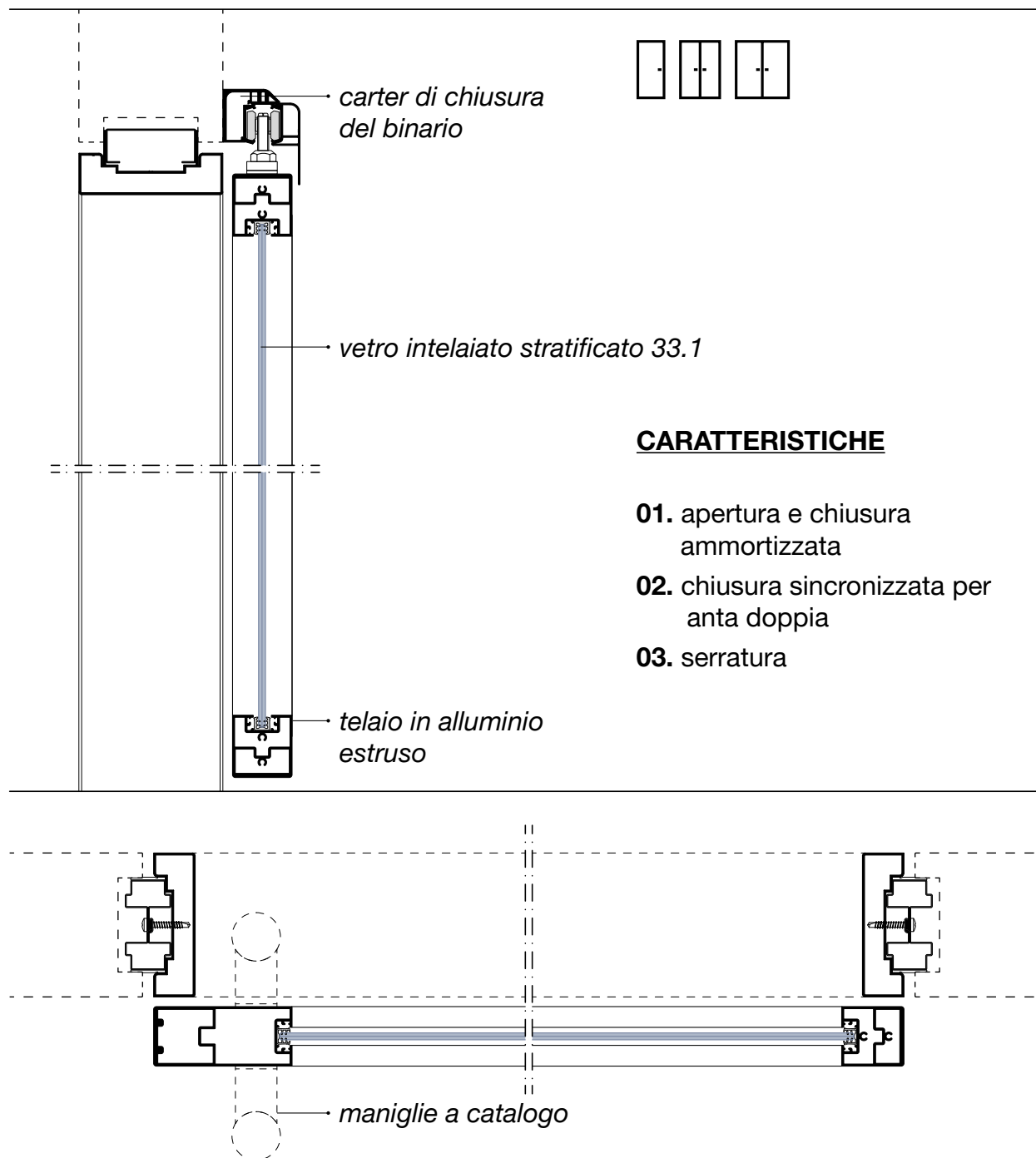

ANTA INTELAIATA MEDIA sp. 43 mm

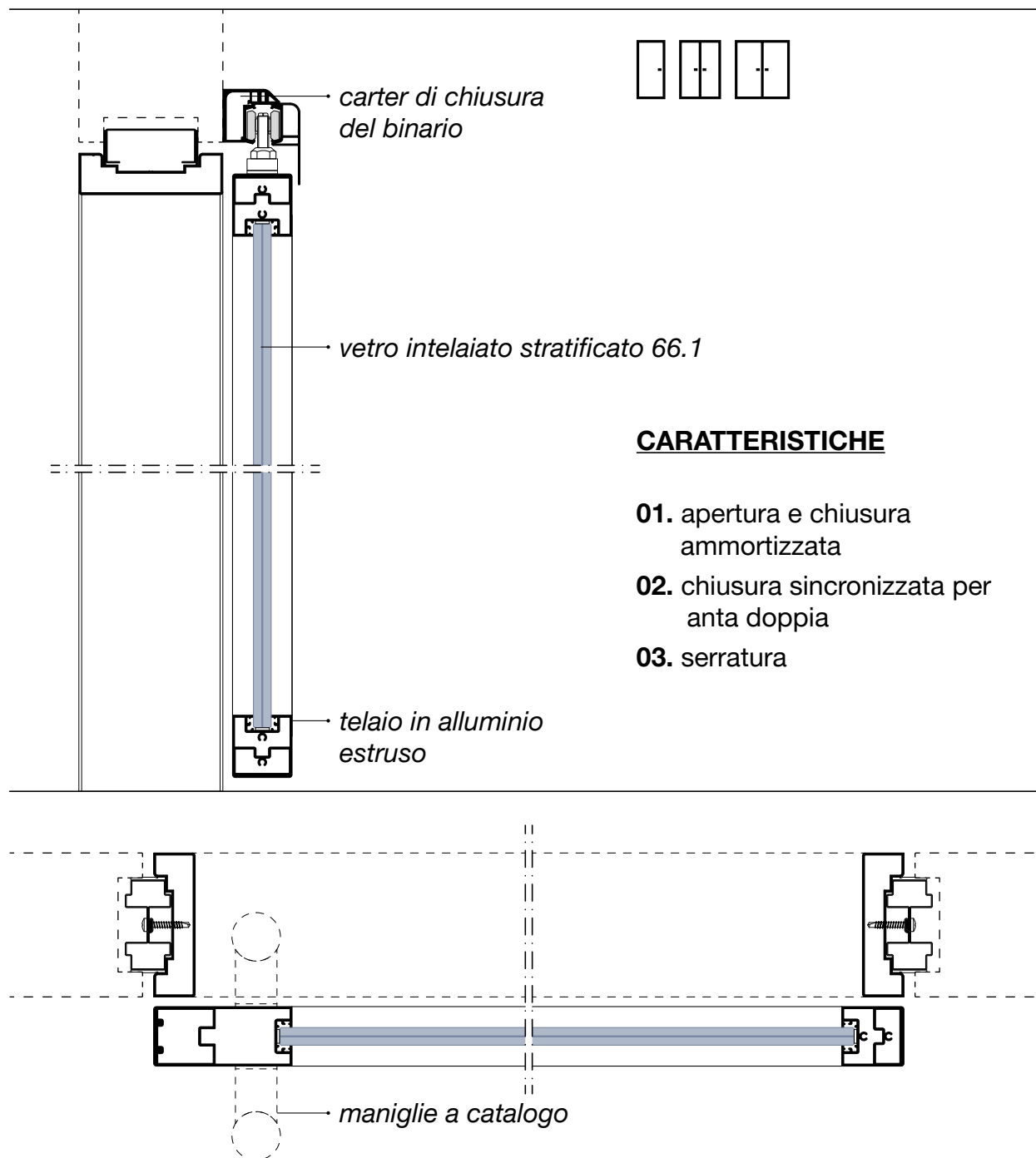

ANTA INTELAIATA SOTTILE sp. 43 mm

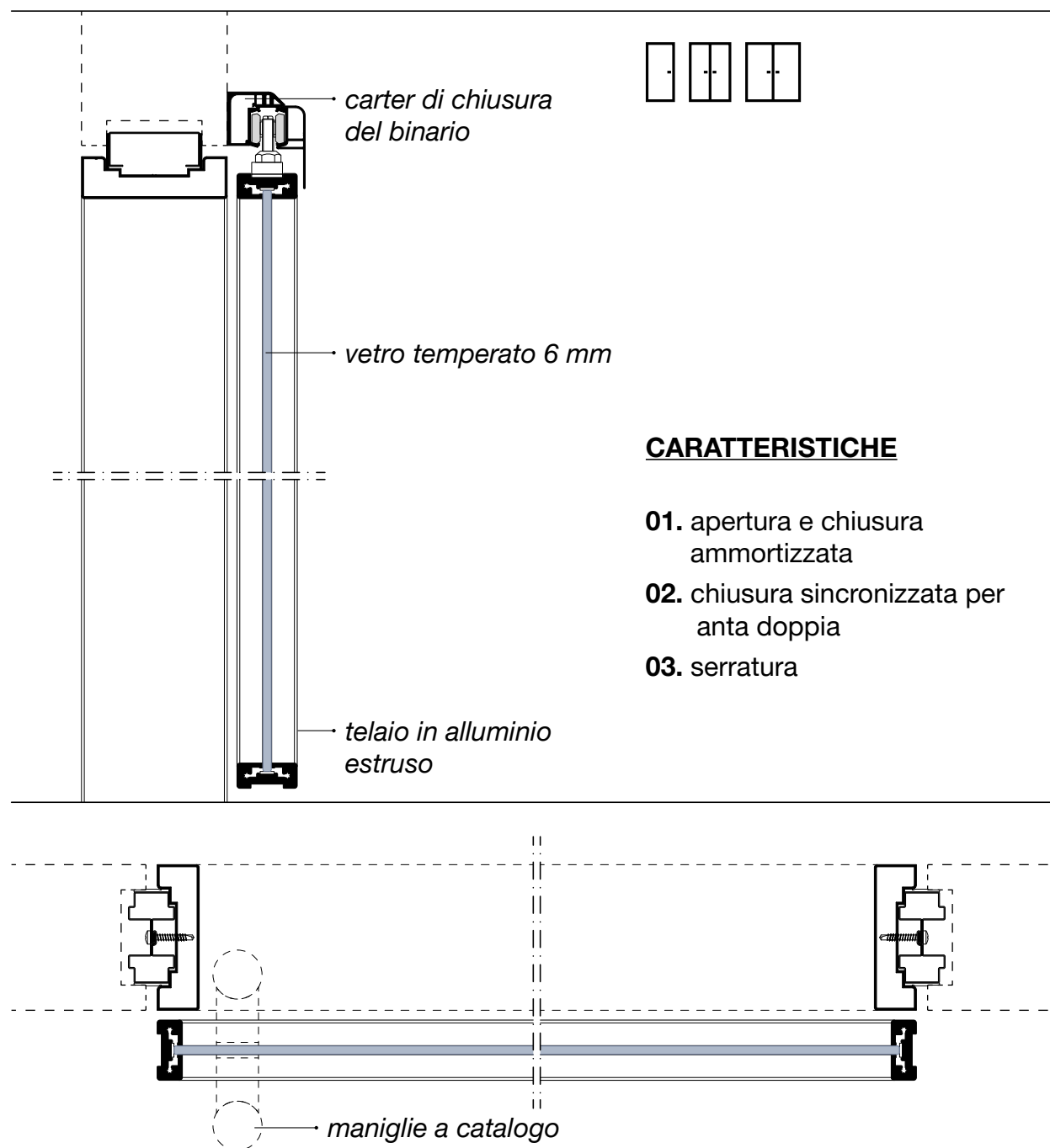

ANTA CIECA_SCORREVOLE INTERNA sp. 38 mm

*solo per Metrica Solid

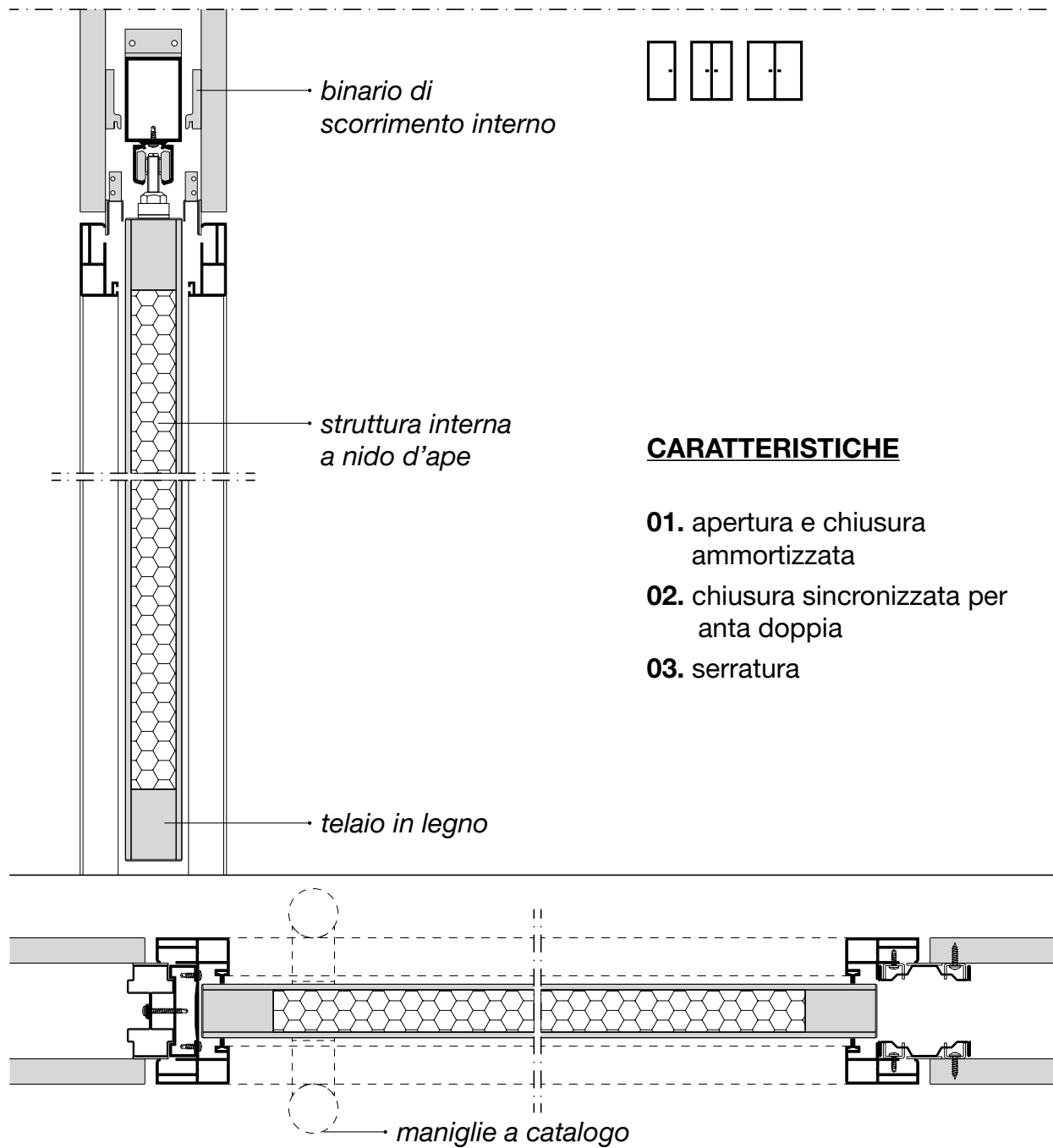

ANTA VETRO TEMPERATO_SCORREVOLE INTERNA sp. 10 mm

*solo per Metrica Solid

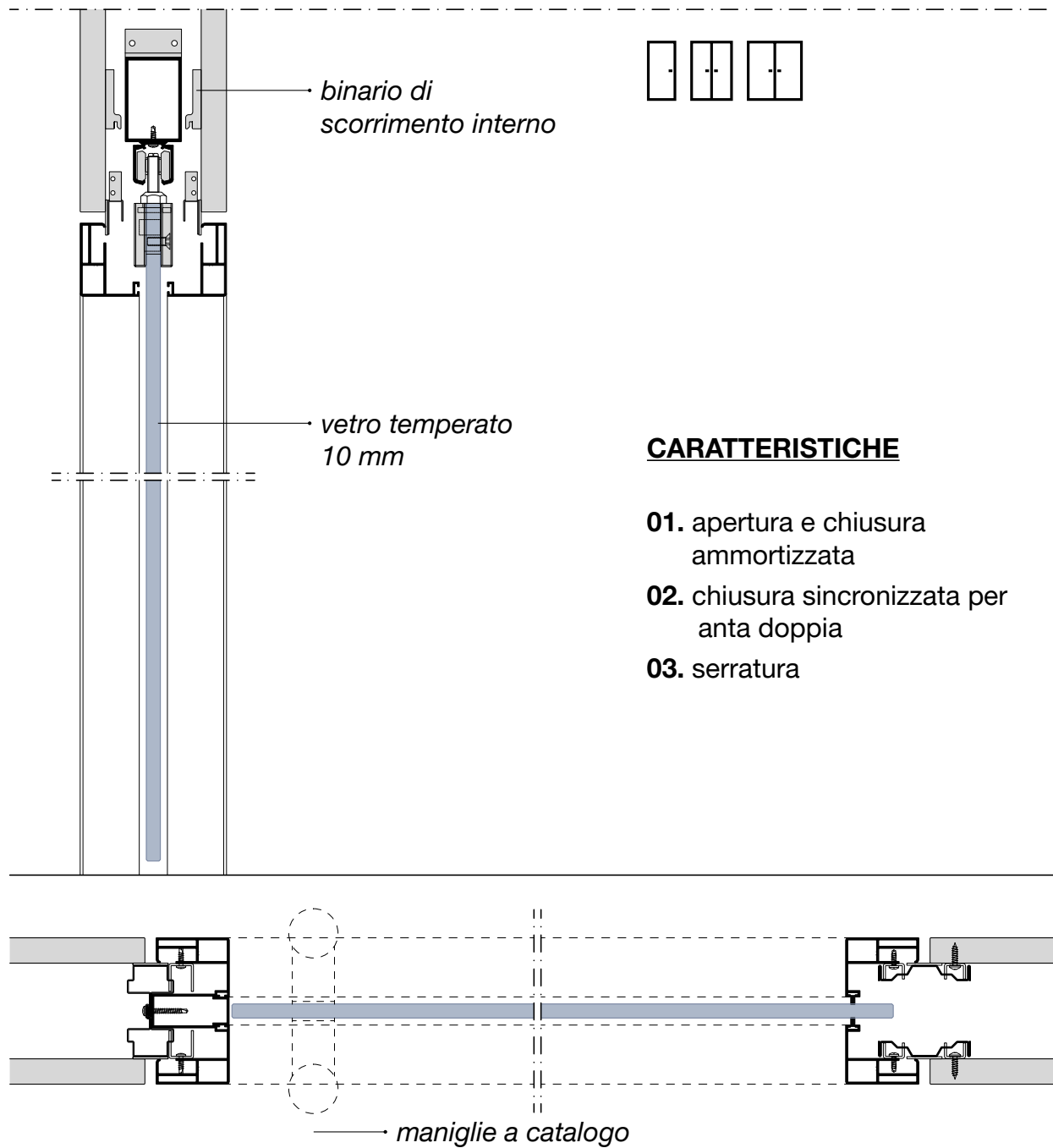

Porte in vetro



ACCIAIO

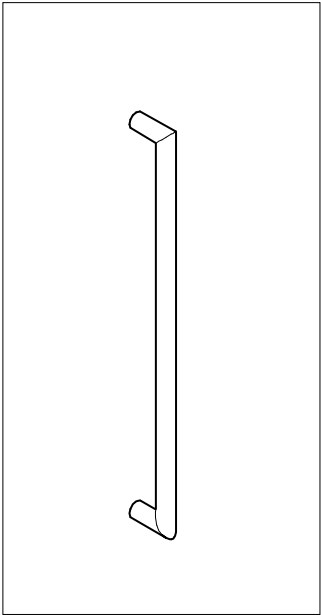

MPOMGH1_H2_H3

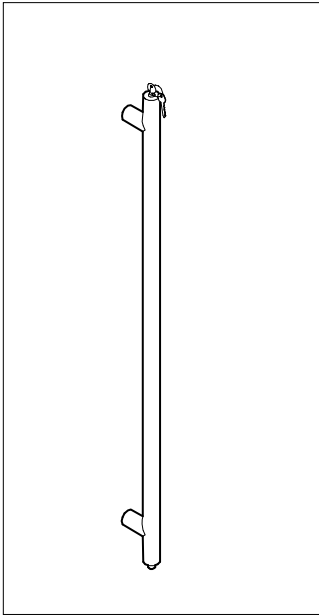

MPOM2

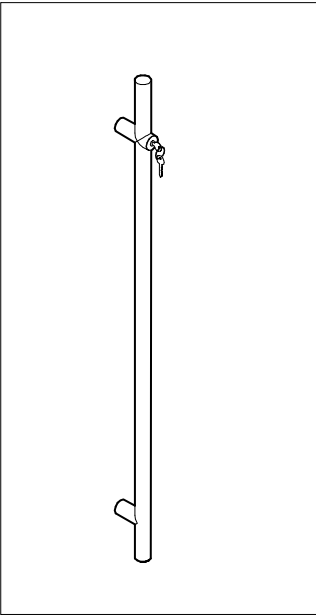

MPOM3

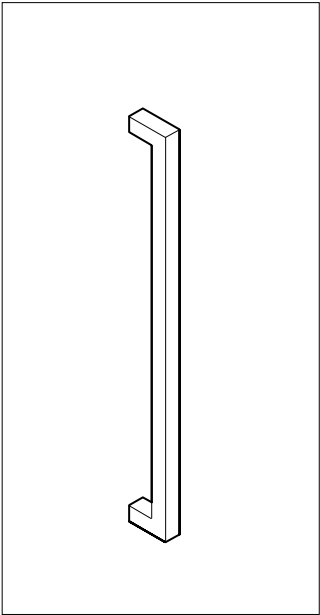

MPOMGH1Q_GH2Q_GH3Q MPOM3Q

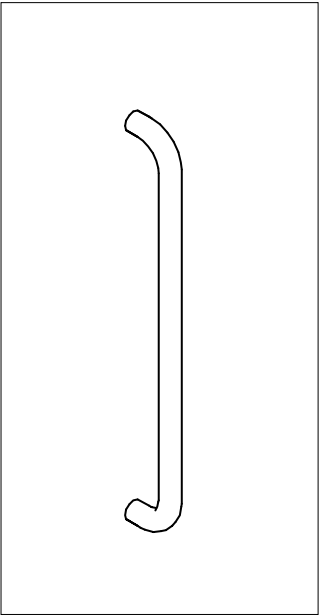
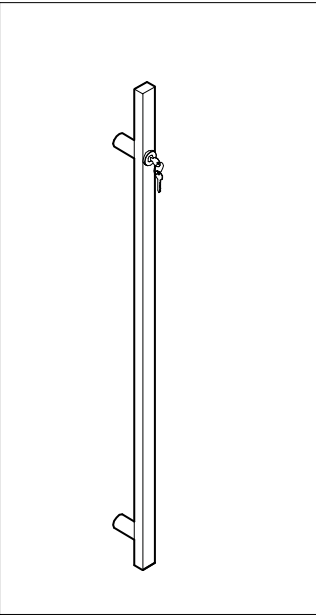

MPOM8

ALLUMINIO

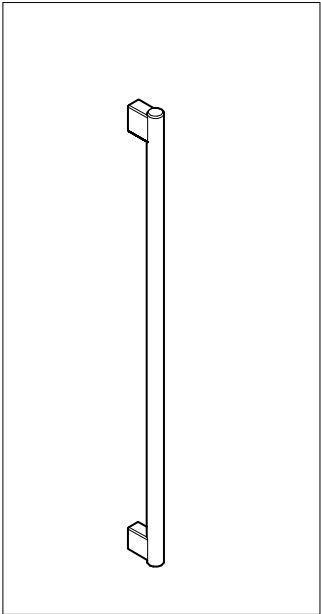

MPOMTH1_TH2

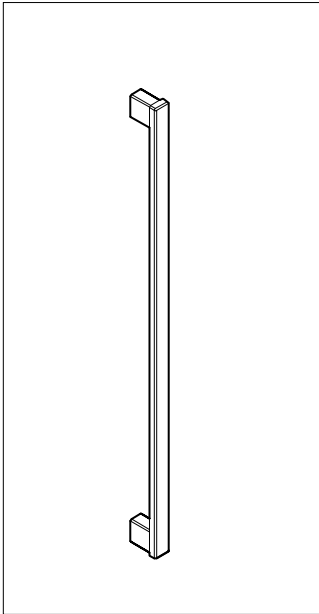

MPOMQH1_QH2

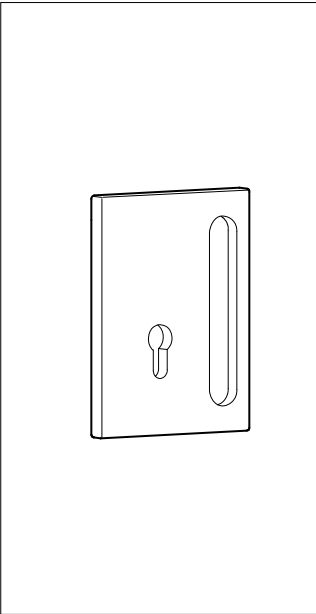

MPOM6

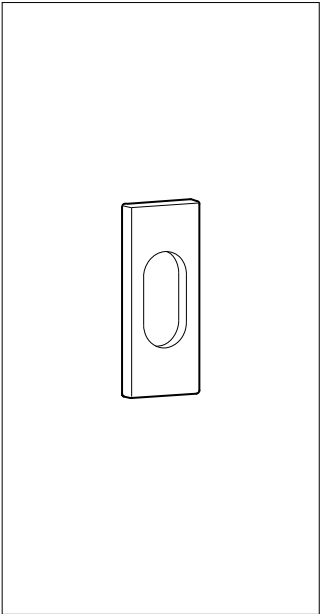

MPOM7

Porte cieche



ACCIAIO

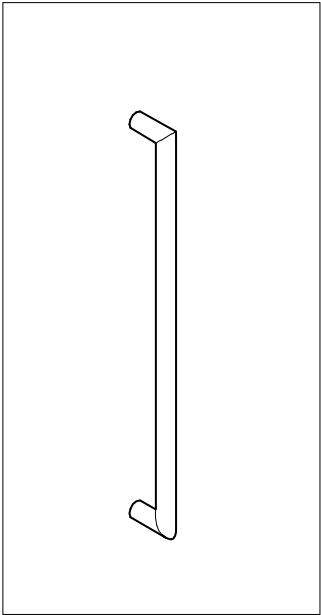

MPOMGH1_H2_H3

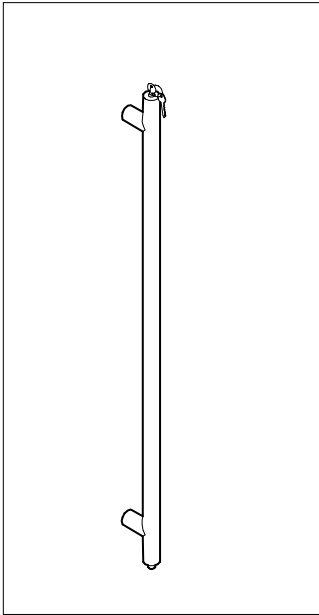

MPOM2

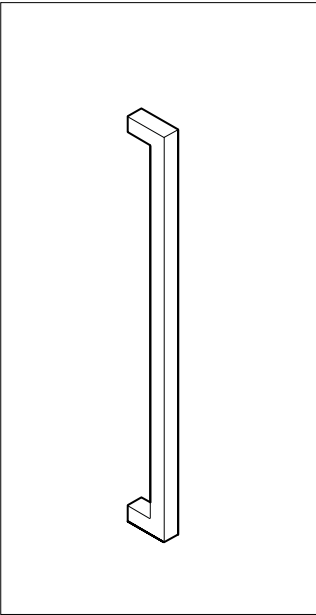

MPOMGH1Q_GH2Q_GH3Q

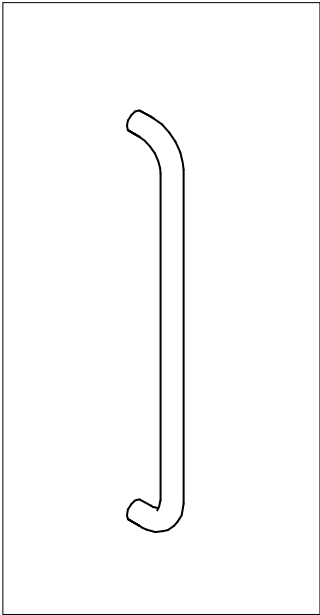

MPOM8

ALLUMINIO

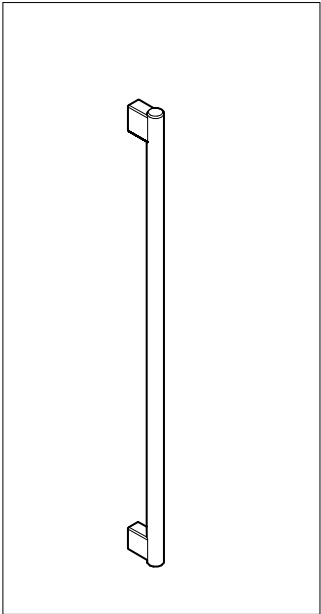

MPOMTH1_TH2

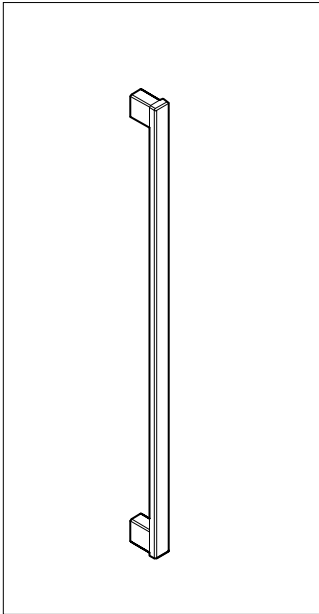

MPOMQH1_QH2

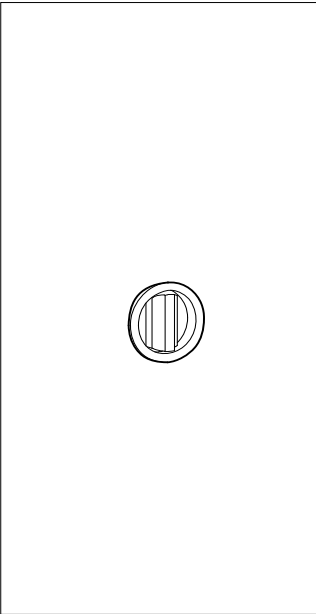

MPOM4

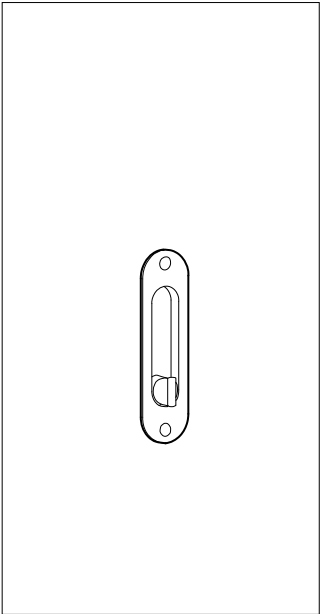

MPOM5

METRICA®
STRUTTURALE

Accessori



Chiudiporta aerei

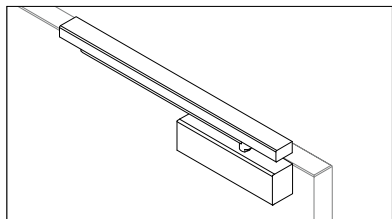

01 esterno a slitta
per anta cieca/intelaiata

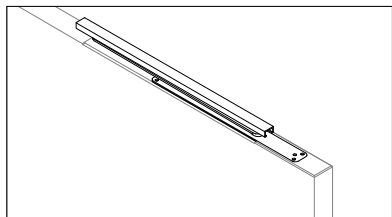

02 a scomparsa
per anta cieca/intelaiata

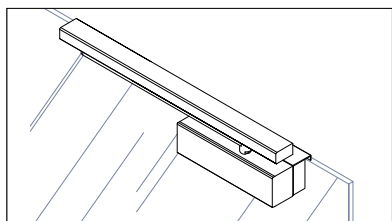

03 esterno a slitta con supporto
per anta in vetro temperato

Chiudiporta a terra

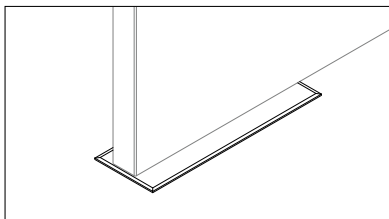

01 a pavimento
per anta cieca

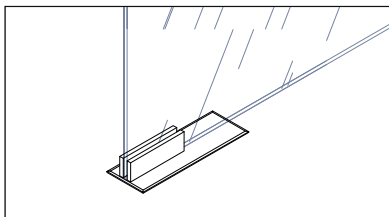

02 a pavimento
per anta in vetro temperato

Cerniere in alluminio

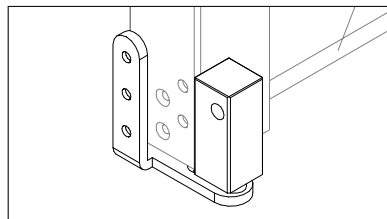

01 a bilico esterno
per anta cieca/intelaiata

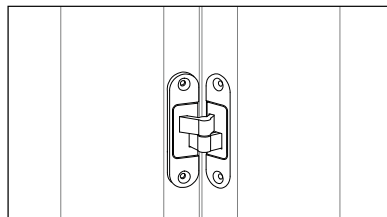

02 a scomparsa
per anta cieca/intelaiata

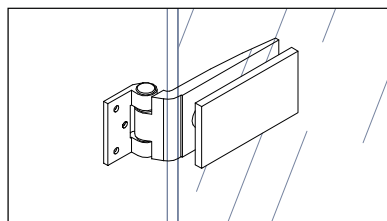

03 apertura 180°
per anta in vetro temperato

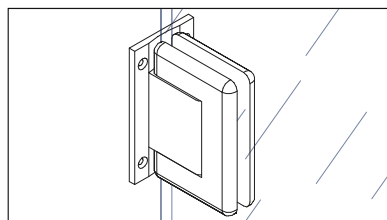

04 va e vieni velocità regolabile
per anta in vetro temperato

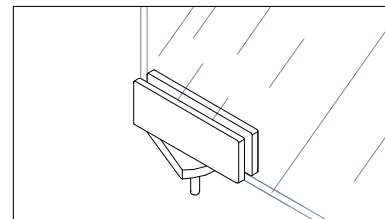

05 va e vieni velocità regolabile
per anta in vetro temperato

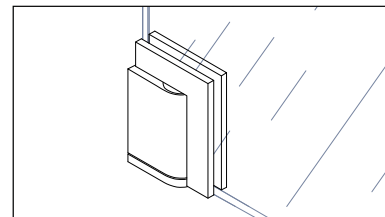

06 va e vieni velocità regolabile
per anta in vetro temperato

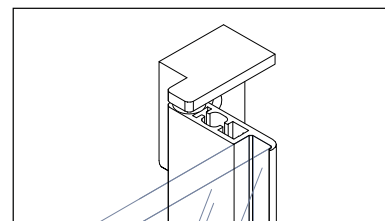

07 continua
per anta in vetro temperato

Accessori

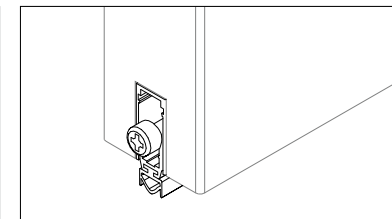

01 antispiffero insonorizzante
per anta cieca/intelaiata

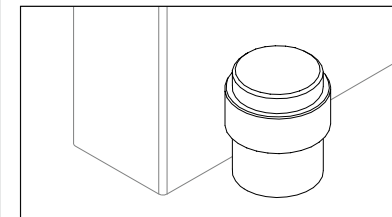

02 fermaporte
per anta cieca/intelaiata/temperato

METRICA®
STRUTTURALE

Finiture



Anodizzati



01 Alluminio naturale



02 Bronzo

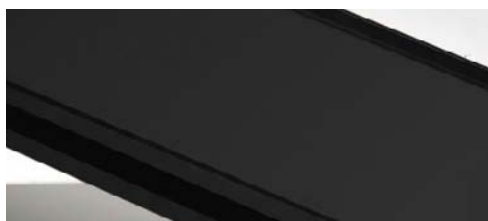

03 Nero



04 Colore a campione

Finiture RAL



01 Bianco

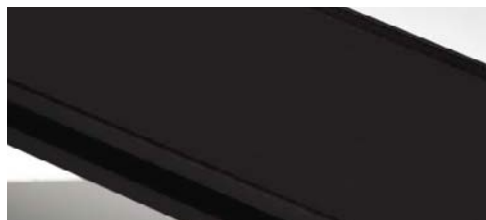

02 Nero



03 Colore a campione

Lucidatura



01 Brillantato

Legni



01 Rovere chiaro

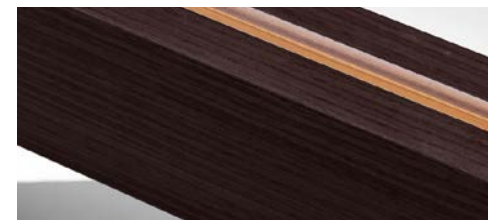

02 Rovere scuro

Pannelli ciechi



CAT. 1

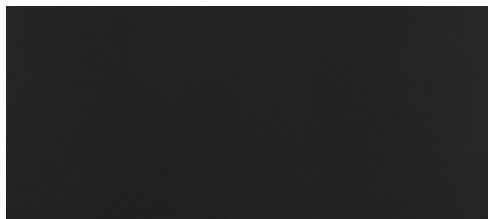

055 Nero grafite

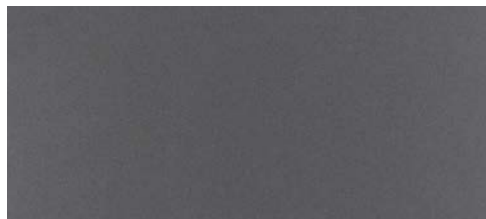

420 Piombo

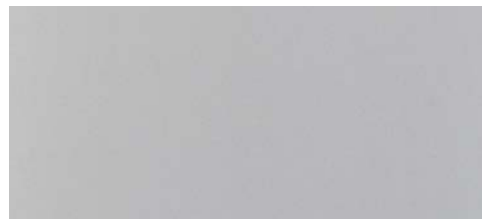

418 Grigio cenere

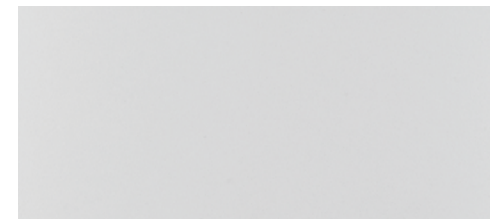

419 Grigio chiaro

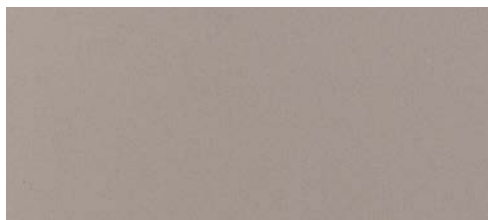

393 Tortora



417 Vaniglia

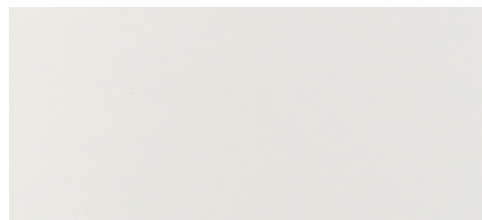

429 Bianco caldo

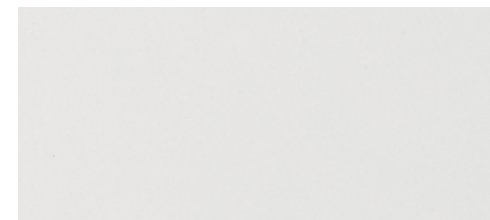

428 Bianco freddo

CAT. 2



422 Argento

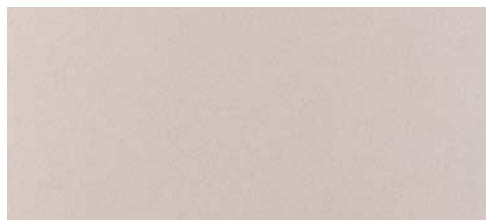

423 Champagne

Legni



CAT. 1

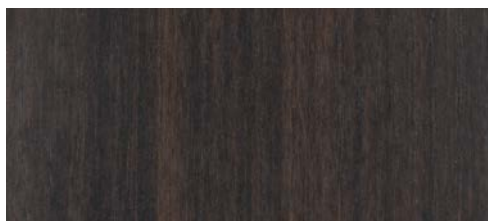

421 Eucalipto

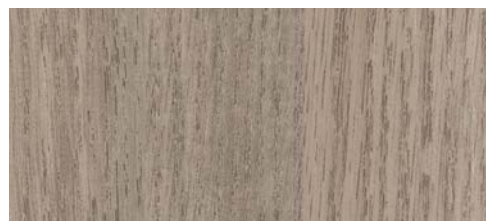

426 Rovere medio



274 Acacia



416 Bianco venato

CAT. 2



425 Noce scuro



318 Noce medio

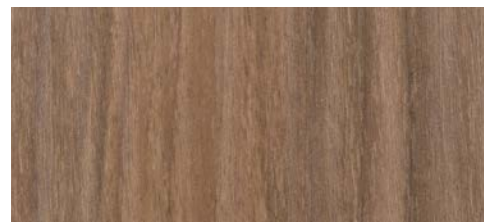

427 Noce chiaro

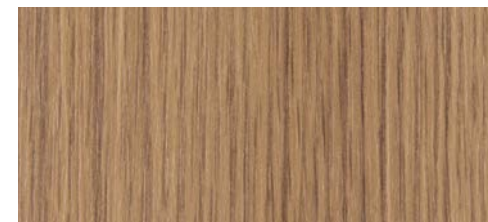

382 Rovere naturale

CAT. 3



138 Rovere invecchiato - taglio seta

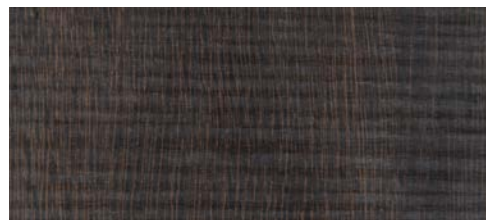

197 Eucalipto - taglio seta

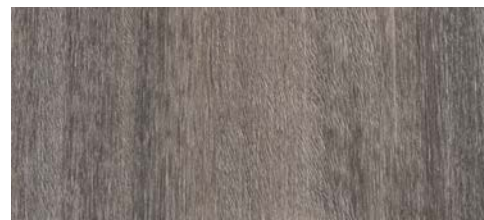

408 Rovere grigio

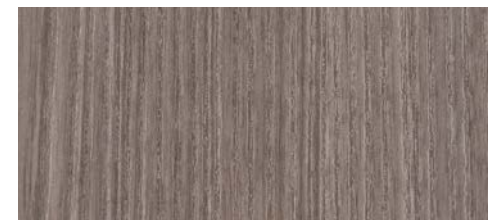

400 Rovere Danubio



414 Noce rosso



412 Rovere vintage



413 Rovere champagne



410 Rovere chiaro

Materici



CAT. 2



304 Tessuto scuro



123 Tessuto medio



305 Tessuto chiaro



424 Ossido

CAT. 3

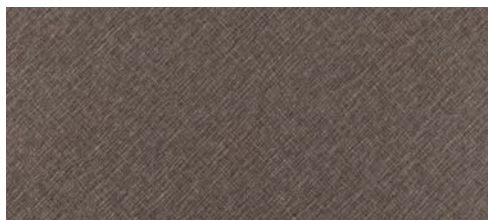

385 Lino bronzo

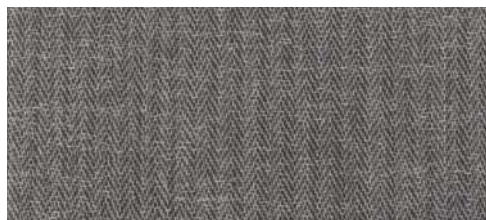

409 Corteccia

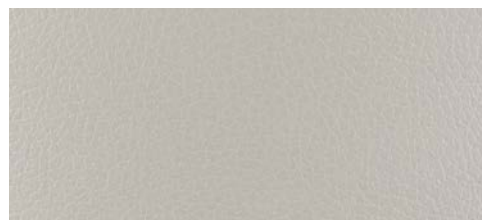

406 Primo fiore grigio

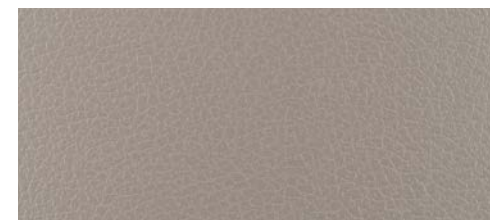

405 Primo fiore tortora

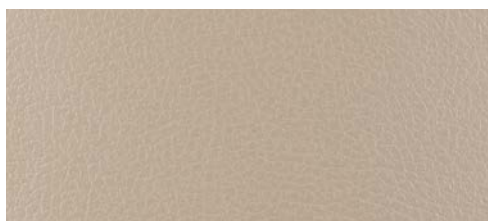

404 Primo fiore beige



415 Deserto

Vetri



01 Trasparente



03 Satinato

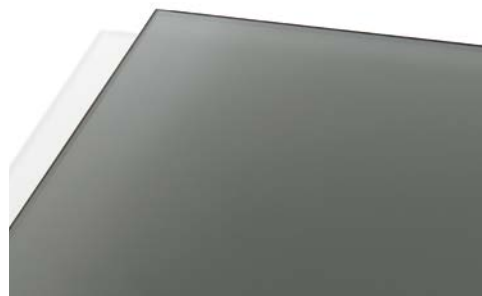

05 Fumé



02 Extrachiario



04 Bronzo



06 Verniciato a campione



Etoile s.r.l. - Società Unipersonale

Via Delle Industrie, 9/B 61040 Sant'Ippolito (PU) Italy

P. +39.0721.85.59.34

info@etoilesrl.it - www.etoilesrl.it